

# U.S. PUBLIC LAND SURVEY MONUMENT RECORD

For Public Land Survey Corners in the

T. 3 N., R. 10 E.

## CORNER CODE INDEX

	1	2	3	4	5	6	7	8	9	10	11	12	13	14	15	16	17	18	19	20	21	22	23	24	25
A																									
B																									
C	6																								
D		5																							
E			4																						
F				3																					
G					2																				
H						1																			
I																									
J	7																								
K		8																							
L			9																						
M				10																					
N					11																				
O						12																			
P							13																		
Q								14																	
R									15																
S										16															
T											17														
U												18													
V													19												
W														20											
X															21										
Y																22									
Z																	23								
																		24							
																			25						
																				26					
																					27				
																						28			
																							29		
																								30	
																									31
																									32
																									33
																									34
																									35
																									36

PLACE MONUMENT SYMBOL (◆) AT PROPER LOCATION ON ABOVE INDEX

### EXAMPLE

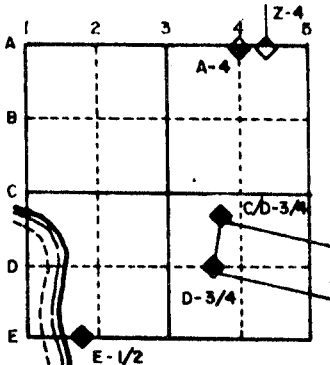

MAGNOLIA TWP  
ROCK COUNTY WI

IF AVAILABLE  
STATE PLANE COORDINATES

USING DOT'S INFORMATION ON NORTH LINE SEC 32  
North (Y) 248,367.17 Elev. (Z) \_\_\_\_\_

East (X) 2,180,885.57 Zone \_\_\_\_\_

Hor. Datum \_\_\_\_\_ Vert. Datum \_\_\_\_\_

TRAVERSING FROM WI GEOD 579 12/1/1988  
248,365.54  
~~2,180~~ 3,180,883.61

(a.)

◆ CORNER MONUMENT  
Fd PK

○ WITNESS MONUMENT 3/5 X 24" RE-ROD

BEARINGS ARE BASED ON:

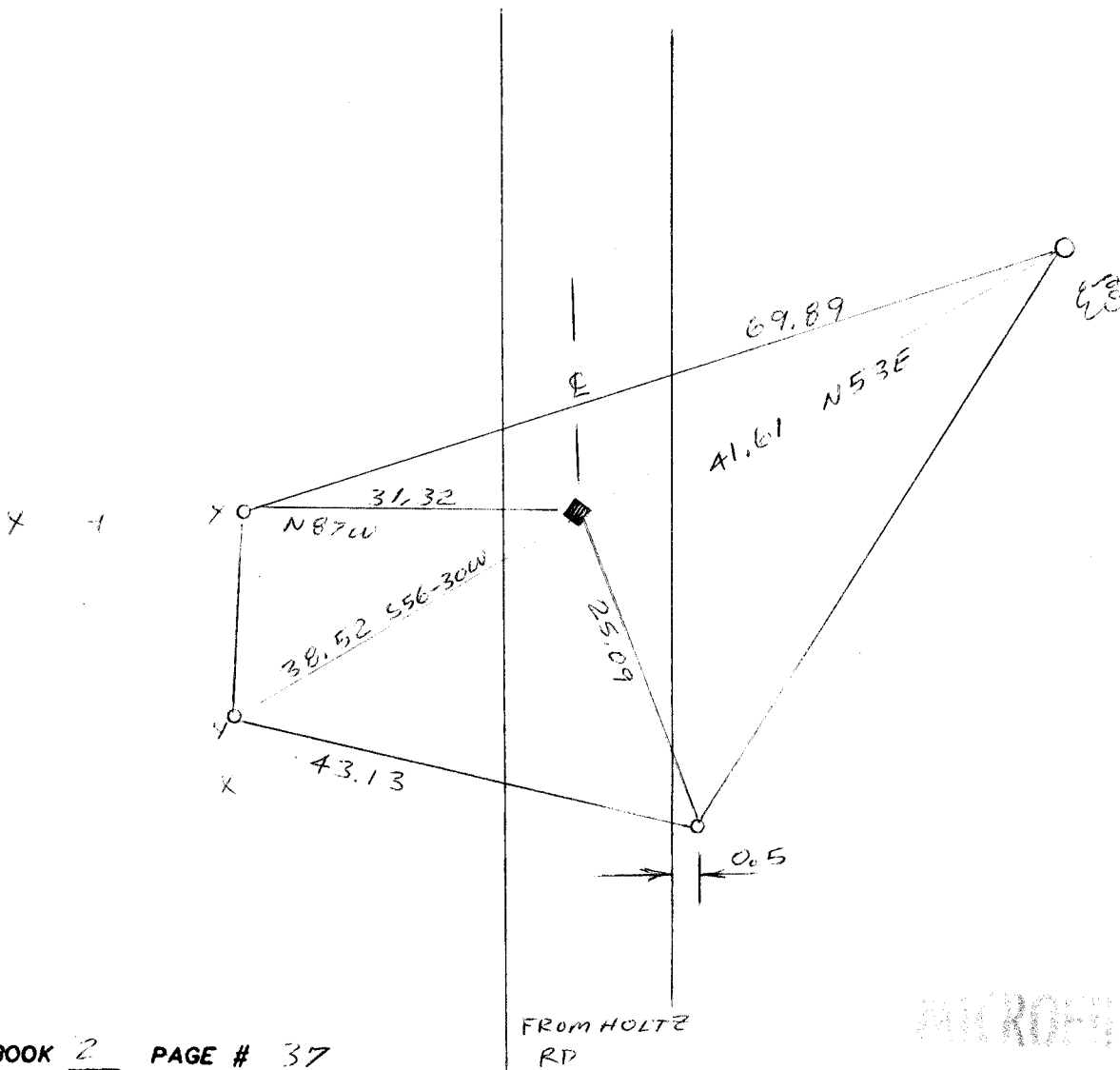

FIELD BOOK 2 PAGE # 37

FROM HOLTZ  
RD

MICROFILMED

SHOW A PLAN VIEW DRAWING DEPICTING THE CORNER MONUMENT AND SURROUNDING PHYSICAL FEATURES, INCLUDING THE EXCAVATION AREA AND DEPTH. THE CORNER MONUMENT SHALL HAVE THE FOLLOWING CHARACTERISTICS: 1) HAVE AT LEAST TWO PREDETERMINED BREAK-OFF POINTS. 2) IF BROKEN, LEAVE A PERMANENTLY MAGNETIZED REMNANT AT THE ORIGINAL POINT. 3) MUST BE EXTENDABLE. 4) THE CAP IS INSCRIBED: ROCK COUNTY SURVEY MONUMENT - PENALTY FOR DISTURBING MARKER. 5) OR AN EXISTING CUT LIMESTONE. AN IRON PIPE 1 1/2" X 4'0" (MINIMUM) MAY BE USED IN AREAS WHERE GROUND WATER IS WITHIN ONE FOOT OF THE SURFACE. IF THE CORNER IS OCCUPIED BY AN IMPROVEMENT (MANHOLE, BURIED CABLE, ETC.) ANY DURABLE, DISTINCT MONUMENT MAY BE USED. CORNERS SHALL BE REFERENCED WITH AT LEAST 4 DURABLE WITNESS MONUMENTS. WITNESS MONUMENTS SHALL BE MADE OF CONCRETE, NATURAL STONE, IRON OR OTHER EQUALLY DURABLE MATERIAL, EXCEPT WOOD. DESCRIBE THE CORNER AND THE WITNESS MONUMENTS.

CORNER CODE:

X 9

- (b.) Describe any record evidence, monument evidence, occupational evidence, testimonial evidence or any other material evidence you considered, and whether the monument was found or placed.
1. HARRISON - 1833 PLACED A WOOD POST.
  2. RUGER - 1874 FOUND STAKE, BT, AND THE STUMP OF THE NW. BT. THE LATTER WAS 265 INSTEAD OF 215.
  3. RUGER - 1882 FOUND OLD STAKE & BOTH BTs. SET IN PLACE OF STAKE A L.S. 22X7X4" LIMESTONE @ 4 HH
  4. RUGER - DATE UNKOWN FOUND OLD STAKE & BOTH BTs. THE NE BT BEING N32E218, THE NW BT BEARS N86W130. SET IN PLACE OF OLD STAKE LIMESTONE 22X7X4 @ 4 HH
  5. LEE - 1973 MEASURED TO IT BUT DID NOT STATE WHAT HE FOUND OR PLACED.

DISTANCES AND ANGLE TO NE & SE CORNERS OF SECTION 32 ARE IN HARMONY WITH H LEE'S MEASUREMENTS IN VOL 5

Page 3. DID NOT ACCEPT NOR REJECT THE CORNER, FURTHER DOCUMENTATION OR FIELD EVIDENCE IS NEEDED, RECORDED PK.

(c.) Was the corner restored through acceptance of (1) an obliterated evidence location, or, (2) a found perpetuated location?

(d.) Describe any material discrepancy between the location of the corner as restored or reestablished and the location of that corner as previously restored or reestablished by distance and direction. Show the discrepancy on the plan view drawing under (a), above. Show the distances between the corner as previously restored or reestablished and (1) the corner as restored or reestablished, and (2) to at least 4 of the witness monuments shown on the drawing in (a), above.

(e.) Was the corner reestablished through lost corner proportionate methods? If so, show the method, including the directions and distances to other public land survey corners used as evidence or used for proportioning in determining the corner location.

I, Donald Bunnay, hereby certify that the corner points as identified by the corner code index were, in a field survey on Aug 7 1985, established, re-established, monumented, re-monumented, recovered or restored as expressed below and in conformance with the regulations and rules as required in the current manual of survey instructions of the United States Department of Interior, Bureau of Land Management.

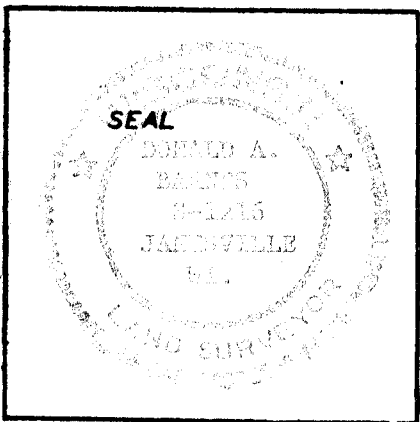
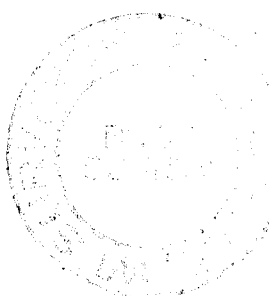

COUNTY SURVEYOR FILING DATA  
 Date of Computer Entry \_\_\_\_\_  
 Date Received \_\_\_\_\_  
 Date Microfilmed AUGUST 1985  
 Treasurer's Receipt No. \_\_\_\_\_  
 Number of Included Sheets \_\_\_\_\_

AFFIX YOUR LAND SURVEYOR SEAL. CORNER CODE 4-9