

PLAT AND RECORD

Of a Survey on Section 17 T 3 R 11 E. of the 4 P. M. in Centre Township

Rock County, Wisconsin, made June the 12th 1863

I hereby certify that the following is a correct record of said survey as made by me.

COUNTY BUILDING
IN CITY OF БЕЛОIT

(Signed) S. D. Locke
S. D. Locke

County Surveyor.

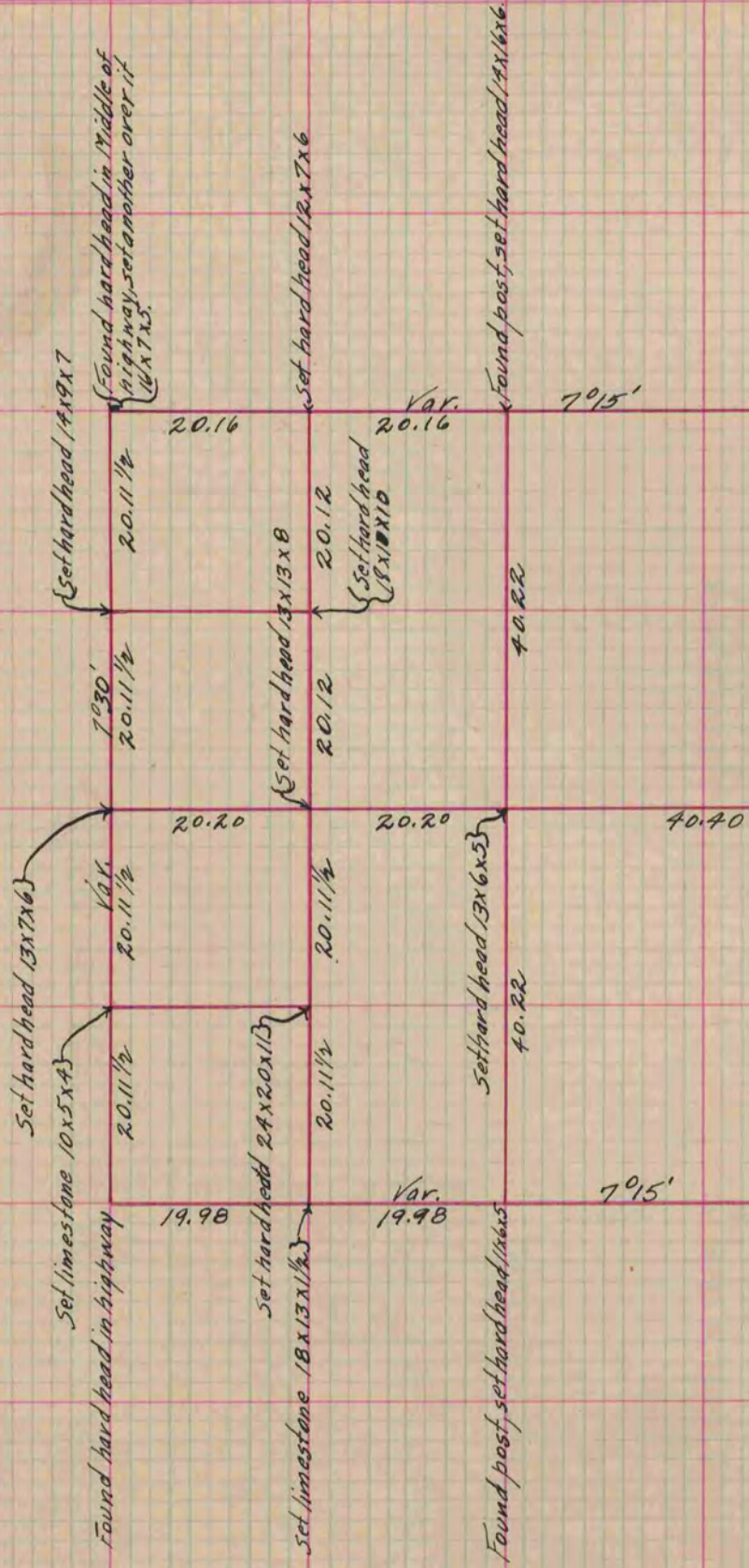

Copied from upper part of Page 191 Original Vol. One County Surveyor's Record.