

PLAT AND RECORD

Of a Survey on Section 32 T 3 R 13 E. of the 4 P. M. in Harmony Township
Rock County, Wisconsin, made the 1860 ±

I hereby certify that the following is a correct record of said survey as made by me.

COUNTY BUILDING
IN CITY OF БЕЛОIT

(Signed) Edward Ruger
ERM

County Surveyor.

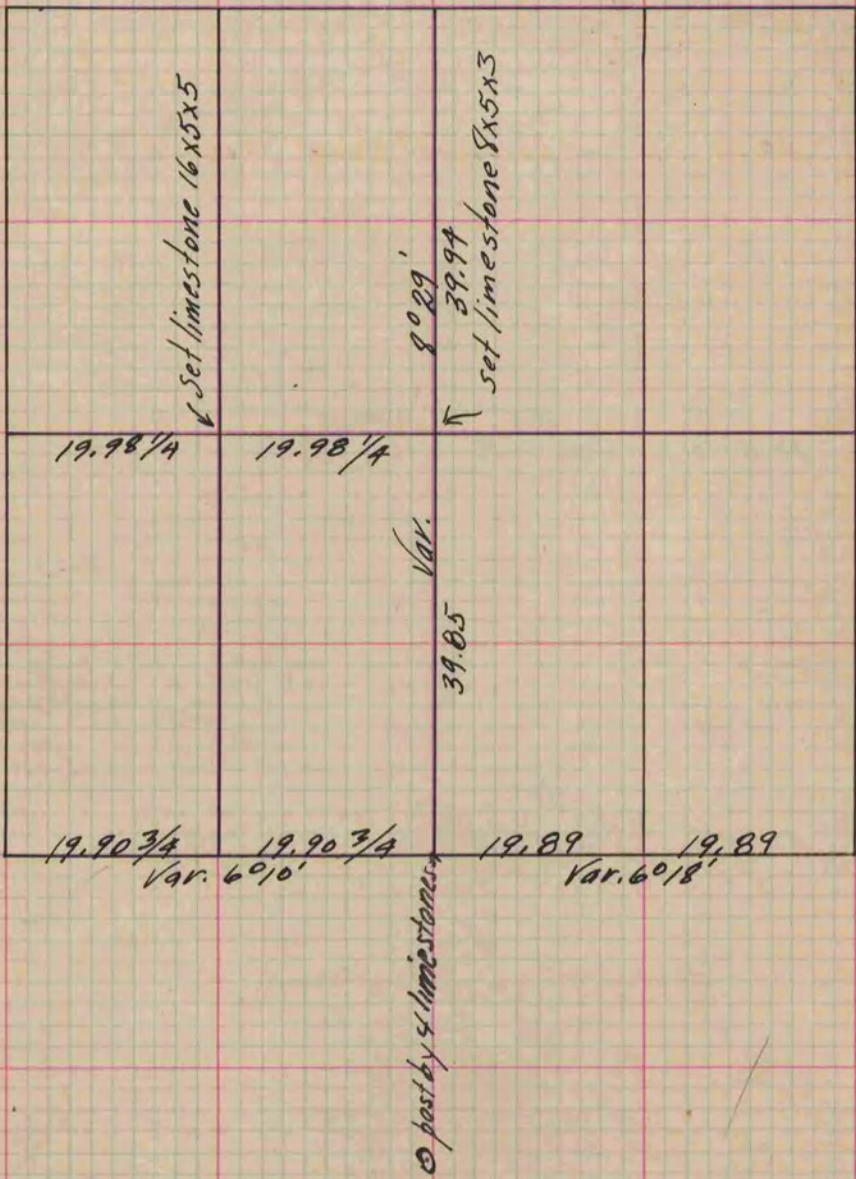

Copied from Page 136 Vol. 1. Original County Surveyors Record.