

PLAT AND RECORD

Of a Survey on Section 13 T 2 R 14 E. of the 4 P. M. in Bradford Township
Rock County, Wisconsin, made November the 2nd 1860

I hereby certify that the following is a correct record of said survey as made by me.

COUNTY BUILDING
IN CITY OF BELOIT

(Signed) Edward Ruger

County Surveyor.

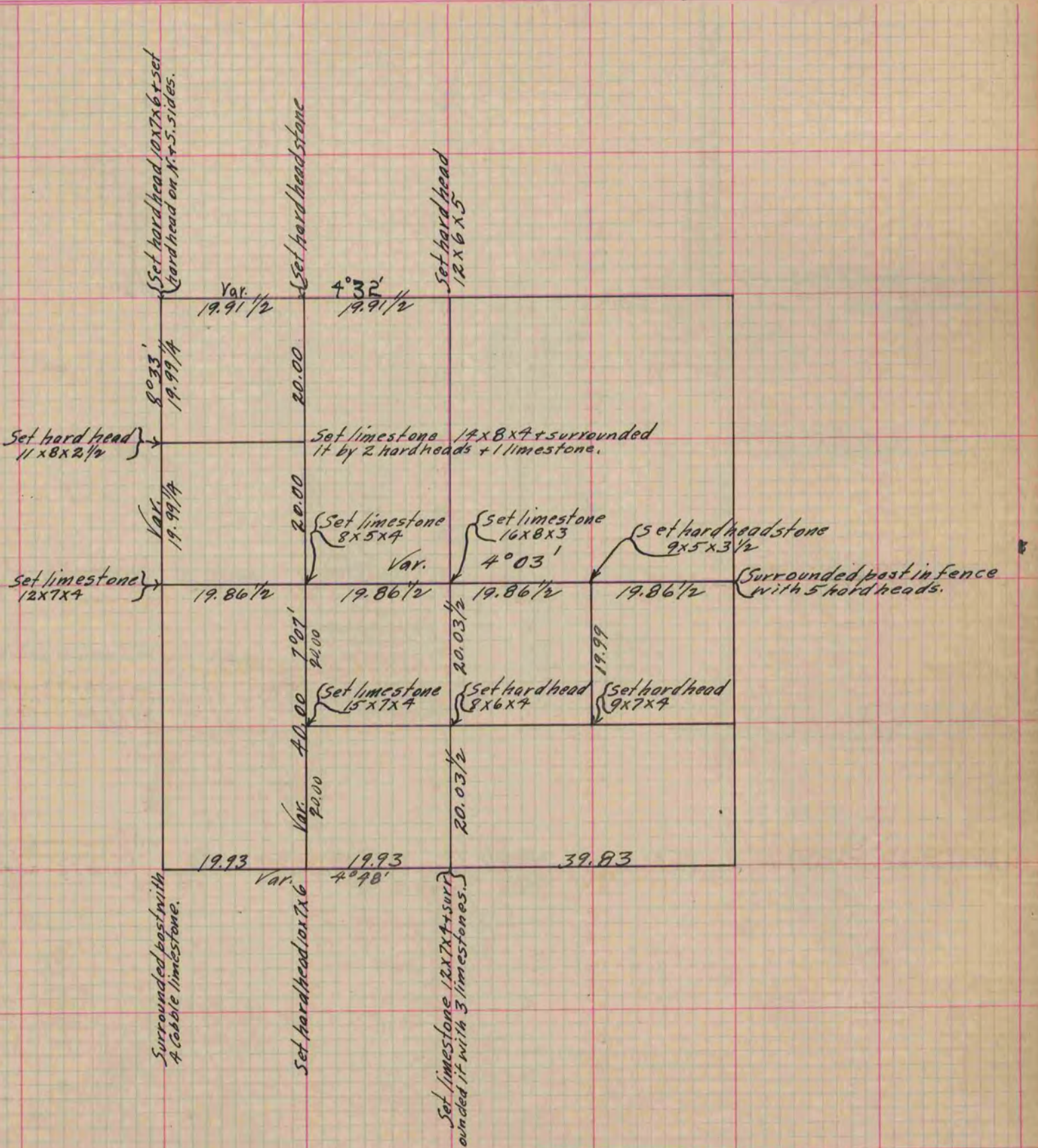

Copied from Page 156 Original County Surveyor's Record.