

# U.S. PUBLIC LAND SURVEY MONUMENT RECORD

For Public Land Survey Corners In:

WI ADMINISTRATIVE CODE A-E 7.08 REQUIREMENT

T. 2 N. R. 11 E.

CORNER CODE INDEX

PLYMOUTH TWP

ROCK COUNTY WI

IF AVAILABLE

ROCK COUNTY COORDINATES PREFERRED

1	2	3	4	5	6	7	8	9	10	11	12	13	14	15	16	17	18	19	20	21	22	23	24	25	
A																									A
B																									B
C																									C
D																									D
E																									E
F																									F
G																									G
H																									H
J																									J
K																									K
L																									L
M																									M
N																									N
O																									O
P																									P
Q																									Q
R																									R
S																									S
T																									T
U																									U
V																									V
W																									W
X																									X
Y																									Y
Z																									Z

North \_\_\_\_\_ Elev. \_\_\_\_\_

East \_\_\_\_\_

Hor. Datum \_\_\_\_\_ Vert. Datum \_\_\_\_\_

LATITUDE \_\_\_\_\_ ELLIPS. HT. \_\_\_\_\_

LONGITUDE \_\_\_\_\_

GPS (X) \_\_\_\_\_ TRAVERSE (X) \_\_\_\_\_

BASED ON THE FOLLOWING CONTROL:

PLACE MONUMENT SYMBOL  AT PROPER LOCATION ON ABOVE INDEX

CORNER MONUMENT

WITNESS MONUMENT

(a)

BEARINGS ARE BASED ON: -----

OBSERVATION sheet 130

FIELD BOOK \_\_\_\_\_ PAGE # \_\_\_\_\_

SHEET 1 OF 2

SHOW A PLAN VIEW DRAWING DEPICTING THE CORNER MONUMENT AND SURROUNDING PHYSICAL FEATURES, INCLUDING THE EXCAVATION AREA AND DEPTH.

PLANNING & ZONING COMMITTEE ADOPTED THE ABOVE FORM ON 12/2/1982

CORNER CODE P-13(1)

PL577

(B) Describe any record evidence, monument evidence, occupational evidence, testimonial evidence or any other material evidence you considered, and whether the monument was found or placed.

1833 HARRISON NORTH BET 21 & 22  
1518 LEFT PRAIRIE & ENTER ? TIMBER  
2640 QUARTER SEC COR. BURR O. 10 N87W 149.16'  
BURR O W.O } MARKED  
2838 LEFT TIMBER & ENTER WET PRAIRIE  
3630 LEFT WET PRAIRIE & ENTER ??  
4382.4 BURR O 16  
5280 COR TO SECS 15 16 21 22 {BURR O 24 S49W  
48.18' BURR O 20 N47W 67.98' BURR O 18 N43E  
99' BUR O 19 S34E 162.36' LAND & SAME AS  
LAST MILE  
1847 TWP RD REC BK 1 PG 21 BEGINNING AT THE NW COR OF SEC  
3 AND 4, 9 AND 10, 15 AND 16, 21 AND 22 TO THE SW COR  
OF SEC 22. SAID RD IS 66' IN WIDTH  
1854 TWP RD REC BK 1 PG 36 "" A HWY BE LAID OUT IN SAID  
TOWN OF THE WIDTH OF 66'. THE CENTER LINE OF THE SAID  
HWY IS TO COMMENCE ON THE 1/4 LINE 1320' EAST OF THE 1/4  
POST ON THE WEST SIDE OF SEC 19 AND TO RUN THENCE  
EAST ON SAID 1/4 LINE THROUGH SAID SEC 19 AND TO RUN  
THENCE EAST ON THE 1/4 LINE THROUGH SEC 20 AND TO RUN  
THENCE EAST ON THE 1/4 LINE INTO SEC 21 UNTIL IT  
INTERSECT A RD RUNNING TO BASS CREEK BRIDGE.  
1868 LOCKE PG21 NORTH BETWEEN SEC 21 & 22 VAR B  
2662.44 INTERSECTED 1/4 LINE 22.11' WEST OF COR. FOUND  
STAKE AND WHERE BTS WERE DUG OUT COR IN  
FENCE (N & S) VAR CORRECTED 7-31  
SET OFF 22.11' WEST AND CONTINUED NORTH WITH  
VAR 7-35  
5309.7 INTERSECTED NORTH BOUNDARY 18.48' WEST OF  
COR. FOUND BT IN SEC 21 AND STUMP OF BTS IN  
15,16, & 22 AND OLD STAKE. VAR CORRECTED 7-40  
AUG 22 1868  
1978 BARNES VOL 5 PG 496 FD CUT L.S. 0.2' ABOVE GRADE. SET  
R/W POST ON NE SIDE OF STONE. L.S ON WEST SIDE OF N/S  
FENCE.  
1980 TALARGYZK GSM VOL 10 PG 3 CUT STONE.  
1987 BARNES N-13 2647.72 TO NW COR SEC 22  
1987 BARNES P-13 FD CUT LIMESTONE WITH R/W POST. REFERENCED  
SAME. IN N/S FENCE LINE.

FD CUT L.S. WITH R/W POST IN N/S FENCE ROW. 1987 TIES STILL  
EXIST

C) Was the corner restored through acceptance of (1) an obliterated evidence location, or, (2) a found perpetuated location?

ACCEPTED CUT LIMESTONE AS PERPETUATED LOCATION

D) Describe any material discrepancy between the location of the corner as restored or reestablished and the location of that corner as previously restored or reestablished by distance and direction. Show the discrepancy on the plan view drawing under (a), above. Show the distances between the corner as previously restored or reestablished and (1) the corner as restored or reestablished, and (2) to at least 4 of the witness monuments shown on the drawing in (a), above.

I, Donald Barnes, hereby certify that the corner location as identified by the corner code index was determined by me under my direction and control and that this U.S. Public Land Survey Monument Record is correct and complete to the best of my knowledge and belief.

Seal

  
Donald Barnes  
Emboss

SHEET 1 OF 2

12-27-02

CORNER CODE  
A.E. 7.08 REQUIREMENT

P-13(1)

N

ROCK COUNTY PROJECTION

ROCK COUNTY SURVEY

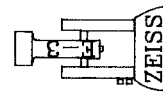
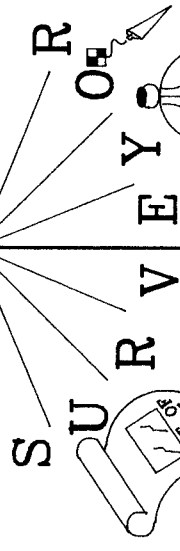

NOT TO SCALE

RECORD BEARINGS ARE BASED ON WEST LINE OF NW 1/4 OF SEC 22 WHICH IS S0-53-53E

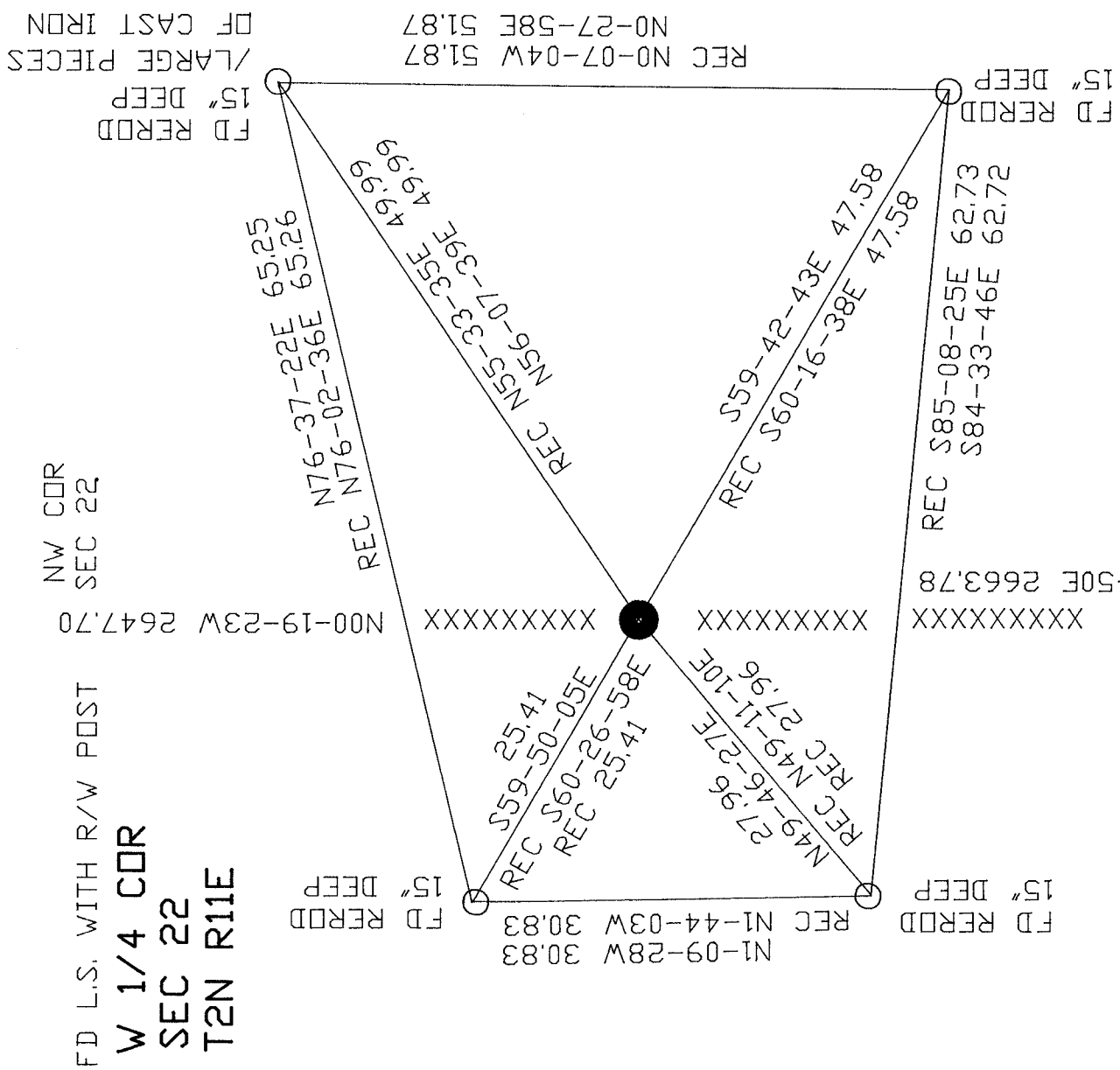

NW COR SEC 22

FD L.S. WITH R/W POST

W 1/4 CDR SEC 22 T2N R11E

SW COR SEC 22

SHEET 2 OF 2

EMBOSSED SEAL

Donald Barnes 12-27-02

P-13(1)