

U.S. PUBLIC LAND SURVEY MONUMENT RECORD

For Public Land Survey Corners in the

T. 2 N., R. 11 E.

CORNER CODE INDEX

	1	2	3	4	5	6	7	8	9	10	11	12	13	14	15	16	17	18	19	20	21	22	23	24	25
A																									
B																									
C	6																								
D																									
E																									
F																									
G	7																								
H																									
I																									
J																									
K																									
L	16																								
M																									
N																									
O																									
P	19																								
Q																									
R																									
S																									
T	30																								
U																									
V																									
W																									
X	31																								
Y																									
Z																									

PLACE MONUMENT SYMBOL (◆) AT PROPER LOCATION ON ABOVE INDEX

EXAMPLE

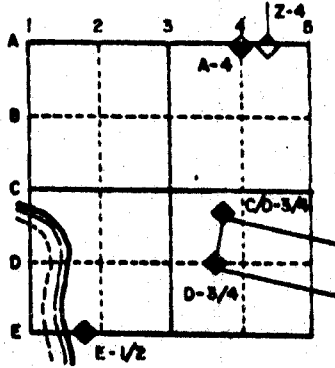

PLYMOUTH TWP
ROCK COUNTY WI

IF AVAILABLE
STATE PLANE COORDINATES

North (Y) _____ Elev. (Z) _____
 East (X) _____ Zone _____
 Hor. Datum _____ Vert. Datum _____

(a.) ◆ CORNER MONUMENT ○ WITNESS MONUMENT

BEARINGS ARE BASED ON:

MICROFILMED
SHEET _____ OF _____
CORNER CODE: V9(1)
473

FIELD SURVEY NOTES
PRESERVATION OF LANDMARKS
 (Pursuant to Section 59.635(7) Wisconsin Statutes)

State Highway Commission of Wisconsin
 Form E-D-707-88

COUNTY <i>Rock</i>		
TOWN <i>PLYMOUTH</i>		
HIGHWAY <i>STH 213</i>		
SECTION <i>33</i>	TOWNSHIP <i>2 N</i>	RANGE <i>11 E</i>
TYPE OF LANDMARK <i>Aluminum Monument</i>		

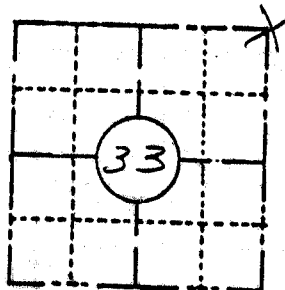

LOCATION SKETCH
 (Location of landmark indicated by "x")

This space for copy of field notes or ties to the above described landmarks

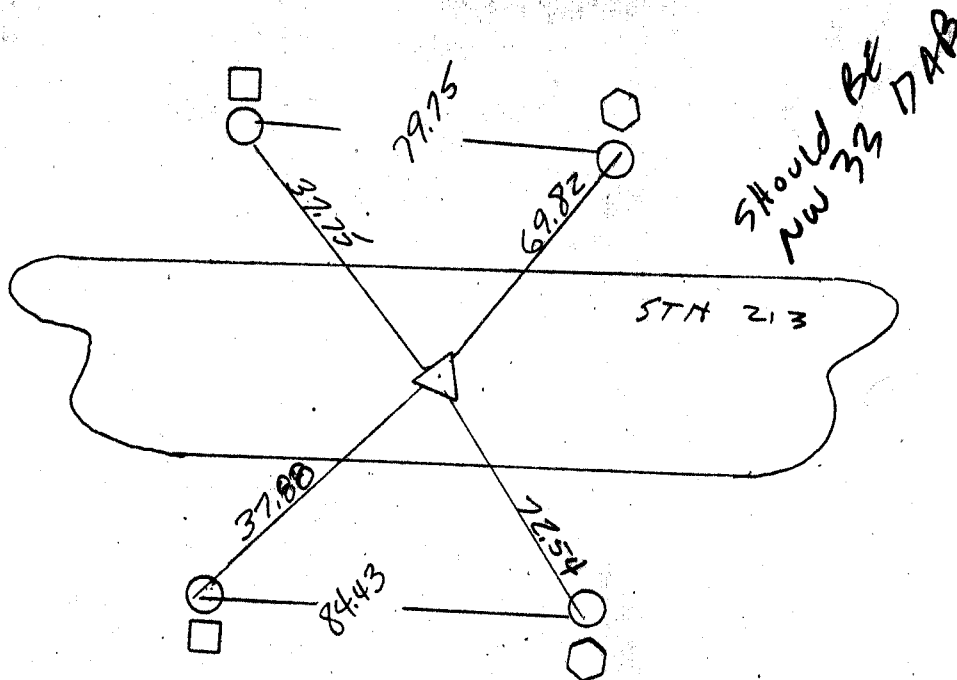

*From Sta 542+34 - 1' RL.
 Ref. FWS 6-6-84*

- = REFERENCE MONUMENT #5 bar
- = RIGHT OF WAY POST
- ⬡ = WITNESS POST
- △ = SECTION CORNER LOCATION

COUNTY CLERK'S OFFICE	
COUNTY OF _____ WISCONSIN	
DATE RECEIVED FOR RECORD	DATE COPY SENT TO COUNTY SURVEYOR
SIGNATURE OF COUNTY CLERK	

*v901
 #13*