

U.S. PUBLIC LAND SURVEY MONUMENT RECORD

For Public Land Survey Corners In:
T. 2N. R. 11E.

WI ADMINISTRATIVE CODE A-E 7.08 REQUIREMENT

CORNER CODE INDEX

PLYMOUTH TWP
ROCK COUNTY WI

IF AVAILABLE
ROCK COUNTY COORDINATES PREFERRED

	1	2	3	4	5	6	7	8	9	10	11	12	13	14	15	16	17	18	19	20	21	22	23	24	25
A																									
B																									
C																									
D																									
E																									
F																									
G																									
H																									
J																									
K																									
L																									
M																									
N																									
O																									
P																									
Q																									
R																									
S																									
T																									
U																									
V																									
W																									
X																									
Y																									
Z																									

North _____ Elev. _____

East _____

Hor. Datum _____ Vert. Datum _____

LATITUDE _____ ELLIPS. HT. _____

LONGITUDE _____

GPS (X) _____ TRAVERSE (X) _____

BASED ON THE FOLLOWING CONTROL:

PLACE MONUMENT SYMBOL AT PROPER LOCATION ON ABOVE INDEX

CORNER MONUMENT

WITNESS MONUMENT

(a)

BEARINGS ARE BASED ON: _____

FIELD BOOK _____ PAGE # _____

SHEET 1 OF 3

SHOW A PLAN VIEW DRAWING DEPICTING THE CORNER MONUMENT AND SURROUNDING PHYSICAL FEATURES, INCLUDING THE EXCAVATION AREA AND DEPTH.

PLANNING & ZONING COMMITTEE ADOPTED THE ABOVE FORM ON 12/2/1982

CORNER CODE A-25(3)

PL513

(B) Describe any record evidence, monument evidence, occupational evidence, testimonial evidence or any other material evidence you considered, and whether the monument was found or placed.

1833 MULLETT VAR 7-55 WEST ON SOUTH SIDE OF SECTION 36 T3N
R11E

2640 SET QUARTER SECTION POST IN PRAIRIE AND
MADE MOUND
5280 SET POST CORNER SECTIONS 35 & 36 BUR OAK 10
N70E 411.84' BUR OAK 8 N64 1/2 W 557.7' LAND
ROLLING SECOND RATE PRAIRIE.

NORTH ON EAST SIDE OF SEC 1

429 LEAVE MARSH AND ENTER PRAIRIE
2640 SET QUARTER SECTION POST IN PRAIRIE AND
RAISED A MOUND
5280 SET POST CORNER TOWNSHIPS 2 & 3 N RANGES
11 & 12E IN PRAIRIE AND RAISED A MOUND LAND
ROLLING PRAIRIE AND RAISED A MOUND. LAND
ROLLING PRAIRIE FIRST RATE SEPT 11TH 1833

NORTH ON EAST SIDE OF SECTION 36 VAR 8-40

2640 SET QUARTER SECTION POST IN PRAIRIE AND
MADE A MOUND
5280 SET POST CORNER SECTIONS 25 & 36 IN PRAIRIE
AND MADE A MOUND LAND ROLLING PRAIRIE FIRST
RATE. SEPT 14 1833
EAST ON SOUTH SIDE SECTION 31 VAR 7-50E

2475 LEAVE PRAIRIE

2600.4 SET QUARTER SECTION POST BUR OAK 8 N89E
110.22' BUR OAK 10 N12 1/2 W 182.82'

4290 ENTER MARSH N & S

4620 STREAM 2.64'? C S.E.

5240.4 SET POST CORNER SECTIONS 31 & 32 BUR OAK 8
N 7 1/2 W 397.32' BUR OAK 6 N6E 491.7' LAND
ROLLING SECOND RATE PART PRAIRIE PART
TIMBERED BLACK WHITE AND BUR OAK.

1854 McVEAN VOL 1 PG 23 STATES NOTHING ABOUT MON.
2655.84 TO E 1/4 COR SEC 1.

1868 LOCKE PG 33 NORTH ON EAST LINE SEC 1 VAR 6-40

0 SET OFF 10.56' EAST

2657.82 INTERSECTED 1/4 LINE 23.1' EAST OF COR. FOUND
STONE SET AT END OF SOD FENCE. VAR
CORRECTED 6-56

CONTINUED NORTH FROM 1/4 COR WITH VAR 6-40

5315.64 INTERSECTED NORTH BOUNDARY 20.79' EAST OF
COR. FOUND STONE & UNDERNEATH REMAINS OF
STAKE. COR. IN CENTER OF HIGHWAY AND NEARLY
IN LINE WITH N & S FENCES. VAR CORRECTED 7-
07

PG 34 WEST ON NORTH LINE SECTION 1.

2668.38 INTERSECTED 1/4 LINE FOR TOWN 3 (CENTER) 1.98'
SOUTH OF COR. FOUND LARGE LIMESTONE IN
CENTER OF HIGHWAY AND IN LINE OF N AND S
FENCES.

5334.12 INTERSECTED WEST BOUNDARY 14.52' SOUTH OF
COR. FOUND BT IN SEC 2

5330.82 INTERSECTED COR FOR TOWN 3 FOUND BT IN SEC
35 AND STUMP OF BT IN SEC 36. COR IN CENTER
OF HIGHWAY.

2667.06 SET 1/4 COR 1.32' EAST OF 1/4 COR FOR TOWN 3
FOR FIRST HALF MILE VAR CORRECTED 6-58, FOR
LAST HALF MILE VAR CORRECTED 7-11 1/4
MONUMENT MARKED WITH FIGURE 1 ON SOUTH
FACE AUG 27, 1868

1933 SUNNY VOL 3 PG 234 SET 1" IRON PIPE 30" LONG IN
CONCRETE PAVEMENT 0.9' NORTH OF CENTER OF PAVEMENT
& IN LINE WITH N & S FENCE. SHOWS A DISTANCE OF
2657.8 TO THE EAST QUARTER CORNER OF SEC 1 AND

Ronald Barnes
1/29/03

PL513

- 2667.2 TO THE NORTH QUARTER CORNER OF SEC 1 AND
2629.45 TO THE NORTH QUARTER CORNER OF SECTION 6.
1970 BATTERMAN JR. VOL 4 PG 432 FOUND 3/4" IRON PIN AT
CORNER 1' NORTH OF CENTER OF PAVEMENT. REFERENCED
CORNER.
- 1987 BARNES Z-1(1) FOUND PK AND 3 OF THE REFERENCE PIPES.
PLACED G-1 MONUMENT TO THE NORTHEAST.
- 1988 BARNES A-25 & Z-25(CENTER TWP. FOUND PIPE 15" DEEP IN
OLD CONCRETE PAVEMENT. DUG LARGE HOLE AND FOUND
CUT LIMESTONE 2 1/2 X 8" 40 INCHES DEEP. BROKE TOP 16
INCHES OFF. PLACED MAGNET ON TOP OF STONE.
EXCAVATION AREA INDICATES THAT SUNNY DID NOT DIG FOR
THE CORNER. ACCEPTED FOUND CUT LIMESTONE. THE PK,
PIPE, AND CUT LIMESTONE ARE NOT AT THE SAME LOCATION.
MAP SHOWS DISCREPANCY. TIES & BEARINGS TO FOUND
REFERENCE PIPES. USING DOT CONTROL THE COORDINATES
ARE N/S 246,136.80; E/W 2,233,919.92 AND THE
JANESVILLE TWP PROJECT COORDINATES FOR THE PK IS
246,136.05; 2,233,920.98 AND THE DOT CONTROL
COORDINATES FOR THE PK ARE 246,136.27; 2,233,920.18.
THE COORDINATES FOR THE 1" PIPE ARE 246,136.22;
2,233,920.13. THE PK IS S25-48-45E 0.59' & THE FD PIPE
IS S19-38-25E 0.61' FROM THE CUT L.S.
- 1988 BARNES VOL 6 PG 389 2666.95 TO N 1/4 COR SEC 1 &
2668.14 TO S 1/4 COR SEC 36.
- 1989 WIDOT PROJ #1704-03-22 MAP # 16704 CUT LIMESTONE
246,136.80; 2,233,919.92, NO-57-54E 2615.44 TO ALUM
MON AT E 1/4 COR SEC 36 CENTER TWP (248,802.68;
2,233,875.02, S0-42-30E 2607.55 TO CUT LIMESTONE AT E
1/4 COR SEC 1 (243,480.31; 2,233,952.77), NB9-38-20E
2619.72 TO 1" IRON PIN AT S 1/4 COR SEC 31 T3 R12E
- 1992 BARNES A-25(1) MONUMENT WILL BE DESTROYED BY ROAD
CONSTRUCTION. DISTANCES & BEARINGS TO OLD
REFERENCE PIPES AND NEW DOT REFERENCE MONUMENTS.
- 1992 BARNES A-25(2) & Z-25(1) (CENTER TWP) FOUND DOT DISK
@ COR & REFERENCE MONUMENTS. ACCEPTED DOT DISK &
REFERENCED SAME.

USED MY OLD OBSERVATIONS

C) Was the corner restored through acceptance of (1) an obliterated evidence location, or, (2) a found perpetuated location?

DID NOT ACCEPT WIDOT DISK. ACCEPTED FOUND CUT LIMESTONE.

D) Describe any material discrepancy between the location of the corner as restored or reestablished and the location of that corner as previously restored or reestablished by distance and direction. Show the discrepancy on the plan view drawing under (a), above. Show the distances between the corner as previously restored or reestablished and (1) the corner as restored or reestablished, and (2) to at least 4 of the witness monuments shown on the drawing in (a), above.

SEE MAP. MAP SHOWS DISCREPANCY BETWEEN FD PK, FD PIPE,
CUT LIMESTONE, AND CURRENT WIDOT DISK IN PAVEMENT.

I, Donald Barnes, hereby certify that the corner location as identified by the corner code index was determined by me under my direction and control and that this U.S. Public Land Survey Monument Record is correct and complete to the best of my knowledge and belief.

Seal

Donald Barnes

Emboss

1/29/03

SHEET 2 OF 3

CORNER CODE **A-25(3)**

A.E. 7.08 REQUIREMENT

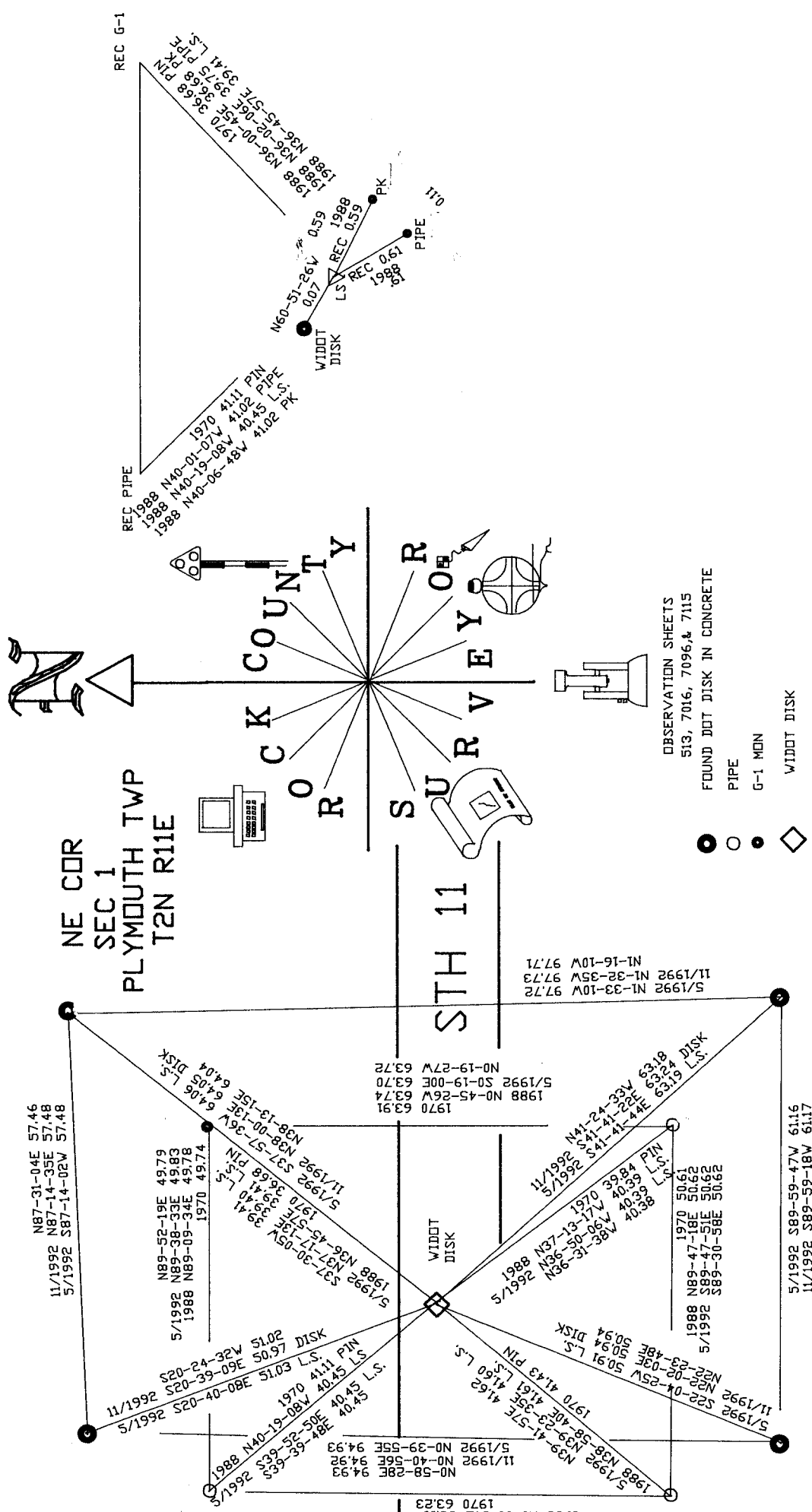

- OBSERVATION SHEETS
513, 7016, 7096 & 7115
- FOUND DOT DISK IN CONCRETE
- PIPE
- G-1 MON
- WIDDOT DISK

Donald Barney
EMBOSSSED
SEAL

1/29/03

- 513 LS
- 1633 PK
- 3513 PIPE
- 104 DISK

SHEET 3 OF 3

A-25(3)