

U.S. PUBLIC LAND SURVEY MONUMENT RECORD

For Public Land Survey Corners in:

WI ADMINISTRATIVE CODE A-E 7.08 REQUIREMENT

T. 2N., R. 11E

CORNER CODE INDEX

A	1	2	3	4	5	6	7	8	9	10	11	12	13	14	15	16	17	18	19	20	21	22	23	24	25
B																									
C	6					5					4				3										1
D																									
E																									
F																									
G	1					8					9				10										12
H																									
J																									
K																									
L	18					17					16				15										13
M																									
N																									
O																									
P																									
Q	19					20					21				22										24
R																									
S																									
T	30					29					28				27										25
U																									
V																									
W																									
X	31					32					33				34										36
Y																									
Z																									

PLYMOUTH TWP

ROCK COUNTY WI

IF AVAILABLE
ROCK COUNTY COORDINATES PREFERRED

North _____ Elev. _____

East _____

Hor. Datum _____ Vert. Datum _____

LATITUDE _____ ELLIPS. HT. _____

LONGITUDE _____

GPS (X) _____ TRAVERSE (X) _____

BASED ON THE FOLLOWING CONTROL:

PLACE MONUMENT SYMBOL AT PROPER LOCATION ON ABOVE INDEX

CORNER MONUMENT

WITNESS MONUMENT

(a)

BEARINGS ARE BASED ON:

OBSERVATION SHEETS SS, 7218

FIELD BOOK _____ PAGE # _____

SHEET 1 OF 3

SHOW A PLAN VIEW DRAWING DEPICTING THE CORNER MONUMENT AND SURROUNDING PHYSICAL FEATURES, INCLUDING THE EXCAVATION AREA AND DEPTH.

PLANNING & ZONING COMMITTEE ADOPTED THE ABOVE FORM ON 12/2/1982

CORNER CODE A-23(3)

PL512

(B) Describe any record evidence, monument evidence, occupational evidence, testimonial evidence or any other material evidence you considered, and whether the monument was found or placed.

- 1833 MULLETT VAR 7-55 WEST ON SOUTH SIDE OF SECTION 36 T3N R11E
- 2640 SET QUARTER SECTION POST IN PRAIRIE AND MADE MOUND
- 5280 SET POST CORNER SECTIONS 35 & 36 BUR OAK 10 N70E 411.84' BUR OAK 8 N64 1/2 W 557.7' LAND ROLLING SECOND RATE PRAIRIE.
- 1866 LOCKE REMONUMENTATION FIELD NOTES.
- PG 34 WEST ON NORTH LINE SECTION 1.
- 2668.38 INTERSECTED 1/4 LINE FOR TOWN 3 (CENTER) 1.98' SOUTH OF COR. FOUND LARGE LIMESTONE IN CENTER OF HIGHWAY AND IN LINE OF N AND S FENCES.
- 5334.12 INTERSECTED WEST BOUNDARY 14.52' SOUTH OF COR. FOUND BT IN SEC 2
- 5330.82 INTERSECTED COR FOR TOWN 3 FOUND BT IN SEC 35 AND STUMP OF BT IN SEC 36. COR IN CENTER OF HIGHWAY.
- 2667.06 SET 1/4 COR 1.32' EAST OF 1/4 COR FOR TOWN 3 FOR FIRST HALF MILE VAR CORRECTED 6-58, FOR LAST HALF MILE VAR CORRECTED 7-11 1/4 MONUMENT MARKED WITH FIGURE 1 ON SOUTH FACE AUG 27, 1868
- 1933 SUNNY VOL 3 PG 234 SET 1" X 36" PIPE IN CONCRETE PAVEMENT. 1.4' NORTH OF CENTER OF CONCRETE PAVEMENT IN LINE WITH S. FENCE. SHOWS A DISTANCE OF 2644.7 TO THE FENCE INTERSECTION AT THE CENTER OF SECTION 1. SHOWS THE MONUMENT 1.32' EAST OF THE SOUTH QUARTER CORNER OF SECTION 36.
- 1970 BATTERMAN JR. VOL 4 PG 298 SHOWS A 3/4" PIN WITH REFERENCE MONUMENTS. DOES NOT STATE ANYTHING ABOUT THE CORNER.
- 1988 BARNES A-23 & Z-23 FOUND 3/4" REROD AND 4" DEEP FOUND PIPE IN CONCRETE PAVEMENT. 5'3" DEEP FOUND CUT LIMESTONE. BROKE TOP 25" OF STONE. MEASURED TO BOTTOM AND THEN PUT TOP BACK ON. PLACED BENT PIPE HORIZONTALLY BY THE STONE. FOUND 15" X 6" 2 1/2" LIMESTONE 1.26' (MAP-1.26') TO THE WEST. STONE IS 1.82 SOUTH OF THE PIPE. STONE IS AT THE CENTER OF THE PAVEMENT. IT APPEARS FROM THE EXCAVATION THAT SUNNY NEVER DUG FOR THE CORNER. ACCEPTED FOUND CUT LIMESTONE. USING DOT CONTROL THE COORDINATES FOR THE S 1/4 COR SEC 36 ARE N/S 246,125.79 E/W 2,231,251.80
- 1988 BARNES VOL 6 PG 389 N89-52-21E 2666.95 TO NE COR SEC 1 & N89-56-08W 2667.20 TO NW COR SEC 1.
- 1989 WIDOT MAP # 16703 PROJ. #1704-03-22 1/2" REINFORCING ROD 246,125.44; 2,231,252.99) N73-38-58W 1.24 TO 1/2" REINFORCING ROD AT S 1/4 COR SEC 36 (246,125.79; 2,231,251.80
- 1992 BARNES A-23(1) Z-21(1)(CENTER TWP) CORNER AS DESCRIBED IN PREVIOUS U.S. PUBLIC LAND SURVEY MONUMENT RECORD IS BEING PERPETUATED. TIES TO NEW DOT REFERENCE MONUMENTS & OLD REFERENCE MONUMENTS. TIES TO CUT LIMESTONE. MONUMENT WILL BE DESTROYED BY CONSTRUCTION. S 1/4 COR SEC 36 WHICH IS A CUT L.S. IS N76-33-18W 1.28 FROM N 1/4 COR SEC 1 PLYMOUTH TWP.
- 1992 BARNES A-23(2) FOUND DISK AT THE S 1/4 CORNER OF SECTION 36 BUT NOTHING AT THE N 1/4 CORNER OF SECTION 1. TIES FROM DOT REFERENCE MONUMENTS TO LIMESTONE, DOT DISK, OLD PIPE, & OLD REROD. N76-33-18W 1.28' TO S 1/4 COR SEC 36 CENTER TWP

SHEET 1 OF 3 CORNER CODE A-23(3)

Daniel Barnes
1/28/03

PL512

FD DOT REFERENCE DISK MONUMENTS IN CONCRETE. FD DOT DISK IN PAVEMENT AT THE S ¼ COR SEC 36 CENTER TWP. THIS IS IN HARMONY TO RECORD REFERENCE TIES.

C) Was the corner restored through acceptance of (1) an obliterated evidence location, or, (2) a found perpetuated location?

FD DISK PERPETUATED FOUND ACCEPTED BUT L.S. & USED MY 1992 OBSERVATIONS TO DETERMINE POSITION OF N ¼ COR SEC 1 PLYMOUTH TWP.

D) Describe any material discrepancy between the location of the corner as restored or reestablished and the location of that corner as previously restored or reestablished by distance and direction. Show the discrepancy on the plan view drawing under (a), above. Show the distances between the corner as previously restored or reestablished and (1) the corner as restored or reestablished, and (2) to at least 4 of the witness monuments shown on the drawing in (a), above.

(E) Was the corner reestablished through lost corner proportionate methods? If so, show the method, including the directions and distances to other public land survey corners used as evidence or used for proportioning the corner location.

I, Donald Barnes, hereby certify that the corner location as identified by the corner code index was determined by me under my direction and control and that this U.S. Public Land Survey Monument Record is correct and complete to the best of my knowledge and belief.

Seal

Donald Barnes

EMBLOSS

1/28/03

SHEET 2 OF 3

CORNER CODE **A-23(3)**
A-E 7.08 REQUIREMENT

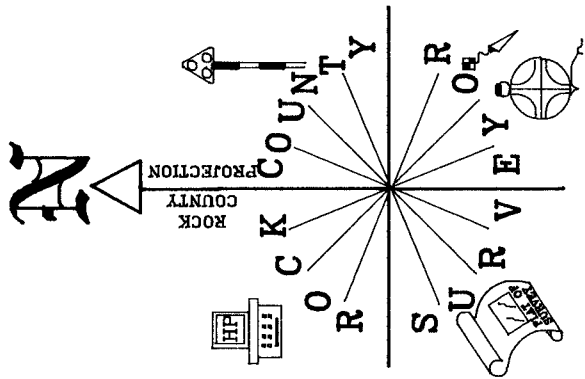

OBSERVATION SHEET #55
 FB #2 PG 777
 FB #3 PG 2,7

- DOT DISK IN CONC.
- REC I.P. DUE TO RD CONSTRUCTION PIPES ARE VERY DEEP. DID NOT DIG FOR.

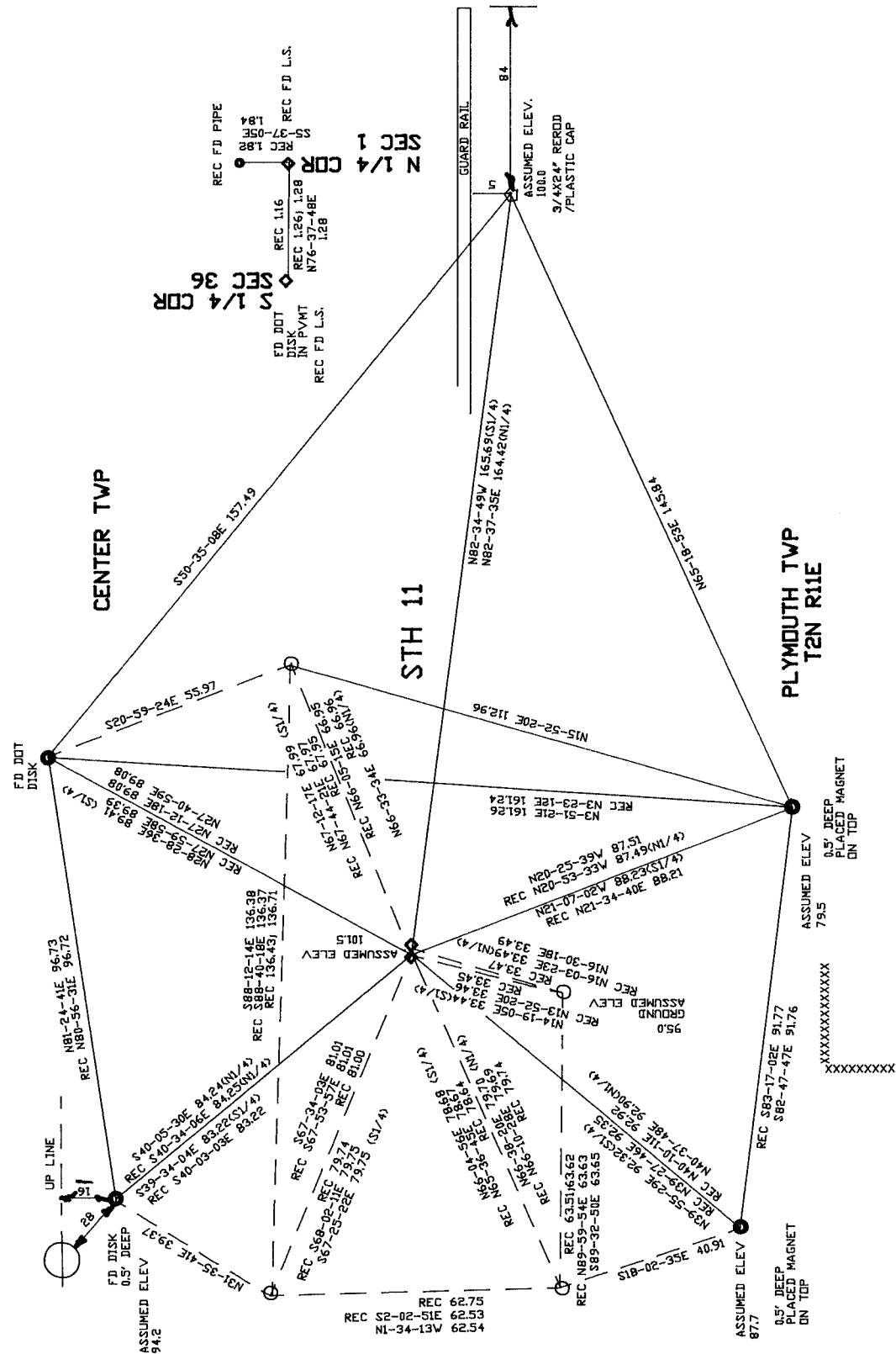

Ronald Barnes
 EMBOSSED SEAL

SHEET 3 OF 3

A-23(B)

1/28/03