

Paper weight-110# (minimum)

Black nonfading ink required

# U.S. PUBLIC LAND SURVEY MONUMENT RECORD

For Public Land Survey Corners In:  
T. 2 N. R. 11 E. 4th P.M.

WI ADMINISTRATIVE CODE A-E 7.08 REQUIREMENT  
REV 10/23/2004 USMONREC.DWG

CORNER CODE INDEX

PLYMOUTH TWP  
ROCK COUNTY WI

IF AVAILABLE  
ROCK COUNTY COORDINATES PREFERRED

A	1	2	3	4	5	6	7	8	9	10	11	12	13	14	15	16	17	18	19	20	21	22	23	24	25	A
B																										B
C																										C
D																										D
E																										E
F																										F
G																										G
H																										H
J																										J
K																										K
L																										L
M																										M
N																										N
O																										O
P																										P
Q																										Q
R																										R
S																										S
T																										T
U																										U
V																										V
W																										W
X																										X
Y																										Y
Z																										Z

North \_\_\_\_\_ Elev. \_\_\_\_\_

East \_\_\_\_\_

Hor. Datum \_\_\_\_\_ Vert. Datum \_\_\_\_\_

LATITUDE \_\_\_\_\_ ELLIPS. HT. \_\_\_\_\_

LONGITUDE \_\_\_\_\_

NAD83(91) \_\_\_\_\_ NETWORK ADJ. YR \_\_\_\_\_

GPS (X) \_\_\_\_\_ TRAVERSE (X) \_\_\_\_\_

BASED ON THE FOLLOWING CONTROL:

PLACE MONUMENT SYMBOL  AT PROPER LOCATION ON ABOVE INDEX

CORNER MONUMENT

WITNESS MONUMENT

BEARINGS ARE BASED ON: \_\_\_\_\_

FIELD BOOK \_\_\_\_\_ PAGE # \_\_\_\_\_

SHEET 1 OF 6

SHOW A PLAN VIEW DRAWING DEPICTING THE CORNER MONUMENT AND SURROUNDING PHYSICAL FEATURES, INCLUDING THE EXCAVATION AREA AND DEPTH.

PLANNING & ZONING COMMITTEE ADOPTED THIS FORM ON 12/2/1982

CORNER CODE A-21(3)

**PL511      NEGORSEC2**

*(B) Describe any record evidence, monument evidence, occupational evidence, testimonial evidence or any other material evidence you considered, and whether the monument was found or placed.*

- 1833 MULLET WEST ON SOUTH SIDE SECTIONS 34 & 35 {35}**  
1518 LEAVE PRAIRIE TO ENTER MARSH  
2442 STREAM 6.6' C SOUTH  
2508 LEAVE MARSH AND ENTER PRAIRIE  
SET QUARTER SECTION POST IN PRAIRIE AND MADE MOUND  
5280 SET POST CORNERS SECTIONS 34 & 35 IN PRAIRIE AND MADE MOUND. LAND ROLLING PRAIRIE SECOND RATE. BY OBSERVATION VAR 7-45E  
*NORTH BETWEEN SECS 1 & 2*  
2640 QUARTER SEC COR {BURR O 12 N71E 148.5' BURR O 24 S47W 48.84' BURR O 12 BURR O 24} MARKED  
5240.4 INT. N BDG 3.3' W OF P {BURR O. 24 S41E 316.8' BURR O. 14 S45W 293.7 LAND HIGH & ROLLING 2<sup>ND</sup> RATE BUR & BLACK O. TIMBER FRIDAY DEC 20<sup>TH</sup> 1833
- 1833 MULLET VAR 7-55 WEST ON SOUTH SIDE OF SECTION 36 T3N R11E**  
2640 SET QUARTER SECTION POST IN PRAIRIE AND MADE MOUND  
5280 SET POST CORNER SECTIONS 35 & 36 BUR OAK 10 N70E 411.84' BUR OAK 8 N64 1/2 W 557.7' LAND ROLLING SECOND RATE PRAIRIE.
- 1833 HARRISON NORTH BETWEEN SECS 1 & 2**  
2640 QUARTER SEC COR {BURR O 12 N71E 148.5' BURR O 24 S47W 48.84' BURR O 12 BURR O 24} MARKED  
5240.4 INT. N BDG 3.3' W OF P {BURR O. 24 S41E 316.8' BURR O. 14 S45W 293.7 LAND HIGH & ? 2<sup>ND</sup> RATE BUR & BLACK O. TIMBER FRIDAY DEC 20<sup>TH</sup> 1833
- 1845 TWP RD RECORDS BK 1 PG 5 BEGINNING AT THE NW COR OF SEC 1 AND RUNNING SOUTH ON THE LINE BETWEEN SEC 1 & 2 IN SAID TWP 2602.38' TO THE QUARTER POST ON THE WEST SIDE OF SEC 1 AFORESAID; THENCE SOUTH ON THE LINE AFOREMENTIONED TO THE SW COR OF SAID SEC 1 IN ALL 5242.38'? ((7) 49 CH & 43 LKS)**
- 1846 TWP RD REC BK 1 PG 14 BEGINNING AT THE 1/4 POST ON WESTSIDE OF SEC 12 T2N R11E AND RUNNING NORTH 2640 ON THE WEST SIDE OF SAID SEC 12; THENCE NORTH 5240.4' ON THE WEST SIDE OF SEC 1 IN SAME TOWN AND RANGE; THENCE NORTH 5280 ON THE WEST SIDE OF SEC 36, T3N OF RANGE 11 EAST. SAID RD IS 66' IN WIDTH. VARIATION OF NEEDLE 8 E.**
- 1868 LOCKE PLYMOUTH TWP REMONUMENTATION NOTES.**  
*PG 35 SOUTH BETWEEN SECS 1 & 2 VAR 7-10*  
2621.52 INTERSECTED 1/4 LINE AT COR. FOUND SOUTH BT AND STAKE & STONE SET ON CORNER. COR IN CENTER OF HIGHWAY AND IN LINE OF E & W FENCE.  
*CONTINUED SOUTH WITH VAR 7-25*  
5285.28 INTERSECTED SOUTH BOUNDARY 2.97' EAST OF COR. VAR CORRECTED 7-21 AUG 27 1868  
*PG 34 WEST ON NORTH LINE SECTION 1.*  
2668.38 INTERSECTED 1/4 LINE FOR TOWN 3 (CENTER) 1.98' SOUTH OF COR. FOUND LARGE LIMESTONE IN CENTER OF HIGHWAY AND IN LINE OF N AND S FENCES.  
5334.12 INTERSECTED WEST BOUNDARY 14.52' SOUTH OF COR. FOUND BT IN SEC 2

*Donald Barnes*  
*10/09/2009*

PL511 NECORSEC2

5330.82 INTERSECTED COR FOR TOWN 3 FOUND BT IN SEC 35 AND STUMP OF BT IN SEC 36. COR IN CENTER OF HIGHWAY.

2667.06 SET 1/4 COR 1.32' EAST OF 1/4 COR FOR TOWN 3 FOR FIRST HALF MILE VAR CORRECTED 6-58, FOR LAST HALF MILE VAR CORRECTED 7-11 1/4 MONUMENT MARKED WITH FIGURE 1 ON SOUTH FACE AUG 27, 1868

*PG 38 EAST ON NORTH LINE SEC 2 VAR 5-45*

505.56 CENTER SLUICE BRIDGE

2657.49 INTERSECTED 1/4 LINE FOR TOWN 3 7.26' NORTH OF COR. FOUND STONE WITH STAKE SET BY ANDREW CODDINGTON IN OLD MOUND. COR. IN CENTER OF HIGHWAY AND IN LINE OF FENCE RUNNING N. VAR CORRECTED 5-36

*CONTINUED EAST FROM 1/4 COR OF T3 WITH VAR 7-12*

3034.02 CENTER OF BRIDGE 33' WIDE OVER CREEK.

5313.66 INTERSECTED EAST BOUNDARY AT COR.

5316.96 INTERSECTED EAST BOUNDARY OF SEC 35 T3N AT COR.

2656.83 SET 1/4 COR 0.66' WEST OF 1/4 COR FOR T3N 1/4 MONUMENT MARKED WITH FIG 2 ON SOUTH FACE. [MID WAY BETWEEN NW & NE CORNERS SEC 2] AUG 28, 1868

1877 RUGER VOL 2 PG 234 FOUND STONE MONUMENT @ NE COR SEC 1. CALLS FOR 2652.54' TO N 1/4 CORNER OF SECTION 2 AND 2616.89' TO EAST QUARTER CORNER OF SECTION 2. STATES THAT THE N 1/4 COR SEC 2 IS SOUTH OF A LINE DRAWN FROM SECTION CORNER TO SECTION CORNER [NW SEC 2 TO NE SEC 2].

1933 SUNNY VOL 3 PG 234 & 235 @ NE COR SEC 2 SET 1X30" LONG PIPE IN CONCRETE PAVEMENT, 2.4' NORTH OF CENTER OF SAME. CALLS FOR 2667.2' TO N 1/4 CORNER OF SECTION 1 AND 2621.6 TO W 1/4 CORNER OF SECTION 1.

1962 BATTERMAN JR. VOL 4 PG 142 @ NE COR SEC 2 FOUND 1" PIPE UNDER BLACKTOP AND REFERENCED SAME.

1962 STH 11 #11267 STATES NOTHING ABOUT MON.

1971 LEE CSM VOL 2 PG 30 PK @ SE COR SEC 35.

1975 COMBS CSM 5-169 FD PIPE FD IRON PIPE @ NE COR SEC 2. LOT NEAR NE COR.

1976 BARNES VOL 5 PG 222 2664 +/- FROM SE COR SEC 35 TO E 1/4 COR SEC 35

1977 BARNES VOL 5 PG 362 FOUND A PK AS RECORDED AS THE NE CORNER OF SECTION 2 T2N R11E PLYMOUTH IN VOL 4 PG 142 & VOL 5 PG 140. IT IS ERRONEOUS. DUG AND FOUND 1" PIPE 0.3' DEEP. IT AGREED WITH THE DISTANCE TO THE N 1/4 CORNER OF SECTION 2 AS RECORDED IN VOL 3 PG 235. SET ALUMINUM MONUMENT. DUG AND FOUND NOTHING AT SE CORNER OF SECTION 35. SET ALUM MONUMENT AT RECORD DISTANCE FROM NE CORNER OF SEC 2 AS RECORDED IN VOL 3 PG 235. CALLS FOR 2656.86 TO N 1/4 CORNER OF SECTION 2.

1979 SCHROEDER VOL 5 PG 531 SE COR SEC 35 TO S 1/4 COR SEC 35 IS 2659.5, SE COR SEC 35 TO E 1/4 COR SEC 35 IS 2661.58, & ANGLE @ SE COR SEC 35 IS 89-48 FROM S 1/4 COR TO E 1/4 COR SEC 35.

1979 SCHROEDER CSM VOL 8 PG 333 STATES NOTHING ABOUT MON. ANGLE 89-48 @ SE COR SEC 35 FROM S 1/4 TO E 1/4 COR SEC 35.

1979 SCHROEDER CSM VOL 8 PG 334 STATES NOTHING ABOUT MON. @ SE COR SEC 2. ANGLE 89-48 @ SE COR SEC 35 FROM S 1/4 TO E 1/4 COR SEC 35. LOTS CREATED NEAR SE COR SEC 35.

*Donald Barnes*  
*10/09/2009*

SHEET 2 OF 6  
CORNER CODE A-21(3)

PL511 NECORSEC2

- 1979 NORTHROP MAP #809 BERNTSEN @ NE COR SEC 2 FD ALUM. MON. OF REC. WEST OF SE COR SEC 35. 2660.25 FROM SE COR SEC 35 TO E 1/4 COR SEC 35.
- 1980 BARNES CENTER TWP REMON. CALLS FOR SW COR SEC 36 AS 3.3 EAST OF NW COR SEC 1.
- 1987 SCHROEDER #12727 STATES NOTHING ABOUT SE COR SEC 35 MON.
- 1988 BARNES VOL 6 PG 388 & 389 CALLS FOR RECORD DISTANCES AND CALLS FOR N89-14-40E 2654.68 FROM NE COR SEC 2 TO N 1/4 COR SEC 2, S0-41-45E 2621.72 FROM NE COR SEC 2 TO N 1/4 COR SEC 1, S89-56-08E 2667.20 FROM NW COR SEC 1 TO N 1/4 COR SEC 1, AND N1-01-11W 2660.68 TO FROM SE COR SEC 35 TO THE E 1/4 CORNER OF SECTION 35. FOUND DOT DISK @ SE COR SEC 35 & NE COR SEC 2.
- 1988 BARNES Z-21(CENTER TWP) SE COR SEC 35 USING DOT CONTROL N/S 246,046.57; E/W 2,228,589.77 ALUM. MON SEE OLD TIE SHEET.
- 1989 WIDOT PROJ. MAP #16692 #1704-03-22 ALUM 246,128.43; N88-48-56E 3.29 TO SE COR SEC 35 CENTER TWP. ALUM AT SE COR SEC 35 CENTER TWP (246,128.50; 2,228,589.06). CI AT E 1/4 COR SEC 33 (248,788-70; 2,228,541.64)
- 1992 BARNES A-21 (MAY) ALUM. MONUMENTS WILL BE DESTROYED BY ROAD CONSTRUCTION. DISTANCES & BEARINGS TO OLD REFERENCE MONUMENTS & NEW DOT REFERENCE MONUMENTS. N88-04-47E 3.28' FROM NE COR SEC 2 TO SE COR SEC 35 CENTER TWP.
- 1992 BARNES A-21(1) & Z-21(1) (NOV) FOUND DOT DISKS @ NE COR SEC 2 & SE COR SEC 35 & ACCEPTED IT. REFERENCED SAME. 3.34' (REC 3.28') BETWEEN NE COR SEC 2 & SE COR SEC 35.
- 1993 COMBS MAP #10329 FD ALUM. MON.
- 2000 COMBS A-19(4) FD DOT DISK N83-58-10W 13.25 FROM SET PK NAIL. THIS DISK DID NOT CHECK D.O.T. RIGHT OF WAY MAP DISTANCES EAST-WEST FOR SECTION CORNER LOCATION. DISK DID NOT CHECK D. BARNES PREVIOUSLY MEASURED DISTANCES EAST-WEST. N89-14-40E 2657.74 TO DOT DISK @ SE COR SEC 35, S89-20-22E 2659.14 TO DOT DISK @ SW COR SEC 35, 0.66' EAST OF N 1/4 COR SEC 3, AND STATEMENT "PRORATED DISTANCES USING DON BARNES ANGLE. D. BARNES ANGLE @ S 1/4 COR SEC 35 FROM SW TO SE COR SEC 34 IS 178-35-02. REFERENCED SAME. FD DOT DISK N83-58-10W 13.25 & SET IRON REBAR FOR REF. MONUMENTS. SET PK MASONRY NAIL AT S 1/4 COR SEC 35.
- 2000 COMBS CSM 24-55 @ NE COR SEC 2 FD DOT DISK, @ N 1/4 COR SEC 2 & S 1/4 COR SEC 35 SET PK. 2655.02 FROM NE COR SEC 2 TO N 1/4 COR SEC 2 & S 1/4 COR SEC 35 IS 0.66 EAST OF N 1/4 COR SEC 2.
- 2001 COMBS CSM VOL 24 PG 186 DOT MON. 2654.36 FROM SE COR SEC 35 TO PK AT S 1/4 COR SEC 35
- 2001 LATHROP CSM VOL 25 PG 164 -166 FD DISK @ NE COR SEC 2 & 2621.95 TO W 1/4 COR SEC 1.
- 2002 COMBS #14515 @ NE COR SEC 2 FD DOT MON. S89-56-51E 3.33 TO DOT MON. @ SW COR SEC 36 & 2667.19 FROM NW COR SEC 1 TO N 1/4 COR SEC 1.
- 2003 BARNES A-21(2) USED MY 1992 OBSERVATIONS. ACCEPTED DOT DISK & REFERENCE MONUMENTS
- 2004 BARNES PLYMOUTH TWP REMON. N89-24-13E 3.28 FROM NW COR SEC 1 TO SW COR SEC 36, S89-18-28E 2662.85 FROM SW COR SEC 36 TO S 1/4 COR SEC 36

SHEET 3 OF 6  
CORNER CODE A-21(3)

10/09/09  
Donald  
Barnes

PL511 NECORSEC2

- 2005 COMBS CSM VOL 28 PG 159 FD DISK @ NW COR SEC 1 & PK @ N 1/4 COR SEC 1. 2667.18 BETWEEN CORNERS.
- 2005 COMBS CSM VOL 28 PG 266 FD DISK @ NW COR SEC 1 & PK @ W 1/4 COR SEC 1. 2661.95 BETWEEN CORNERS.
- 2005 LATHROP #15224 FD DOT MON. @ NE COR SEC 2 S89-56-51E 3.33 TO DOT MON @ SW COR SEC 36. 2667.19 FROM NW COR SEC 1 TO N 1/4 COR SEC 1.
- 2006 COMBS CSM VOL 30 PG 268 FD DISK @ NE COR SEC 2.
- 2008 COMBS CSM VOL 32 PG 179 FD DISK @ S 1/4 COR SEC 36 & SW COR SEC 36. 2662.72 BETWEEN S 1/4 COR TO SW COR SEC 36.
- 2008 COMBS CSM VOL 32 PG 220 SAME AS PG 179 BUT ALTERED LOT.

FD WIDOT DISKS @ NE COR SEC 2 & SE COR SEC 35 & ALL 4 WIDOT REF. DISKS. @ SE COR THE 1992 REC ALUM IS .10' NORTH & 0.02' WEST OF WIDOT DISK. @ NE COR SEC 2 THE 1992 REC ALUM IS 0.04 NORTH & 0.03 EAST OF THE WIDOT DISK.

C) Was the corner restored through acceptance of (1) an obliterated evidence location, or, (2) a found perpetuated location?

ACCEPTED THE ALUM. MONUMENT POSITION. @ THE SE COR SEC 35 THE WIDOT DISK IS S10-45-47E 0.10' OF THE REC. ALUM. @ THE NE COR SEC 2 THE WIDOT DISK IS S38-10-57W 0.05' OF THE REC. ALUM.

D) Describe any material discrepancy between the location of the corner as restored or reestablished and the location of that corner as previously restored or reestablished by distance and direction. Show the discrepancy on the plan view drawing under (a), above. Show the distances between the corner as previously restored or reestablished and (1) the corner as restored or reestablished, and (2) to at least 4 of the witness monuments shown on the drawing in (a), above.

SEE REFERENCE TIES.

I, Donald Barnes, hereby certify that the corner location as identified by the corner code index was determined by me under my direction and control and that this U.S. Public Land Survey Monument Record is correct and complete to the best of my knowledge and belief.

Seal

*Donald Barnes*  
Barnes

10/09/09

SHEET 4 OF 6

CORNER CODE **A-21(3)**  
A-E 7.08 REQUIREMENT

CENTER TWP T3N R11E

1833 HARRISON 0.0  
 2009 BARNES N1-13-59W 2656.66  
 1877 RUGER 2697.75  
 1868 LOCKE VAR 7-16 2702.7

2009 BARNES 50-25-42E 2701.57  
 2009 BARNES 6-389 S1-03-59E 2701.55  
 1877 RUGER 2697.75  
 1868 LOCKE VAR 7-16 2702.7

2009 BARNES 6-389 S89-56-30E 2662.72  
 1933 SUNNY 3-234 2662.58  
 1868 LOCKE 2662.44  
 1833 MULLETT VAR7-55 2640

2009 BARNES 88-42-08E 2658.86  
 2004 BARNES S88-42-07E 2658.83  
 2000 COMBS A-19 S89-20-22E 2659.14  
 1997 COMBS 2659.14  
 1997 BARNES S88-42-10E 2658.72  
 1989 WIDOT 2658.75  
 1888 BARNES 6-388 S89-20-21E 2658.72  
 1877 RUGER 2-234 2654.19  
 1868 LOCKE 2657.49  
 1833 MULLETT 2640

1868 LOCKE VAR5-36 2656.83  
 1877 RUGER 2-234 VAR4-45 2654.19  
 1933 SUNNY 3-235 2656.9  
 1988 BARNES 6-389 S89-20-19E 2658.06  
 1989 WIDOT INVERSE S89-20-19E 2658.07  
 2000 COMBS CSM24-63 2658.48  
 2004 BARNES S88-42-06E 2658.17  
 2009 BARNES S88-42-07E 2658.21

2009 BARNES 89-52-46E 2657.30  
 2004 BARNES N89-52-46E 2657.30  
 2000 COMBS A-19 N89-14-40E 2657.74  
 1997 BARNES N89-52-52E 2657.32  
 1989 WIDOT 2657.31  
 1888 BARNES 6-389 N89-14-41E 2657.31  
 1979 SCHROEDER 5-531 2659.50  
 1868 LOCKE 2659.47  
 1833 MULLETT 2640

2009 ADJ BARNES S89-18-24E 2662.93  
 2008 COMBS CSM 2662.72  
 2004 BARNES S89-18-28E 2662.85  
 1997 BARNES S89-18-19E 2662.64  
 1989 DOT INVERSE S89-56-30E 2662.74  
 1989 DOT 2662.77  
 1888 BARNES 6-389 S89-56-30E 2662.72  
 1933 SUNNY 3-234 2662.58  
 1868 LOCKE 2662.44  
 1833 MULLETT VAR7-55 2640

1868 LOCKE #6828 VAR7-12 2656.83  
 1868 LOCKE REMON 2656.83  
 1877 RUGER 2-234 VAR4-45 2652.54  
 1933 SUNNY 3-235 2656.9  
 1977 BARNES 5-362 2656.86  
 1888 BARNES 6-389 N89-14-44E 2654.68  
 1989 WIDOT INVERSE N89-14-43E 2654.65  
 1997 BARNES N89-52-54E 2654.69  
 2000 COMBS CSM24-55 2655.02  
 2004 BARNES N89-52-48E 2654.67  
 2009 BARNES N89-52-49E 2654.67

1868 LOCKE VAR7-11 2667.06  
 1933 SUNNY 3-234 2667.2  
 1988 BARNES 6-389 S89-56-08E 2667.20  
 1989 WIDOT INVERSE S89-56-09E 2667.22  
 1977 BARNES S89-17-58E 2667.12  
 2002 COMBS #14515 2667.19  
 2004 BARNES S89-18-11E 2667.37  
 2004 BARNES S89-18-11E 2667.37  
 2005 COMBS CSM28-159 2667.18  
 2005 LATHROP #15224 2667.19  
 2009 BARNES S89-18-07E 2667.45

1868 LOCKE VAR7-11 2667.06  
 1933 SUNNY 3-234 2667.2  
 1988 BARNES 6-389 S89-56-08E 2667.20  
 1989 WIDOT INVERSE S89-56-09E 2667.22  
 1977 BARNES S89-17-58E 2667.12  
 2002 COMBS #14515 2667.19  
 2004 BARNES S89-18-11E 2667.37  
 2004 BARNES S89-18-11E 2667.37  
 2005 COMBS CSM28-159 2667.18  
 2005 LATHROP #15224 2667.19  
 2009 BARNES S89-18-07E 2667.45

1868 LOCKE VAR7-11 2667.06  
 1933 SUNNY 3-234 2667.2  
 1988 BARNES 6-389 S89-56-08E 2667.20  
 1989 WIDOT INVERSE S89-56-09E 2667.22  
 1977 BARNES S89-17-58E 2667.12  
 2002 COMBS #14515 2667.19  
 2004 BARNES S89-18-11E 2667.37  
 2004 BARNES S89-18-11E 2667.37  
 2005 COMBS CSM28-159 2667.18  
 2005 LATHROP #15224 2667.19  
 2009 BARNES S89-18-07E 2667.45

PLYMOUTH TWP T2N R11E

2009 BARNES 50-25-42E 2701.57  
 2009 BARNES 6-389 S1-03-59E 2701.55  
 1877 RUGER 2697.75  
 1868 LOCKE VAR 7-16 2702.7

2009 BARNES 50-25-42E 2701.57  
 2009 BARNES 6-389 S1-03-59E 2701.55  
 1877 RUGER 2697.75  
 1868 LOCKE VAR 7-16 2702.7

1868 LOCKE VAR 7-16 2702.7  
 1877 RUGER 2697.75  
 2009 BARNES N1-13-59W 2656.66  
 1877 BARNES 6-389 2654.75  
 1833 HARRISON 0.0

1868 LOCKE VAR 7-16 2702.7  
 1877 RUGER 2697.75  
 2009 BARNES N1-13-59W 2656.66  
 1877 BARNES 6-389 2654.75  
 1833 HARRISON 0.0

- 1962 BATTERMAN VOL 4 PG 142
- 1976 BARNES PLY FB#1 PG 2  
FD PK
- 1977 PLY FB #1 PG 9 FD PIPE
- 1977 CENTER TWP FB #1 PG 29  
OBSERVATION SHEETS 6-511,1-511,3-5114-511
- 1977 BARNES VOL 5 PG 362 FD PIPE  
& SET ALUM. REF SAME  
PLY FB#1 PG 9  
& CEN FB#1 PG 29
- 1992 BARNES A-21
- 1992 BARNES A-21(1)  
WIDOT PLACED DISK IN CONC.

G:\PLYDISK\DISK1\PL511.DWG  
G:\PLYDISK\DISK3\PL511(SOFT)

FOUND DOT DISK  
IN CONCRETE MONUMENT  
WIDOT SET IN 1992

**CENTER TWP  
T3N R11E**

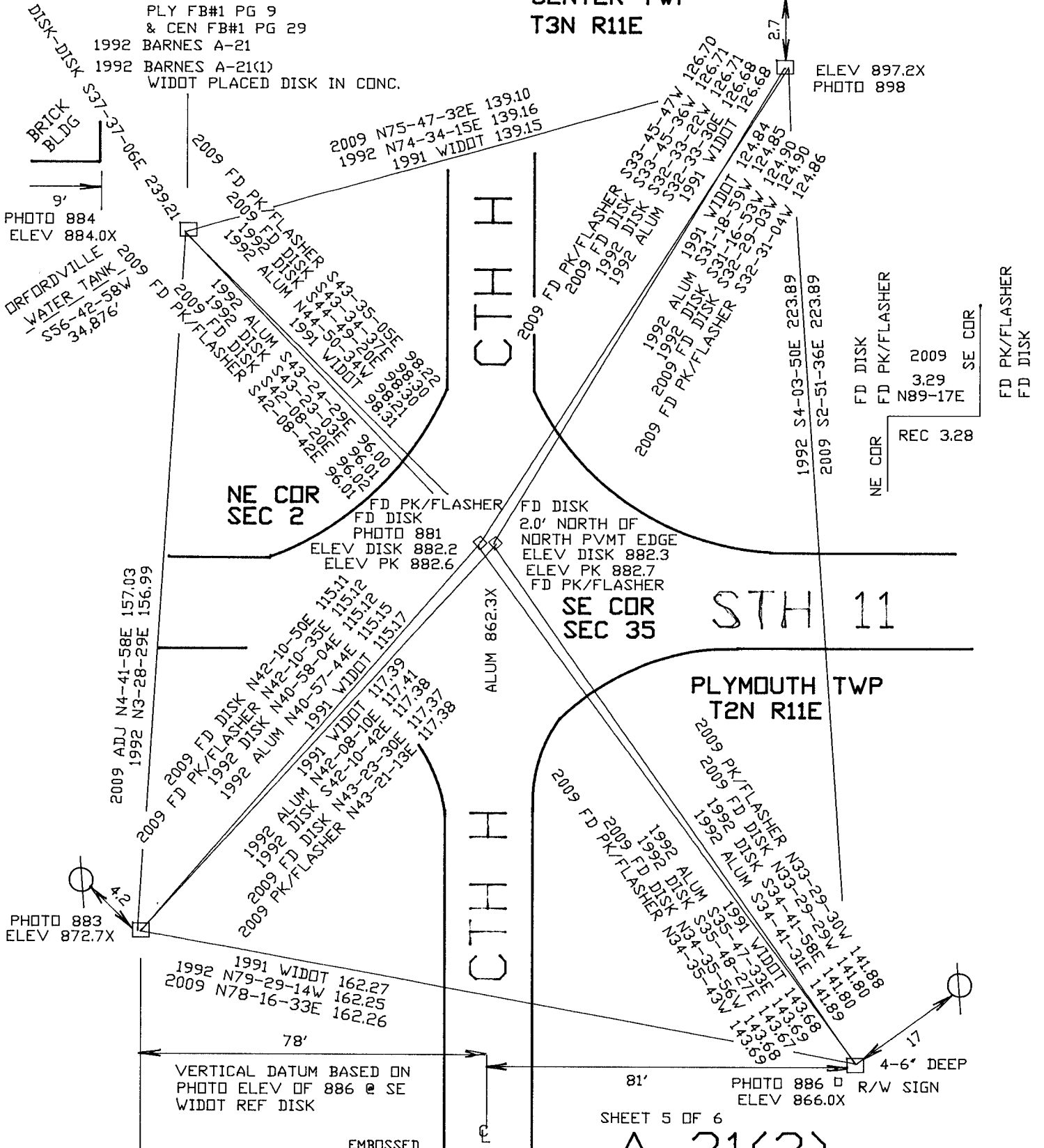

SHEET 5 OF 6  
**A-21(3)**

10-09-2009  
*D. Barnes*