

A record & plat of a Survey made on
 See fifteenth town two range ten East

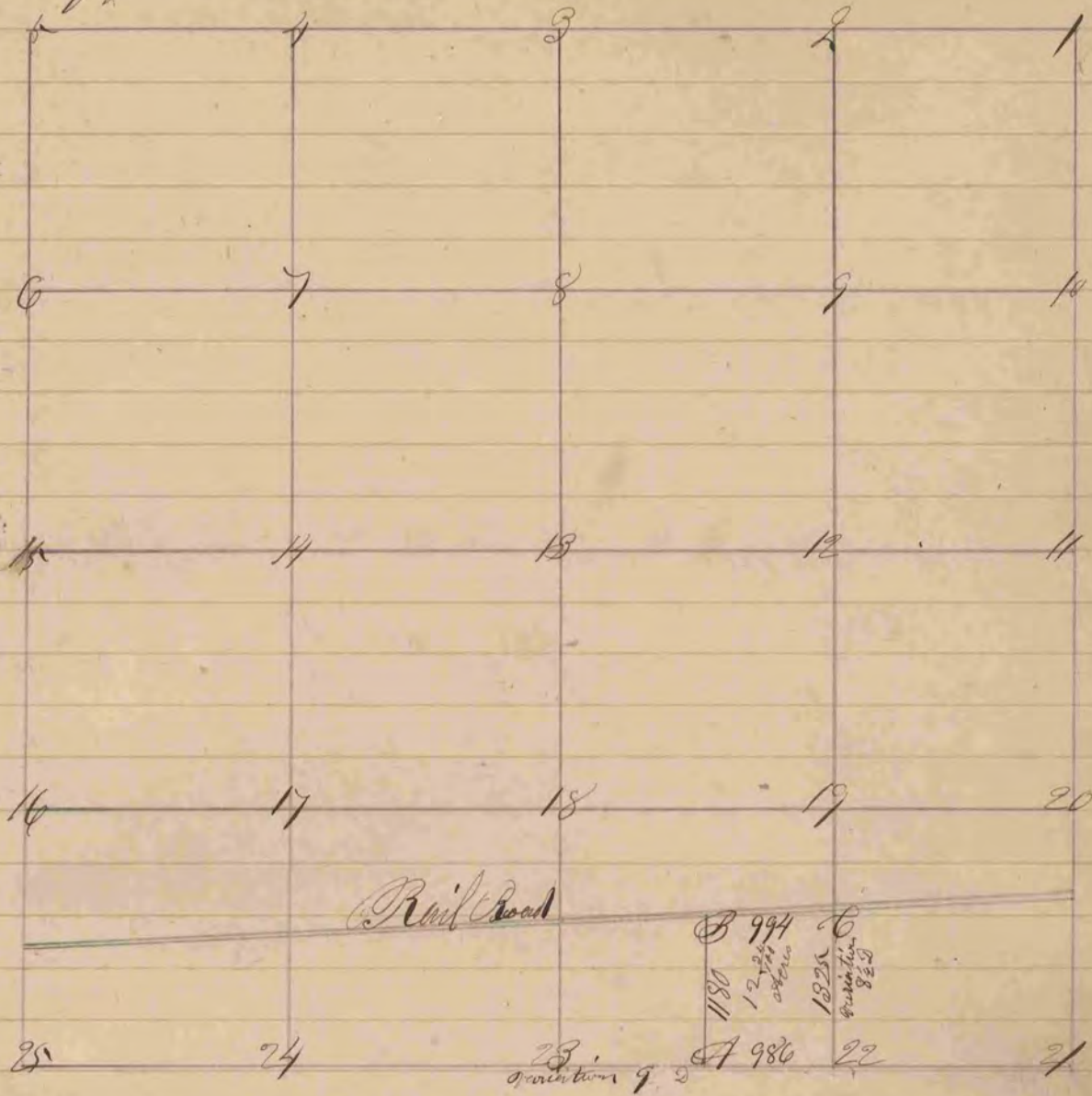

- Fig 22 Stump N 18 W, 101 1/2
 " S 57 W, 85
 A Br 10 inch N 37 W, 51
 Stump S 24 1/2 W, 33 1/4
 B Br 12 inch S 77 W, 15 1/2
 " 10" S 75 E, 61 3/4
 C Stump S 57 1/2 E, 37
 " S 49 1/2 W, 111

The above survey was made April 2nd 1857
 Joseph Church & Charles H. Brown
 Deputy County Surveyors of Rock County
 Wis