

Found cor. set by Locke

Found old stake & stump of B. Co.

Found B. Co. cor. set by Locke

Set from Sec. cor. A & B.

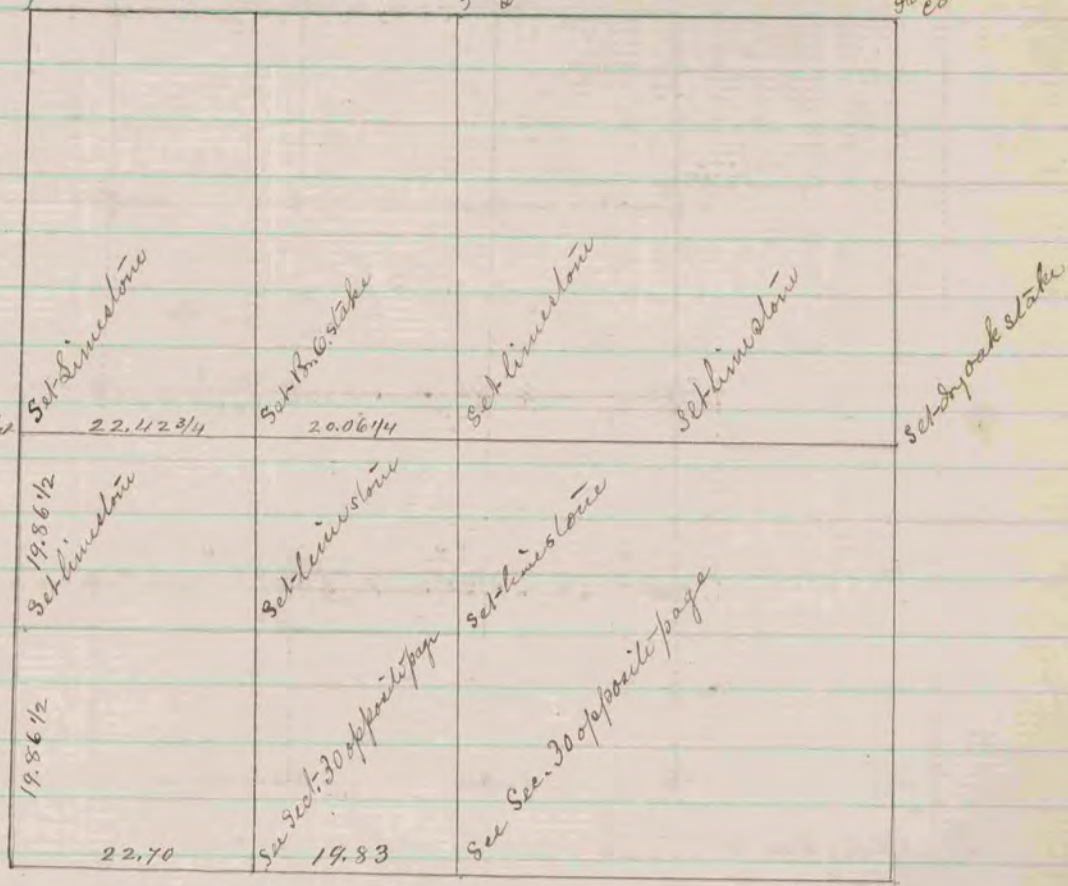

The above is a correct Record & Plat of a survey made by me June 28 & 29 1869 on Sec. 19. T. 2 R. 10. Spring Valley. B. K. Lee Dep. Co. Surveyor

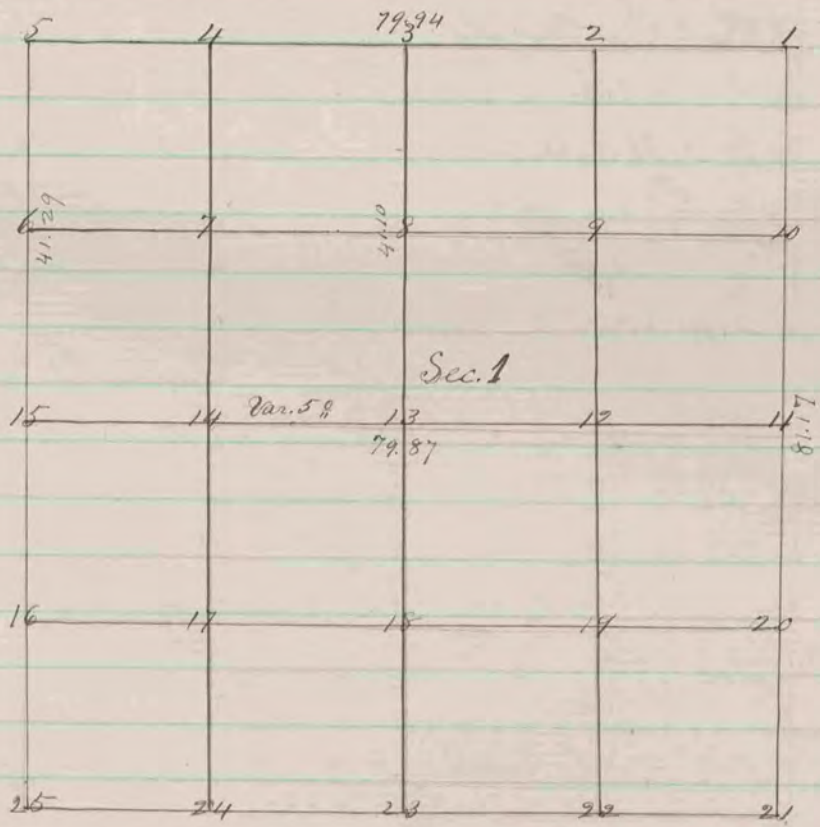

A Record of a Survey of Sec. 1 Johnstown
 Fig. 13 Represents the centre of the Section
 Br. Q. 14 N. 10 also Br. Q. 10 N. 63 W. 37
 The above survey was made by me Feb. 19-1852
 Peter McBean County Surveyor