

A Record and Plat of a survey made on Sec 18 Town 1 Range 14
for Strong, Dutcher, Wood & Vanderlin Surveyed Feb 22nd & 23rd
by Edward Ruger County Surveyor of Rock County (1854)
distances given in chains
variations marked on the lines W.S.

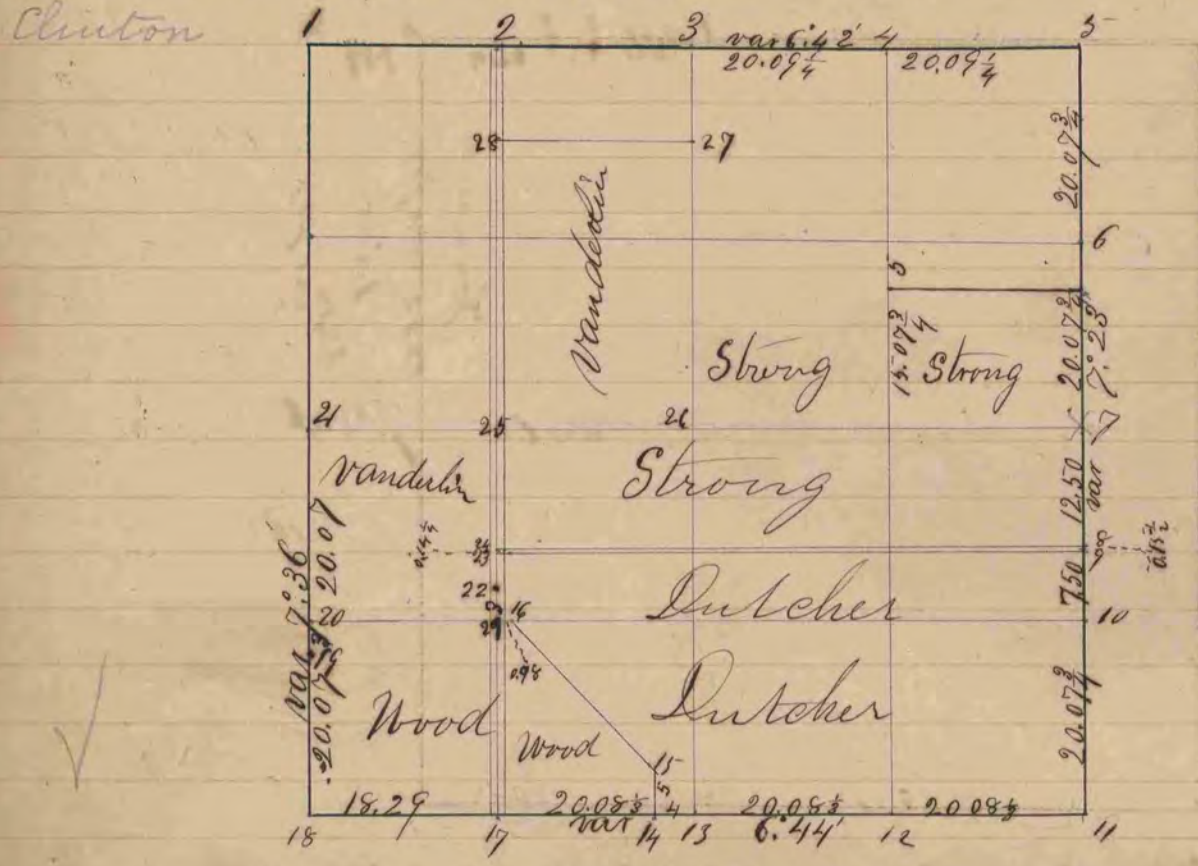

- Fig 7 Post in pine N 54° E 6 1/2
- " " " " " S 50° W 5
- " 9 Locust 5 N 46° E 26 5
- " " " " " S N 19° 25' E 216 2/3
- " 11 Tree sec corner Willow 2 inches
- " 12 Wild Plum 2 N 30° 45' E 11 2/3
- " " " " " 2 N 5° 05' E 14
- " 14 Black Oak 4 N 15° 15' W 34 1/2
- " " " " " 8 S 73° W 22 1/2
- " 15 " " " " 9 S 69° W 66 2/3
- " " " " " 13 N 27° 40' E 58
- " 19 Burr Oak 22 N 73° 25' W 42 3/4
- " " " " " 10 S 19° 35' E 74 1/2
- " 20 " " " " 10 S 87° 55' W 248 1/3
- " " " " " 17 S 26° W 175
- " 21 took new W. Trees
- " " Burr Oak 8 S 51° 35' E 170 3/4
- " " " " " 8 N 68° 28' W 170
- " 29 " " " " 8 S 84° 20' W 114 var 6.42