

COUNTY SURVEYOR  
RECORD 1859-1906

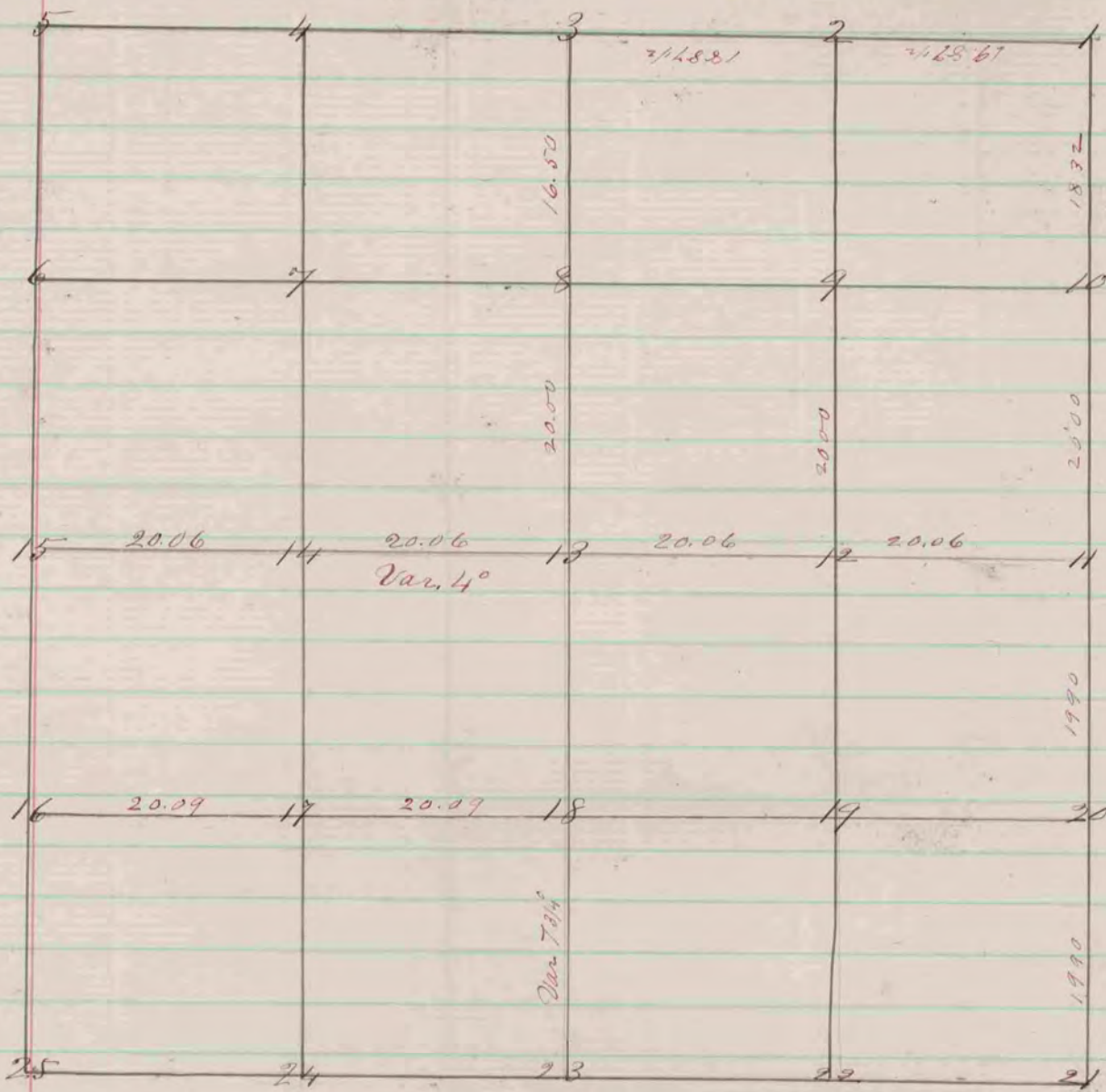

- Fig 13 Br.  $\odot$  14 S  $29\frac{1}{2}$  E 128 Br.  $\odot$  12 N 60 E 135.
- 12 " 18 N  $1\frac{1}{2}$  E 201 " " S 82 W 141
- 18 Bl.  $\odot$  14 N  $45\frac{1}{4}$  E 14
- 16 Br.  $\odot$  12 N  $14\frac{1}{2}$  E 222 Br.  $\odot$  14 N 64 E 43
- 2 Post & Stone
- 3 " "
- 8 " "
- 10 " "

A Record & Plat of a Survey made on Sec. 153  
R 10 E. Magnolia - Aug. 1853  
Joseph Church  
Co. Surveyor

COUNTY SURVEYOR  
RECORD 1859-1906