

78. A record and plot of a survey made on
See twenty two town four range twelve East

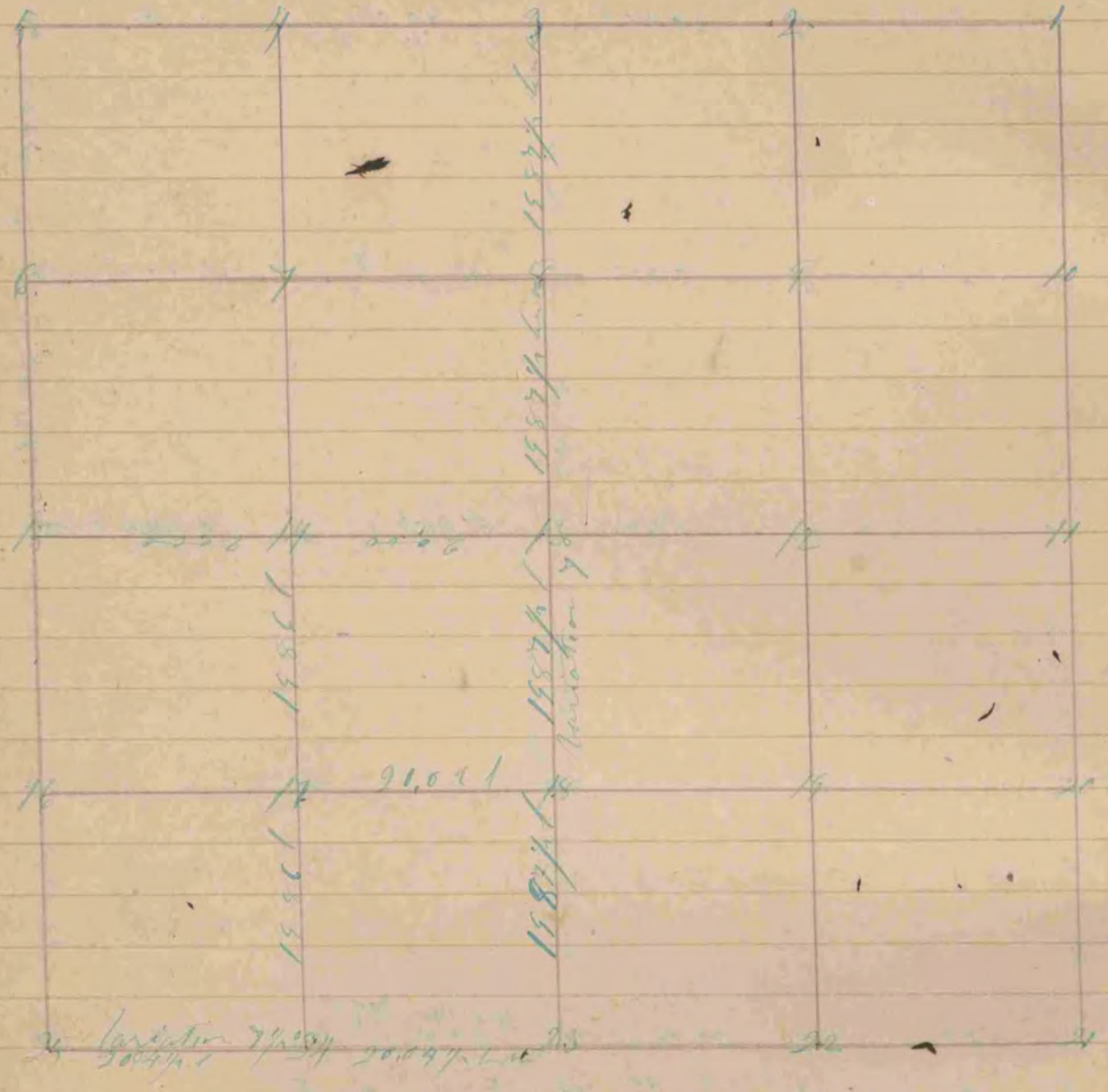

- 13 Br C 20 at 50% E 37
 - 12 N 39 E 25
 - 8 " 18 at 39% W 27
 - 24 " 8 at 58% W 38
 - Hickory 8 at 5 E 37
 - 17 Br C 12 at 14 E 37
 - " 12 at 85 W 56
 - 18 Hickory 6 at 44% E 11
 - Br C 10 at 3 E 9
- Fallon

The above survey was made the 13th day of Feb 1858.
Joseph Church County Surveyor
of Rock County Wisconsin