

A Record of a Survey of Section Eighteen in the Town of Avon

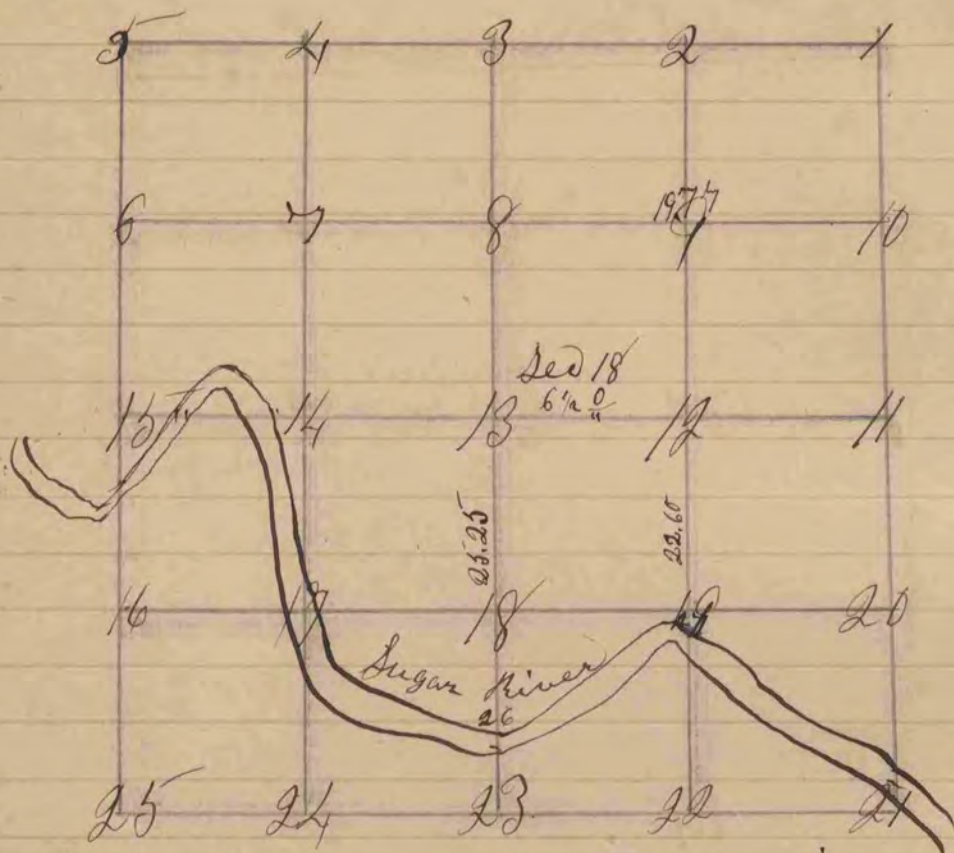

figure 13 Represents the Centre of the section

fig 13 post in marsh

- " 14 W 0 20 N 17 E 37 also maple 14. N 21 W 55
- " 18 Barj wood 10 S 15 W 40 also Elm 6 S 81 E 37
- " 26 on Bank of River Cherry 10 N 59 1/2 W 58 also W 0 8
- " " N 51 1/2 W 58 links
- " 12 Post in Slough
- " 27 yel 0 8 N 38 1/2 W 256 also yel 0 10 N 6 1/2 E 156
- " 8 Post in Willows
- " 7 yel 0 10 S 17 W 49. also yel 0 10 S 69 E 70

The above survey was made the 5th & 6th January 1892  
 Peter M. Bean County Surveyor