

A Record and Plat of a Survey made of a Highway
in Sec. 33 Town 3 North Range 12 East of 4th
Principal Meridian } Surveyed April 1st 1859
Distances given in chains } by Edward Burger
Variations marked on lines } Co. Surveyor - Rock Co. Wis.
Janesville

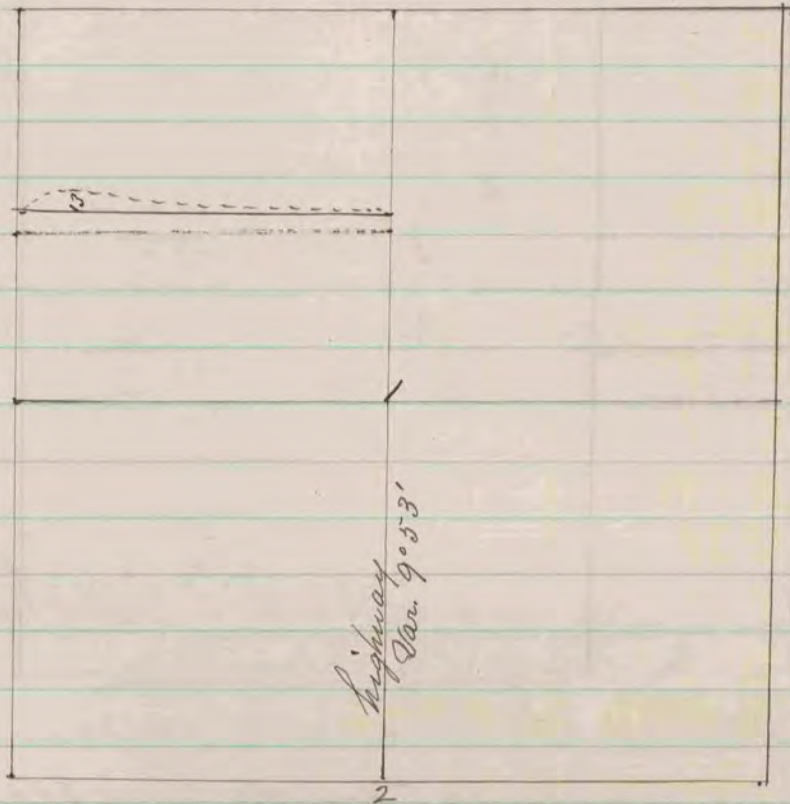

Fig. 2 Took new witness Trees
 Burr Oak 10 N 44° 25' E 591 } Var 7° 25'
 " " 16 S 69° 55' W 685 3/4 }

The Highway above referred to commences at the South
(1/4) quarter post of Section (33) thirty three in Town
three (3) North, of Range twelve (12) East of the fourth
(4th) Principal Meridian and running thence North
and along the line between the S. W. and S. E. quarters
of said Sec. 33 to the centre of said Sec. 33 said Road
is one chain wide lying (50) fifty links on either side
of above mentioned line.