

Found con. as set by self

Rugers con. dug out but
found with 3 stones
Reset con. with W. O. stakes by
3 limestones

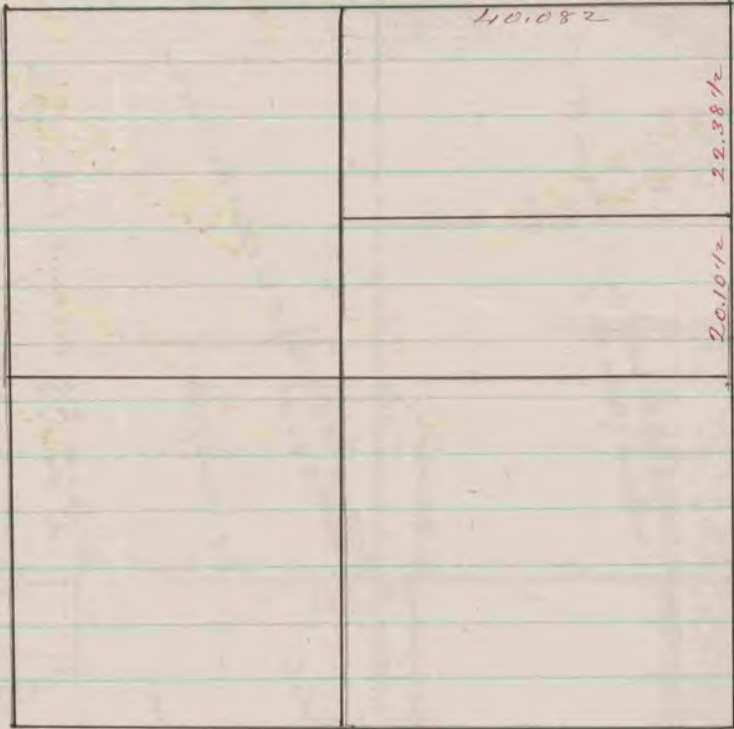

Set stake with limestone
on N. & S.

Found con. as set by Ruger

COUNTY SURVEYOR
RECORD 1859-1906

La Prairie 249

The above is a correct Record & Plat of a survey made
by me Sep. 24-1867 on Sec. 2, La Prairie -
S. D. Locke Co. Sur. Rock Co.

Found stake & stone on con.
Set W. O. stake with limestone on E & W.

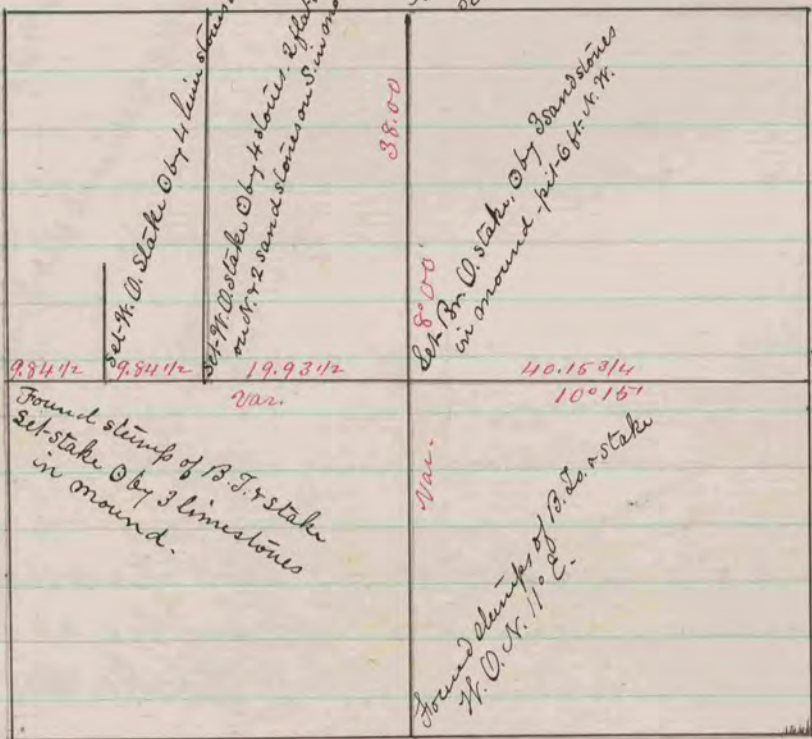

Found B. J. stake to mark B. J.
is 4.11 instead of 4.61

Found stump of B. J. stake
Set stake by 3 limestones
in mound.

Found stumps of B. J. & stake
W. O. N. 11° E.

Plymouth 257

The above is a correct Record & Plat of a survey made
by me Oct. 8-1867, on Sec. 6, Plymouth.
S. D. Locke, Co. Surveyor Rock Co.