

Found B.L. stakes with large hand on N. and smaller hand on S.
Set B.L. stakes with hand on E. & W.

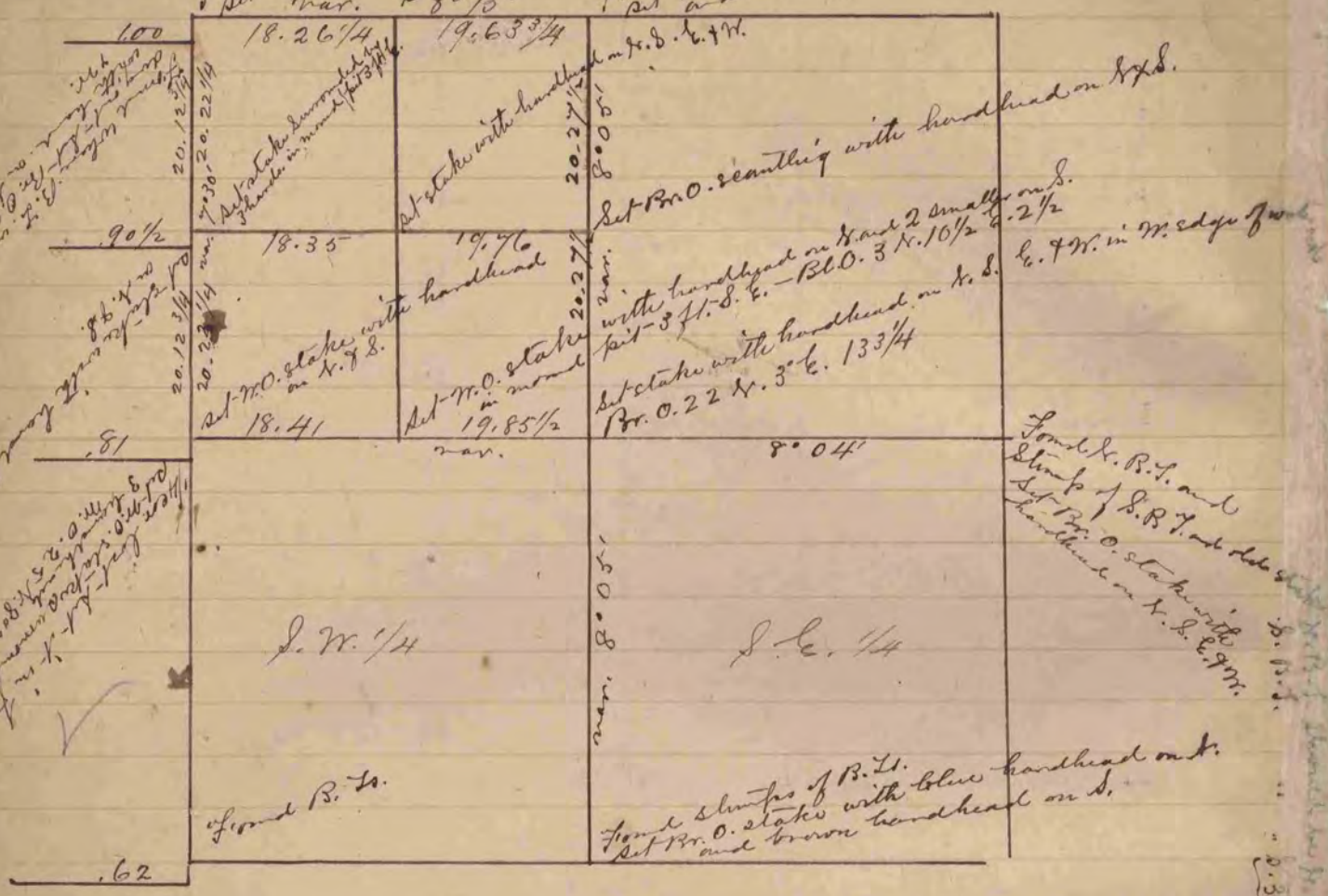

The above is a correct Record & Plat of a Survey made by me July 8, 1868, on Dec. 19, 1868.
S.D. Locke County Surveyor

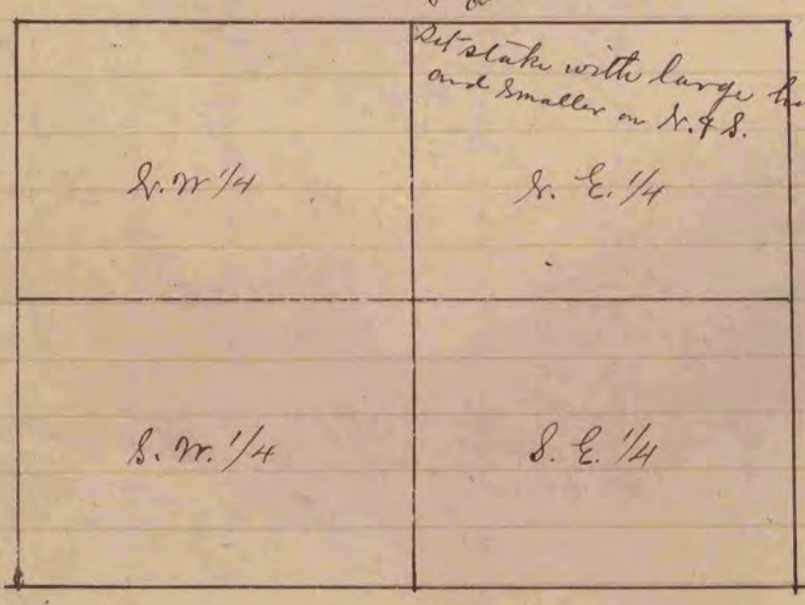

Found stumps of B.L. and remaining of old stakes
Set stake with large hand on E. & W. and smaller on N. & S.

COUNTY SURVEYOR
RECORD 1 1851-1869

The above is a correct Record & Plat of a Survey made by me Sept. 20, 1866, on Dec. 27, 1866.
Union
S.D. Locke County Surveyor