

A plat of a survey made on section fourteen in the Town of Turtle  
Town one range thirteen

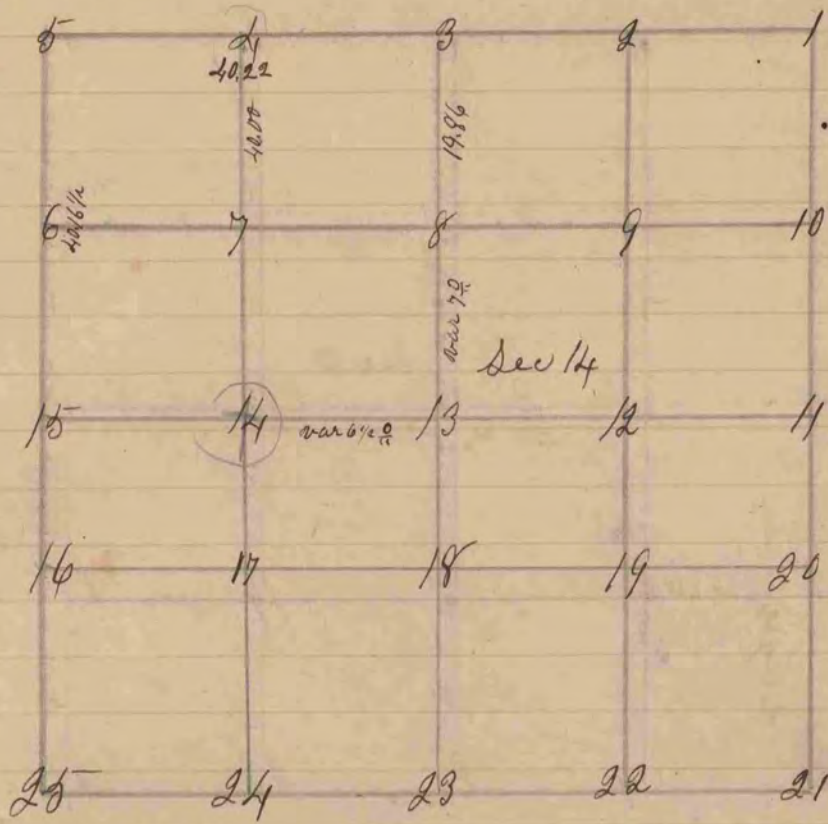

Figure 4 represents the N E corner of the NW 1/4 of the NW 1/4 sec  
fig 4 N 0 28 N 74 1/4 W 62 also N 0 8 8 1/2 E 46  
The above survey was made 1st day of June 1854  
Peter M. Dean County Surveyor