

set hand head stone 24x15x13
set line stone 12x4x4
surrounded by 4 line stones

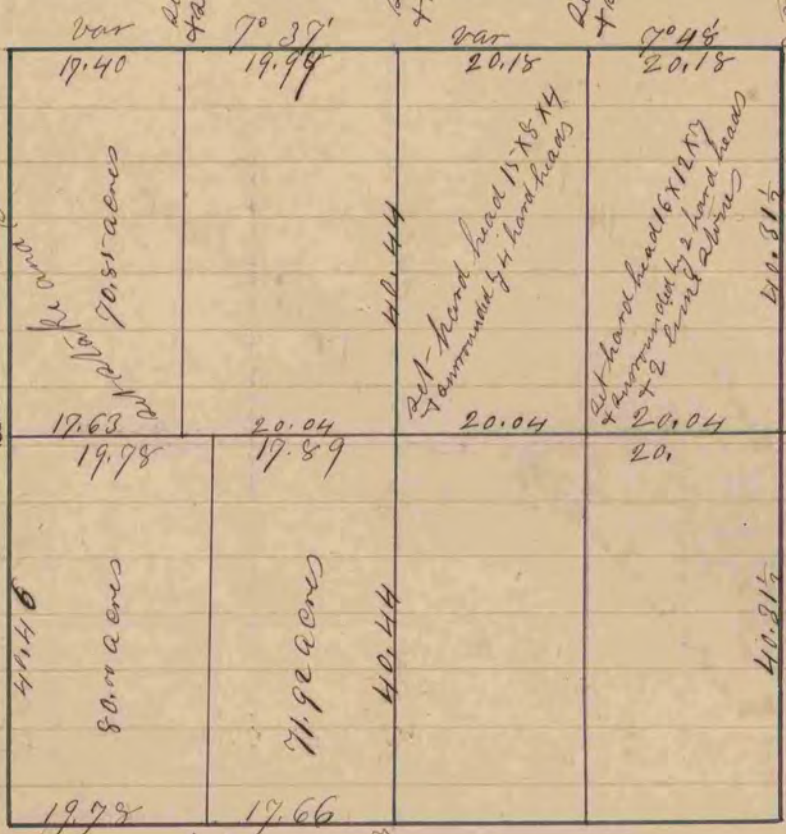

set hand head stone 20x14x8
surrounded by 4 hand heads
set line stone 10x8x2
surrounded by 4 line stones
set line stone 15x9x3
surrounded by 4 hand heads

set hand head 15x12x6
surrounded by 2 hand heads
+ 2 line stones
set line stone 18x8x3

A record and plat of a survey made on Dec 20 73
R.R. June 1st 1860 by Edward Rogers County Surveyor
for Rock County Wis

Janesville

COUNTY SURVEYOR
RECORD 1 1851-1869