

A record and plat of a survey made on Sec 34 Town four Range ten East

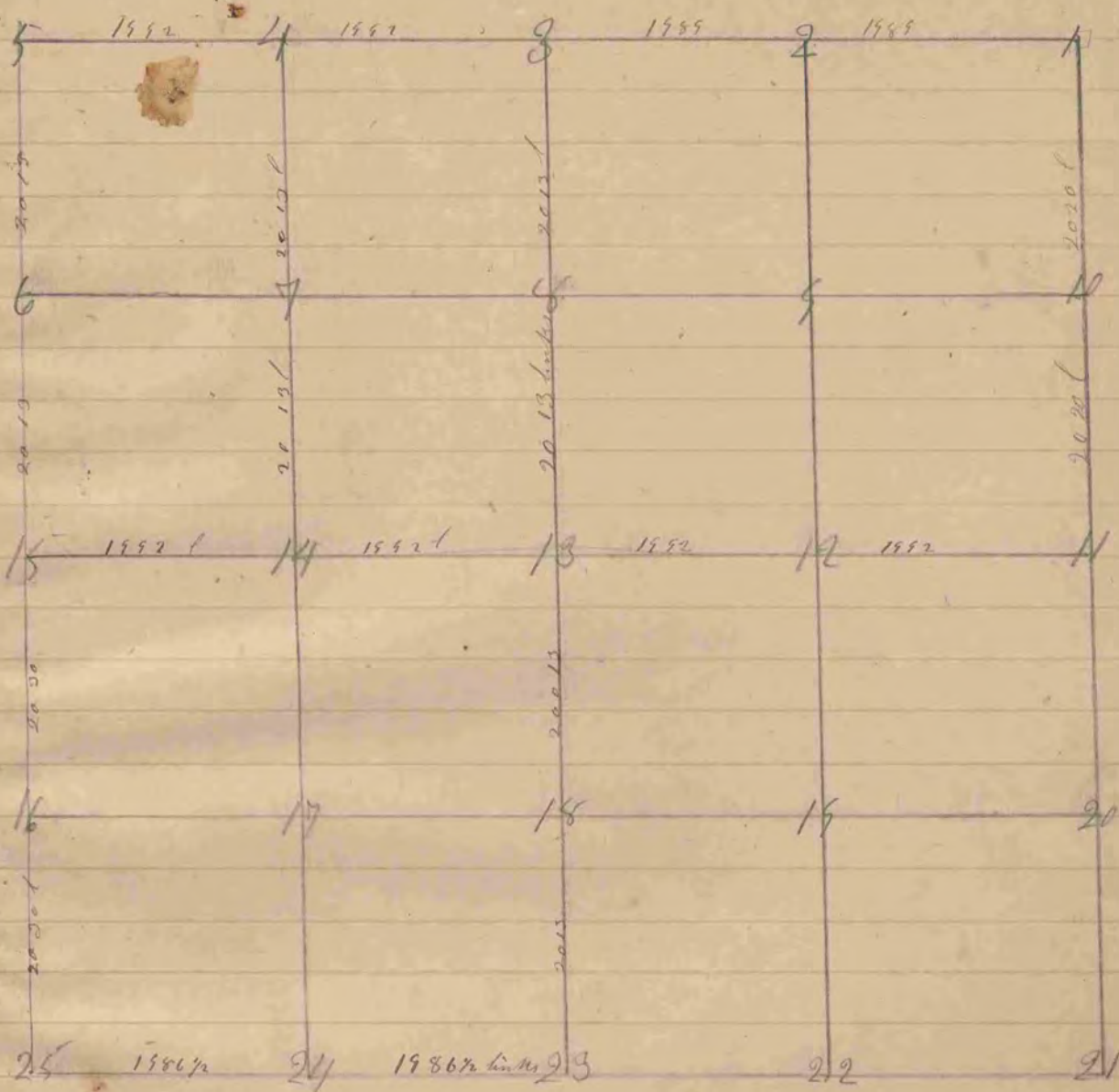

- Fig 13 is in the Centre of Sec lime Stone and Stake
- 18 post in the marsh
- 20 government Stake in the mound
- 24 Stake no bearings
- 16 Stake no bearings
- 5 Government trees do not agree made others Br O 15 S 64 1/2 W 85 to 14 S 63 1/2 E 253
- 4 Stake no bearings
- 2 W 1/2 Br O 20 S 44 1/2 E 65 (Br C 24 S 12 W 88 links)
- 12 post in the marsh
- 14 post in the marsh
- 7 Stake no bearings
- 17 Stake in the marsh

The above survey was made in the month of August 1855

Joseph Church County Surveyor
Rock County Wis