

A Record and Plat of See Six Town Four Range Ten East

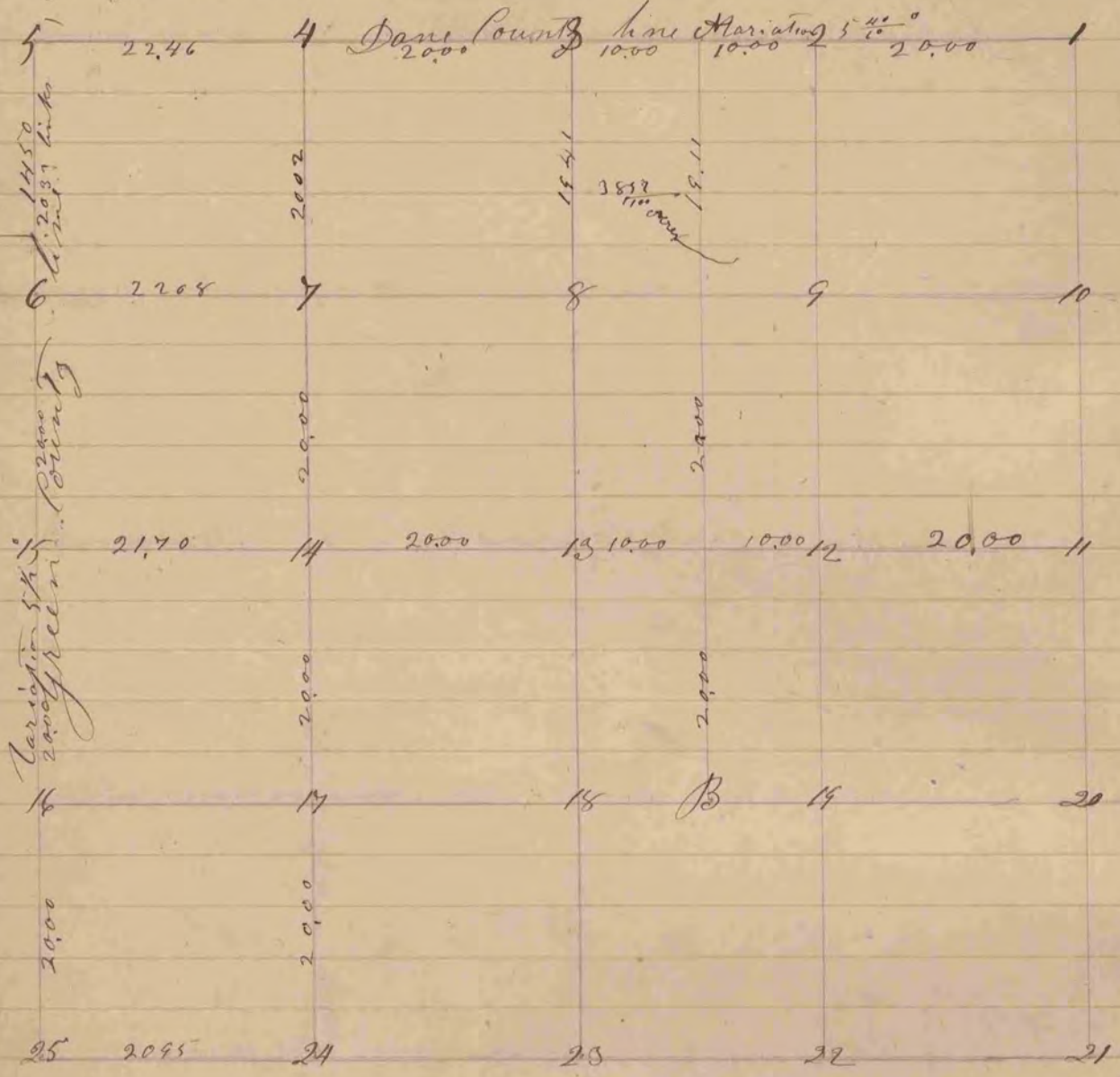

- Fig 13 Pt O 12 S 81 E 41
- " " 10 N 56 1/2 W 122
- " 3 18 S 42 E 41 Variation 5 1/2
- " " 14 S 47 1/2 W 92
- " 15 Stake in the Marsh
- Letters A & B Stakes no bearings

Union

The above Survey was made July 27 and 1858 Joseph Church County Surveyor of Rock County Wis