

109
A Record and Plat of a survey made on Sec 26
Town 2 North of Range 14 East of 4th Principal Meridian
for Chas Lee, William Wells + others 1859

Distances given in chains } Surveyed April 12th by Edward
Variations marked on the lines } Rager County Surveyor of Rock County
(Wi)

Bradford

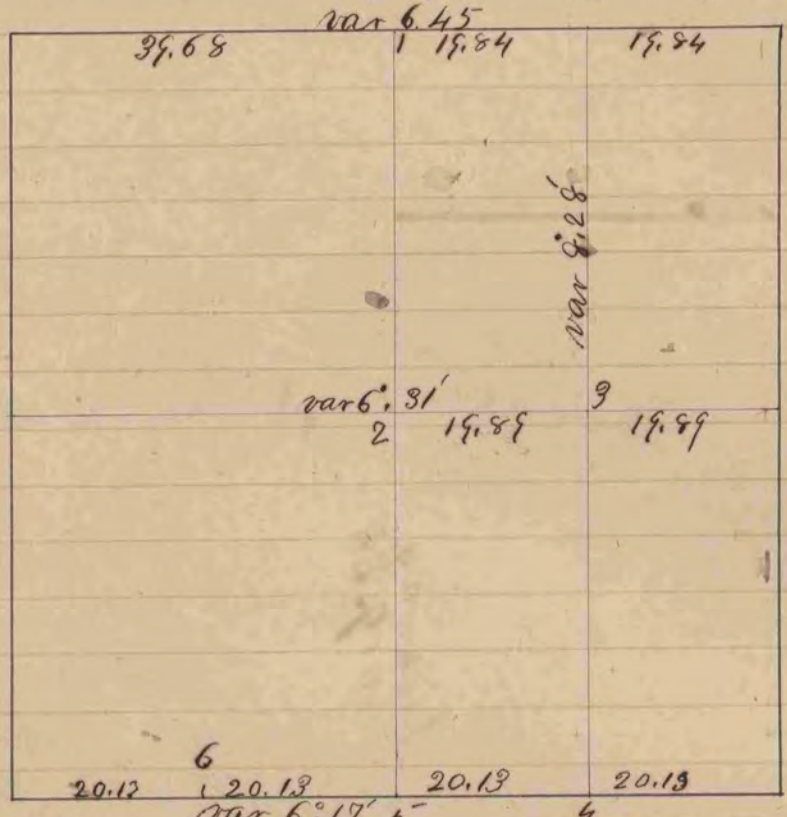

at 1-2-3-4-5-6 Set upst with no bearings