

Duaneville

Surrounded part with  
2 hand heads & 1 lime  
stone

Surrounded part  
by 3 hand heads

Surrounded part by  
3 hand heads

Planted 1 large hand  
head on east side of  
post

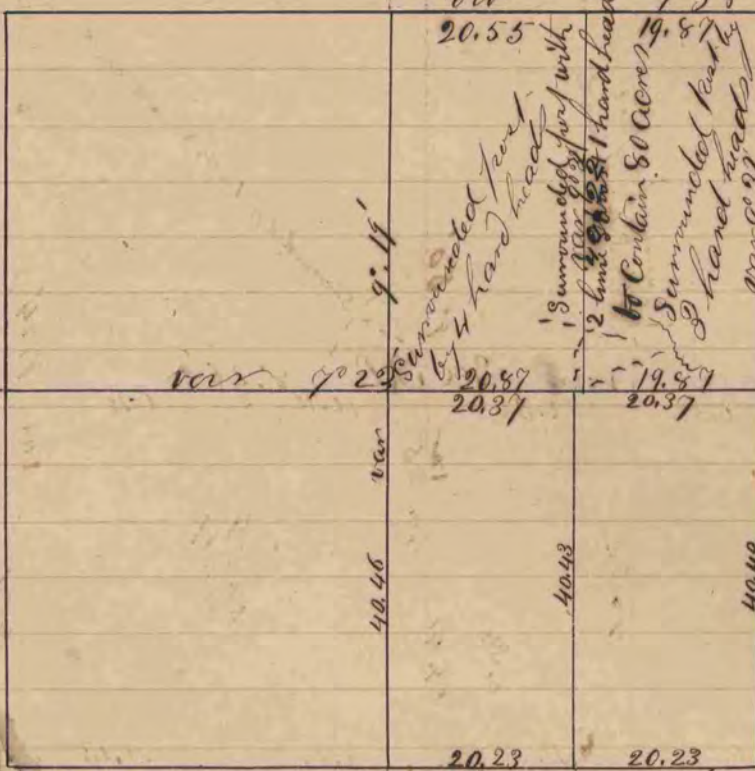

Surrounded part  
by 4 hand heads

Surrounded part with  
2 hand heads  
Contains 80 Acres  
Surrounded part  
by 2 hand heads

Surrounded part with  
3 hand heads

Surrounded part with 2 hand heads & 1 lime stone  
& 1 oak witness trees  
Burr Oak 16 S 58° 37' W 227  
" 10 S 42° E 150  
" var 7° 35'

Surrounded part with 3 hand heads  
& 1 oak witness trees  
Burr Oak 15 S 41° 15' E 78 1/2  
" 15 S 71° 15' W 85 1/4  
" var 7° 35'

A Record of a Survey made on Dec 21<sup>st</sup> 1859  
Surveyed August 29<sup>th</sup> 1859  
by Edward Ruger County Surveyor  
for Rock County Wis