

Record & Survey & plat of a survey made on Sec fourteen  
Town Two Range Ten East

COUNTY SURVEYOR  
RECORD 1 1851-1869

Spring Valley

COUNTY SURVEYOR  
RECORD 1 1851-1869

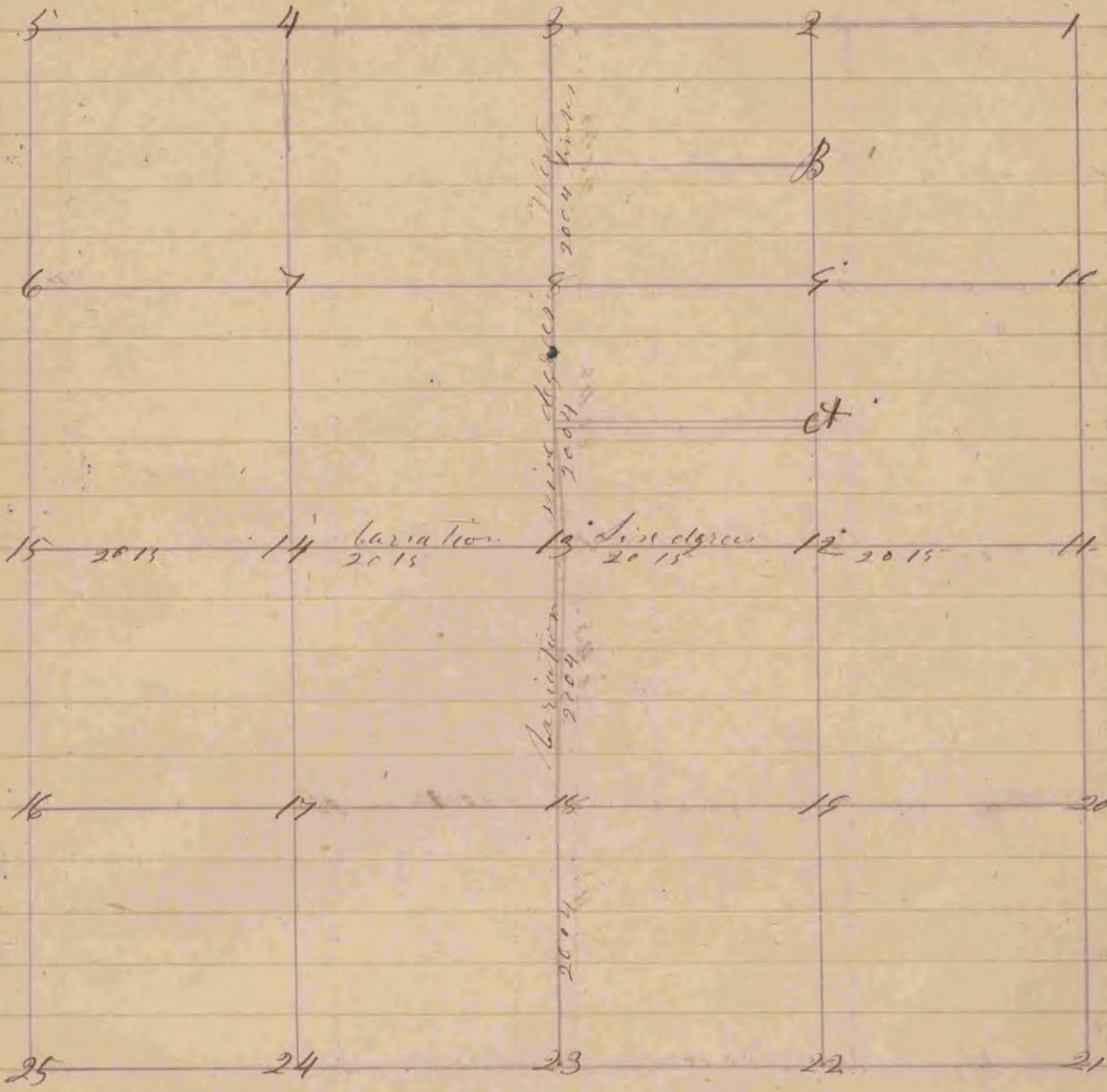

- Fig 13 Br C 20 S 10 1/2 E 73
- .. 14 N 85 E 74
- " 12 .. 28 S 10 W 59 1/2
- " 2 B/C 14 N 25 1/2 E 78
- .. 10 S 41 1/2 E 100
- 9 W/O 20 N 1 1/2 E 25
- .. 20 N 45 1/2 E 51 1/2

Letter A 71 O 12 S 75 E 89  
 .. 10 N 20 W 37 Variation of the compass 160 degrees

The Above Survey was made on the 25 & 26 of  
 March 1857 Joseph Church  
 County Surveyor Rock  
 County Mo