

A Record and Plot of a Survey made on
Sec Twenty nine Town three Range ten East

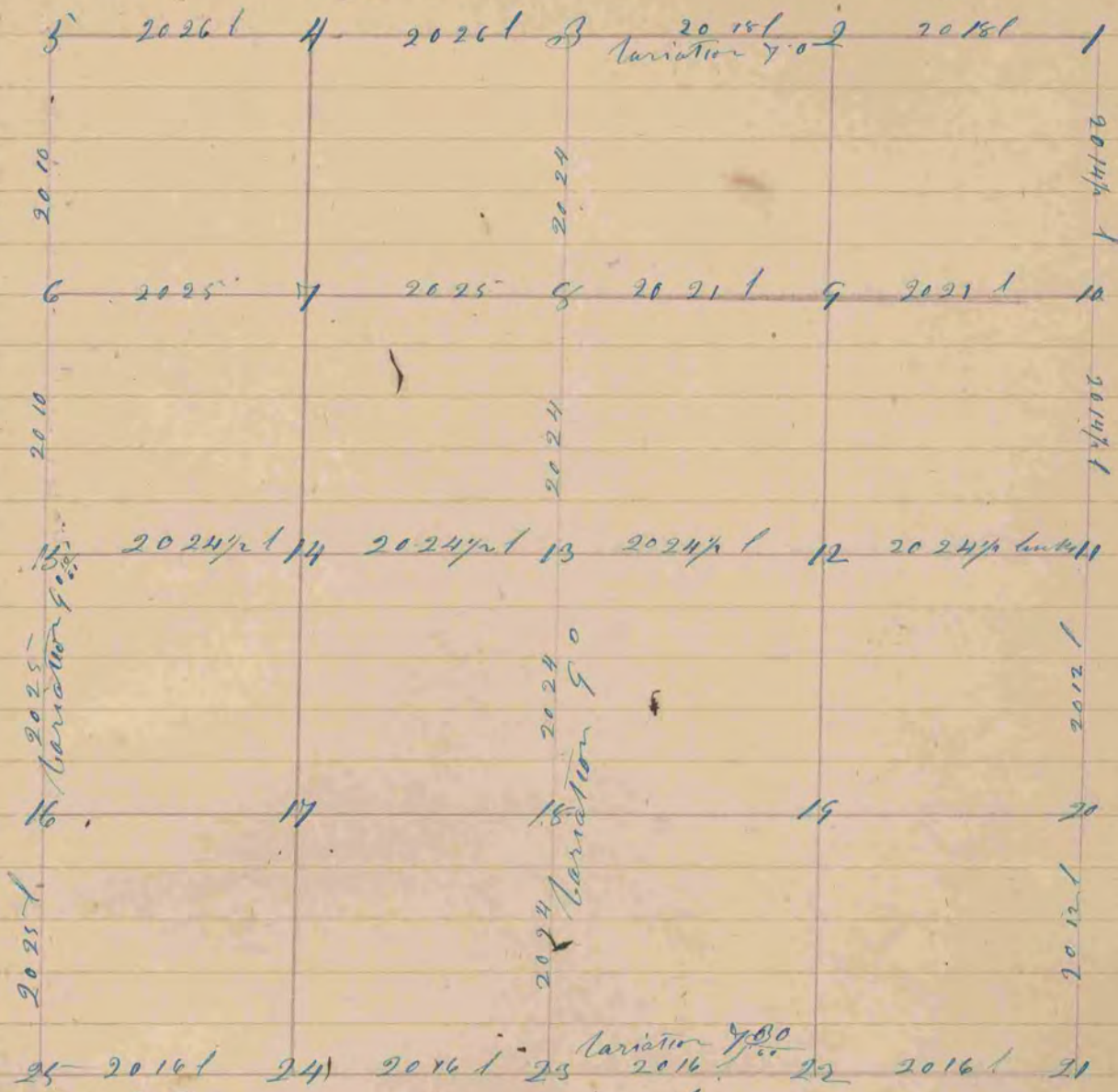

- Fig. 13 W O 36 N 13 W 39 variation 9
7 S O 12 N 68 E 35 links
8 4 S 4 W 131
8 2 S 32 E 68
14 N 70 E 170 variation 9
4 W O 36 S 24 E 92
20 S O 14 N 22 W 37 variation 9
25 Field notes incorrect
16 S O 16 N 74 W 166 links
2 20 S 39 W 135
12 20 N 54 E 47
20 S 47 W no distance neglected to put it down
22 16 N 33 W 93
20 field notes to short by 32 links

Magnolia

The above Survey was made on the 22 & 23 of April March 1858
Joseph Church County Surveyor
Hock County Mo.