

A Record & Plat of a Survey made on Sec. 33  
T. 2. R. 12 E.

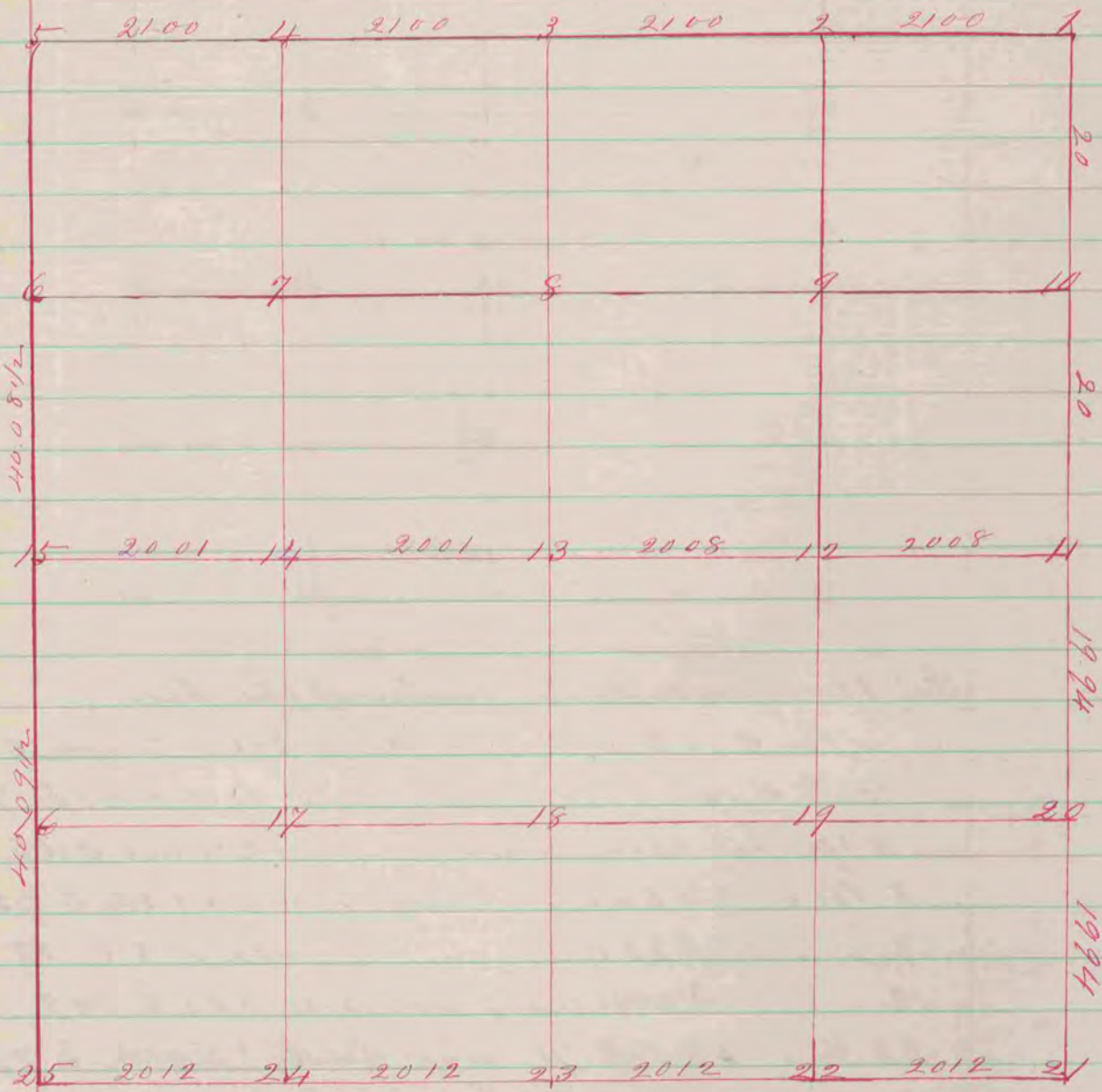

Fig 13 Black O 6 S 12 1/2 W. 75 lks.

" 5 Br. O 16 N. 19 1/2 E 152 "

" W. O. 20 N 70 W 204 "

" 15 Bl. O. N. 34 1/2 E 103 "

" " " S. 10 1/2 E 109 "

8 Stake no trees

23 "

The above Survey was made April 7. 1855  
by Joseph Church Co. Surveyor

(Recorded in Vol I page 30)