

A Record and Plat of a survey of a Road running along the north line of Section 15 in Township No 3 North of Range No. 12 East of the Principal Meridian. Said Road is one chain wide lying 50 links on either side of said sec. line for the courses of said

Also a Record & Plat of Road Running

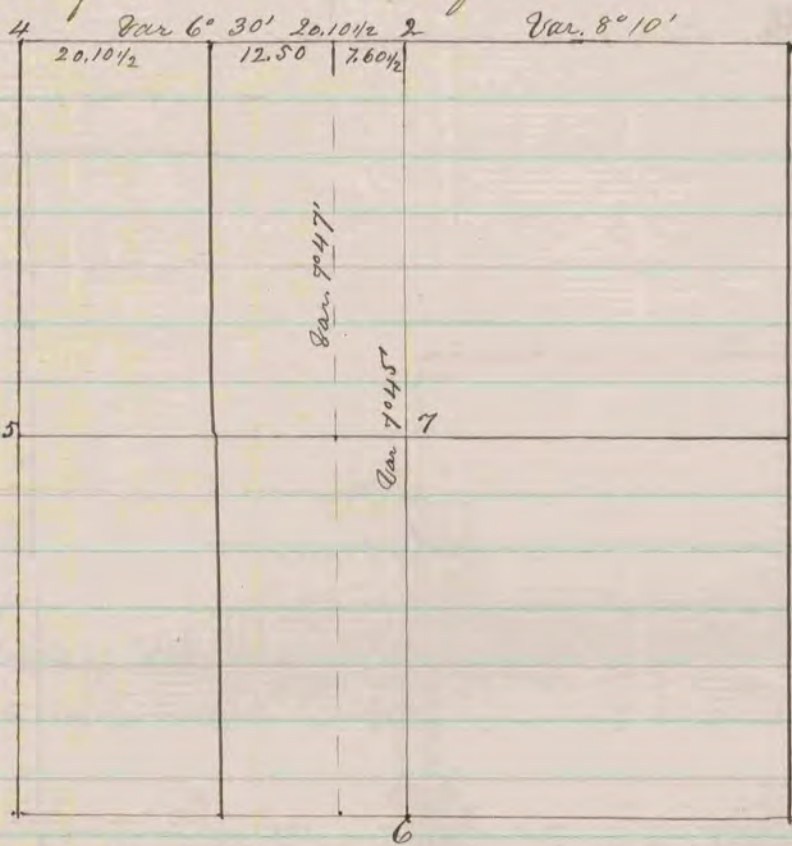

- Fig. 1 Old witness trees cut down took new ones Pl. Plat 4 71 2 25 71 36 Var. 8° 10' Surrounded post by 5 small hard heads
- " 2 Put in post by old witness trees, surrounded post by 4 h heads
- " 3 Found post which was correct with stone South
- " 4 Put in post by old witness trees
- " 5 Old witness trees disagreed, put in post by averaging error surrounded post by 4 hard heads
- " 6 Put by old witness trees
- " 7 it being only necessary to run the N & S line through the centre of the Section for the work under consideration did not put in post at centre of Section

Janesville

Surveyed April 21st & 22nd 1859

by Edward Ringer

County Surveyor of Rock Co.

Wis.