

For Dec. line see Sec. 9, T. 3 R. 10 E.
 Set sawed W. stake & large h.h. around
 Found stem set on Sec. 9

Record & Plat of a Survey made Dec. 11 1863 on Sec. 4 T. 3 R. 10 E. by S. D. Locke Co. Surveyor - Magnolia.

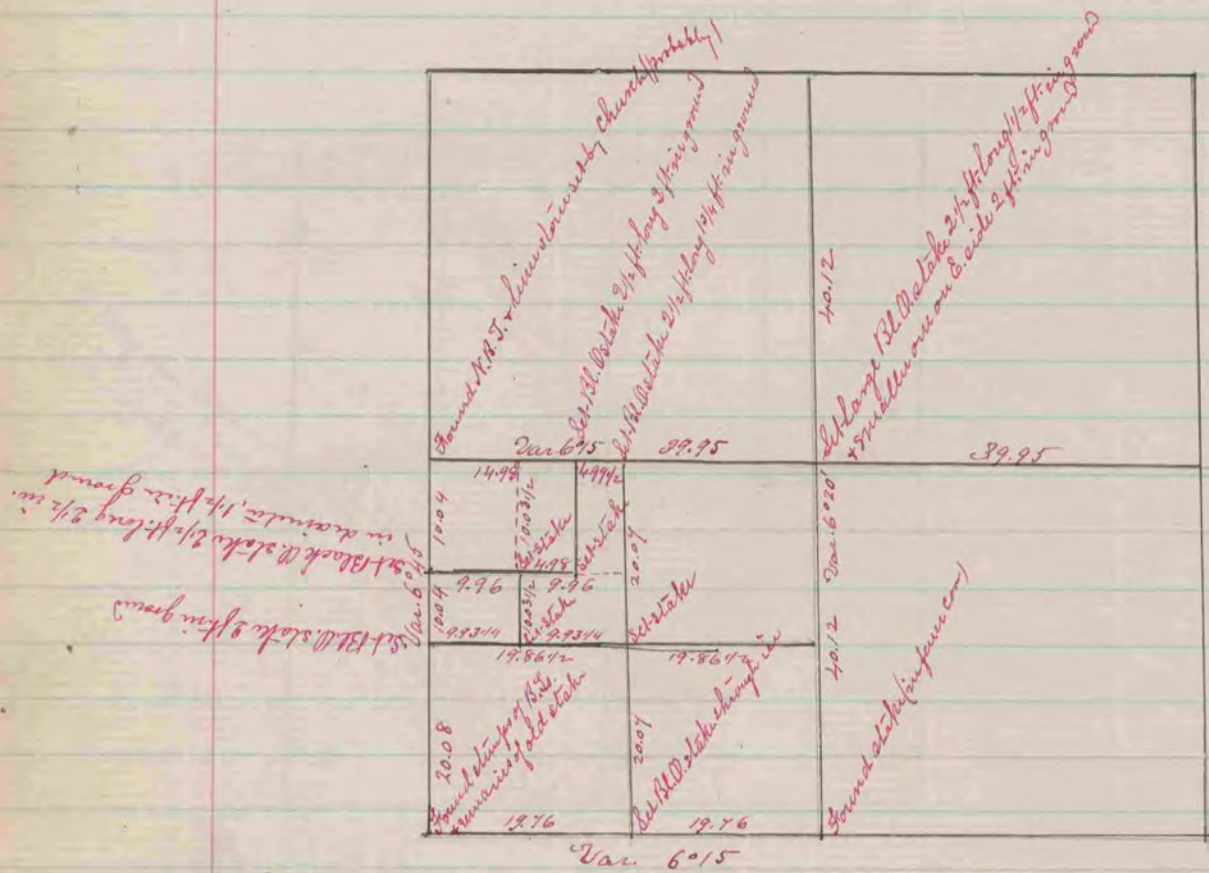

Record & Plat of a survey made Jan. 28, 1864 on Sec. 10, T. 3 R. 11 E. by S. D. Locke Co. Surveyor Physicist

COUNTY SURVEYOR
 RECORD 1859-1906