

Paper weight-110# (minimum)

Black nonfading ink required

U.S. PUBLIC LAND SURVEY MONUMENT RECORD

For Public Land Survey Corners In:

WI ADMINISTRATIVE CODE A-E 7.08 REQUIREMENT

T. 4 N. R. 10 E. 4th P.M.

REV 10/23/2004

USMONREC.DWG

CORNER CODE INDEX

1	2	3	4	5	6	7	8	9	10	11	12	13	14	15	16	17	18	19	20	21	22	23	24	25	
A																									A
B																									B
C	6																								C
D																									D
E																									E
F																									F
G	7																								G
H																									H
J																									J
K	18																								K
L																									L
M																									M
N																									N
O																									O
P	19																								P
Q																									Q
R																									R
S																									S
T																									T
U																									U
V																									V
W																									W
X																									X
Y																									Y
Z																									Z

UNION TWP
ROCK COUNTY WI

IF AVAILABLE
ROCK COUNTY COORDINATES PREFERRED

North _____ Elev. _____

East _____

Hor. Datum _____ Vert. Datum _____

LATITUDE _____ ELLIPS. HT. _____

LONGITUDE _____

NAD83(91) _____ NETWORK ADJ. YR 2010

GPS (X) _____ TRAVERSE (X) X

BASED ON THE FOLLOWING CONTROL:

PLACE MONUMENT SYMBOL AT PROPER LOCATION ON ABOVE INDEX

CORNER MONUMENT

WITNESS MONUMENT

(a) BEARINGS ARE BASED ON: ROCK COUNTY PROJECTION

FIELD BOOK _____ PAGE # _____

OR OBSERVATION SHEET _____

SHEET 1 OF 3

SHOW A PLAN VIEW DRAWING DEPICTING THE CORNER MONUMENT AND SURROUNDING PHYSICAL FEATURES, INCLUDING THE EXCAVATION AREA AND DEPTH.

PLANNING & ZONING COMMITTEE ADOPTED THIS FORM ON 12/2/1982

CORNER CODE X-9(1)

UN616 E1/4CORSEC32

(B) Describe any record evidence, monument evidence, occupational evidence, testimonial evidence or any other material evidence you considered, and whether the monument was found or placed.

- 1833 HARRISON T4N R10E NORTH BET SECS 32 & 33
528.0 ENTER TIMBER
2640.00 QUARTER SEC COR. {W.O. 14 N80E 68.64'; W.O. 24 S70W 91.08' WD 14 & WD 24} MARKED
3300 ENTER MARSH CRS E & W
5280.00 LEAVE IT AND SET COR TO SECS 28, 29, 22, & 33 {BURR O 14 N18E 48.84'; BURR O 12" N54W 51.48'; BURR O 12" S80W 66.00'; BURR O 12" S20E 13.86' LAND 1ST 1/2 MILE ROLLING 2ND RATE WITH BURR & W.O. TIMBER UNDERGROWTH SCRUBS GRASS & WEEDS.
- 1867 LOCKE VOL 1 PG 302 & #5241 FD STUMP OF SOUTH BT & OLD STAKE. SET BR OAK STATE WITH HH ON N & S & L LIMESTONE ON E & W. VAR 7-30 2637.36 TO CENTER OF SEC 32.
- 1870 RUGER AUG REMON-81 NORTH ON WEST LINE OF SW 1/4 SEC 33 ON A VAR 6-45 OFFSET WEST 12.21' AT 2655.18 INTERSECTED QUARTER LINE 11.22' WEST OF QUARTER CORNER. FOUND OLD STAKE SURROUNDED BY HARD HEAD STONES AT CORNER. ALSO FOUND STUMP OF WEST BEARING TREE AND WHERE STUMP OF EAST BEARING TREE HAD BEEN DUG UP. COR VAR 6-46
NORTH ON WEST LINE OF NW 1/4 SEC 33 ON A VAR 7-07 OFFSET WEST 16.5' WEST 4.62' OFFSET WEST 38.61' AT
2658.48 INTERSECTED NORTH BOUNDARY LINE 44.88' WEST OF CORNER. COR VAR 7-27'
- 1900 BROWN VOL 2 PG 518 CALLS FOR MONUMENT & USED IT TO SUBDIVIDE SEC 32. 2644.29 TO CENTER OF SEC 32
- 1906 KERCH VOL 3 PG 36 FD MONUMENT & USED IT TO SUBDIVIDE SEC 33. 2615.5 TO GAS PIPE @ CENTER OF SEC 33
- 1963 COMBS VOL 4 PG 150 #6982 & 6983 FD CUT STONE & REFERENCED SAME.
- 1963 BATTERMAN VOL 4 PG 150 FD CUT STONE & REFERENCED SAME.
- 1977 LEE CSM VOL 7 PG 72 PK EAST 2616.24 TO PK @ CENTER OF SEC 33
- 1978 LEE CSM VOL 7 PG 305 CI 2616.29 TO CI @ CENTER OF SEC 33.
- 1984 [BARNES] VOL 6 PG 329 THE BELOIT COUNTY SURVEYOR'S RECORD AND THE JANESVILLE COUNTY SURVEYORS' RECORD VOL 4 PG 149 & 150 RESPECTIVELY, HAVE DIFFERENCES. THE SOUTHEAST MEASUREMENT IS RECORDED AS 48.29' IN THE BELOIT SET AND 48.99' IN THE JANESVILLE SET.
- 1984 COMBS CSM VOL 12 PG 1 ALUM @ W 1/4 COR SEC 33 & E 1/4 COR SEC 33.
- 1989 SCHROEDER CSM VOL 13 PG 453 STATES NOTHING ABOUT MON. USED FOR LINE
- 1989 COMBS CSM VOL 13 PG 462 ALUM @ W 1/4 COR & E 1/4 COR SEC 33.
- 1991 SCHROEDER CSM VO 15 PG 76 STATES NOTHING ABOUT MON.
- 1991 BARNES X-9 FD PK 0.3' DEEP & 1' NORTH OF THE CENTER OF THE PAVEMENT. IT WAS IN HARMONY WITH FD REFERENCE PIPES.

SEAL
Donald Barnes
EMBOSSED

SHEET 1 OF 2

4/09/2012

CORNER CODE X-9(1)

UN616 E1/4CORSEC32
1991 BARNES VOL 6 PG 421 FD PK 80-36-18W 2655.18 TO LS @
SW COR SEC 33 & S89-11-52E 2616.27 TO PK/TIES @
CENTER OF SEC 33
2000 KARNS GSM VOL 24 PG 35 ROCK COUNTY SEC. COR.
5264.77 TO E 1/4 COR SEC 33
2002 COMBS CSM VOL25 PG 46 FD IRON PIN 5267.80 TO ALUM @
W 1/4 COR SEC 32
2005 COMBS CSM25 PG 54 FD IRON PIN 2616.26 TO PK @
CENTER OF SEC 33

FD 1/2 PIN 4-5" DEEP & REFERENCE MONUMENTS. THE SE
REFERENCE PIPE WAS DISTURBED.

C) *Was the corner restored through acceptance of (1) an obliterated evidence location, or, (2) a found perpetuated location?*

ACCEPTED PERPETUATED BUT LIMESTONE REFERENCED BY
BATTERMAN. ACCEPTED THE FD PIN AS PERPETUATING THE L.S. I
DID NOT FIND A RECORD OF THE PIN. SINCE IT WAS DEEPER THAN
THE 1991 FD PK AND WAS IN HARMONY WITH THE TIES, I ACCEPTED
IT.

D) *Describe any material discrepancy between the location of the corner as restored or reestablished and the location of that corner as previously restored or reestablished by distance and direction. Show the discrepancy on the plan view drawing under (a), above. Show the distances between the corner as previously restored or reestablished and (1) the corner as restored or reestablished, and (2) to at least 4 of the witness monuments shown on the drawing in (a), above.*

NONE

(E) *Was the corner reestablished through lost corner proportionate methods? If so, show the method, including the directions and distances to other public land survey corners used as evidence or used for proportioning the corner location.*

NO

I, **Donald Barnes**, hereby certify that the corner location as identified by the corner code index was determined by me under my direction and control and that this U.S. Public Land Survey Monument Record is correct and complete to the best of my knowledge and belief.

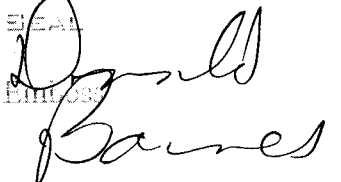
H/09/2012

SHEET 2 OF 3

CORNER CODE X-9(1)

A.E. 7.08 REQUIREMENT

Ronald Barnes
4/09/2012

OBSERVATION SHEET #616

- 1991 BARNES FB #2 PG 29
- 1991 BARNES X-9
- 1963 BATTERMAN JANESVILLE SET VOL 4 PG 150
- 1963 BATTERMAN BELDIT SET VOL 4 PG 149
- 1963 COMBS #6982 & 6983

◇ 1991 FD PK .3' DEEP
FD 1/2 PIN
6" DEEP

FIELD BOOK #2 PG 29
OLD TIES VOL 4 PG 150
TIES ON NORTH SIDE OF RD
WERE PLOWED OUT.

E 1/4 COR
SEC 32
UNION TWP
T4N R10E REC PK

SHEET 3 OF 3

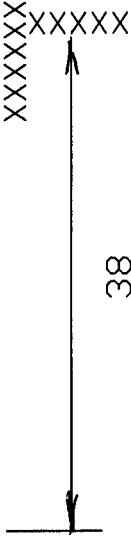
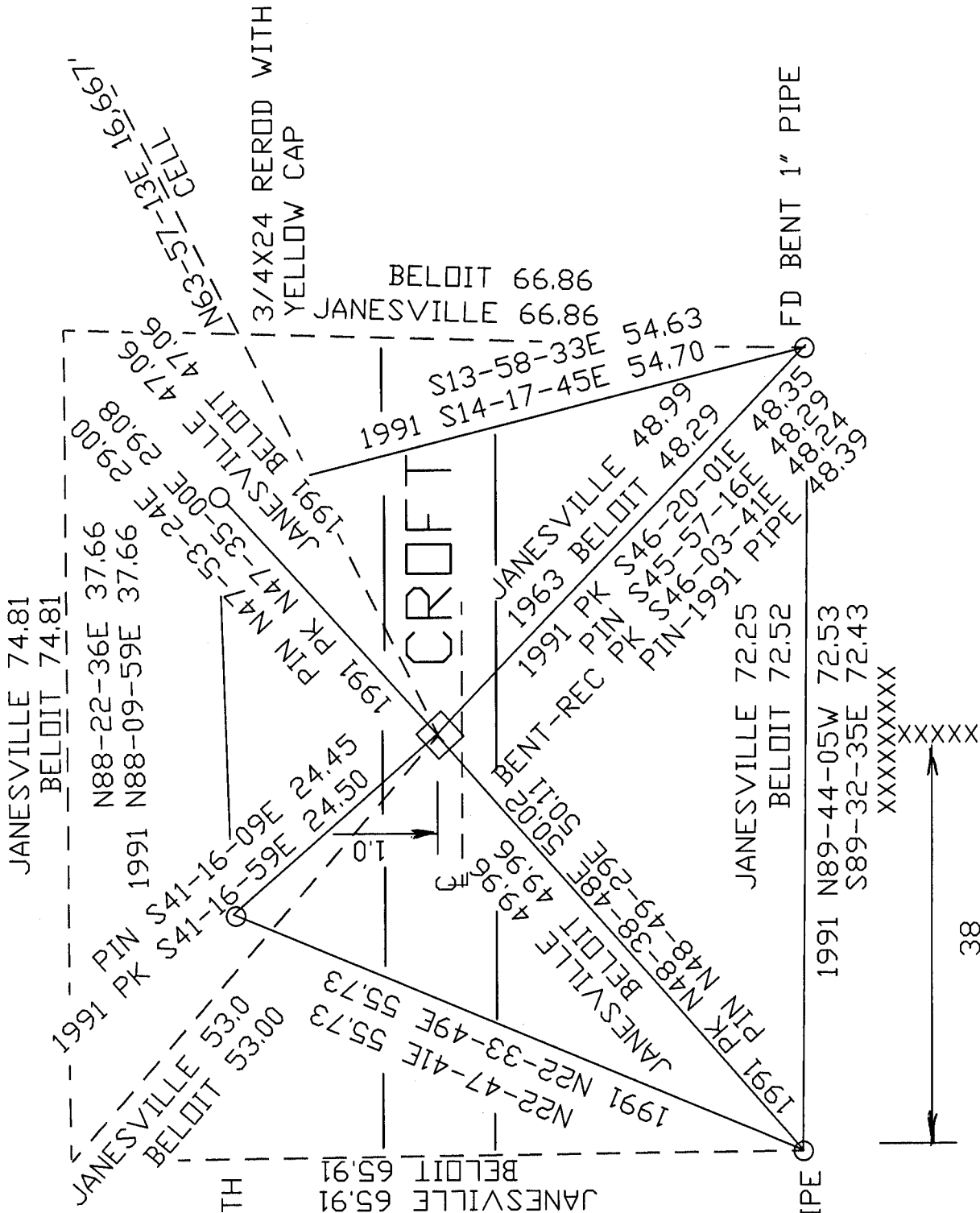
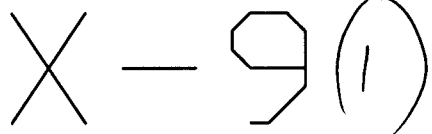

38