

U.S. PUBLIC LAND SURVEY MONUMENT RECORD

For Public Land Survey Corners in the

T. 2 N., R. 12 E

CORNER CODE INDEX

| | | | | | | | | | | | | | | | | | | | | | | | | | |
|---|----|----|----|----|----|----|----|----|----|----|----|----|----|----|----|----|----|----|----|----|----|----|----|----|----|
| | 1 | 2 | 3 | 4 | 5 | 6 | 7 | 8 | 9 | 10 | 11 | 12 | 13 | 14 | 15 | 16 | 17 | 18 | 19 | 20 | 21 | 22 | 23 | 24 | 25 |
| A | | | | | | | | | | | | | | | | | | | | | | | | | |
| B | 6 | | | | | | | | | | | | | | | | | | | | | | | | |
| C | | 5 | | | | | | | | | | | | | | | | | | | | | | | |
| D | | | 4 | | | | | | | | | | | | | | | | | | | | | | |
| E | | | | 3 | | | | | | | | | | | | | | | | | | | | | |
| F | | | | | 2 | | | | | | | | | | | | | | | | | | | | |
| G | | | | | | | | | | | | | | | | | | | | | | | | | |
| H | 7 | | | | | | | | | | | | | | | | | | | | | | | | |
| I | | 8 | | | | | | | | | | | | | | | | | | | | | | | |
| J | | | 9 | | | | | | | | | | | | | | | | | | | | | | |
| K | | | | 10 | | | | | | | | | | | | | | | | | | | | | |
| L | | | | | 11 | | | | | | | | | | | | | | | | | | | | |
| M | | | | | | 12 | | | | | | | | | | | | | | | | | | | |
| N | 13 | | | | | | | | | | | | | | | | | | | | | | | | |
| O | | 14 | | | | | | | | | | | | | | | | | | | | | | | |
| P | | | 15 | | | | | | | | | | | | | | | | | | | | | | |
| Q | | | | 16 | | | | | | | | | | | | | | | | | | | | | |
| R | | | | | 17 | | | | | | | | | | | | | | | | | | | | |
| S | | | | | | 18 | | | | | | | | | | | | | | | | | | | |
| T | | | | | | | 19 | | | | | | | | | | | | | | | | | | |
| U | | | | | | | | 20 | | | | | | | | | | | | | | | | | |
| V | | | | | | | | | 21 | | | | | | | | | | | | | | | | |
| W | | | | | | | | | | 22 | | | | | | | | | | | | | | | |
| X | | | | | | | | | | | 23 | | | | | | | | | | | | | | |
| Y | | | | | | | | | | | | 24 | | | | | | | | | | | | | |
| Z | | | | | | | | | | | | | 25 | | | | | | | | | | | | |
| | | | | | | | | | | | | | | 26 | | | | | | | | | | | |
| | | | | | | | | | | | | | | | 27 | | | | | | | | | | |
| | | | | | | | | | | | | | | | | 28 | | | | | | | | | |
| | | | | | | | | | | | | | | | | | 29 | | | | | | | | |
| | | | | | | | | | | | | | | | | | | 30 | | | | | | | |
| | | | | | | | | | | | | | | | | | | | 31 | | | | | | |
| | | | | | | | | | | | | | | | | | | | | 32 | | | | | |
| | | | | | | | | | | | | | | | | | | | | | 33 | | | | |
| | | | | | | | | | | | | | | | | | | | | | | 34 | | | |
| | | | | | | | | | | | | | | | | | | | | | | | 35 | | |
| | | | | | | | | | | | | | | | | | | | | | | | | 36 | |

PLACE MONUMENT SYMBOL (◆) AT PROPER LOCATION ON ABOVE INDEX

EXAMPLE

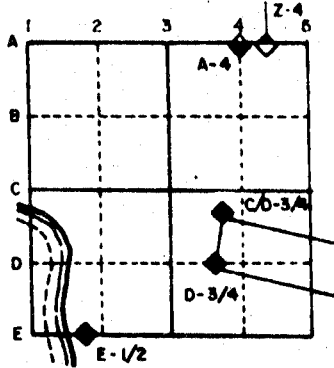

ROCK TWP
ROCK COUNTY WI

IF AVAILABLE
STATE PLANE COORDINATES

North (Y) _____ Eleve. (Z) _____
 East (X) _____ Zone _____
 Hor. Datum _____ Vert. Datum _____

(a.)

◆ CORNER MONUMENT
1/2 RE ROD

○ WITNESS MONUMENT
1/2 X 24 RE ROD

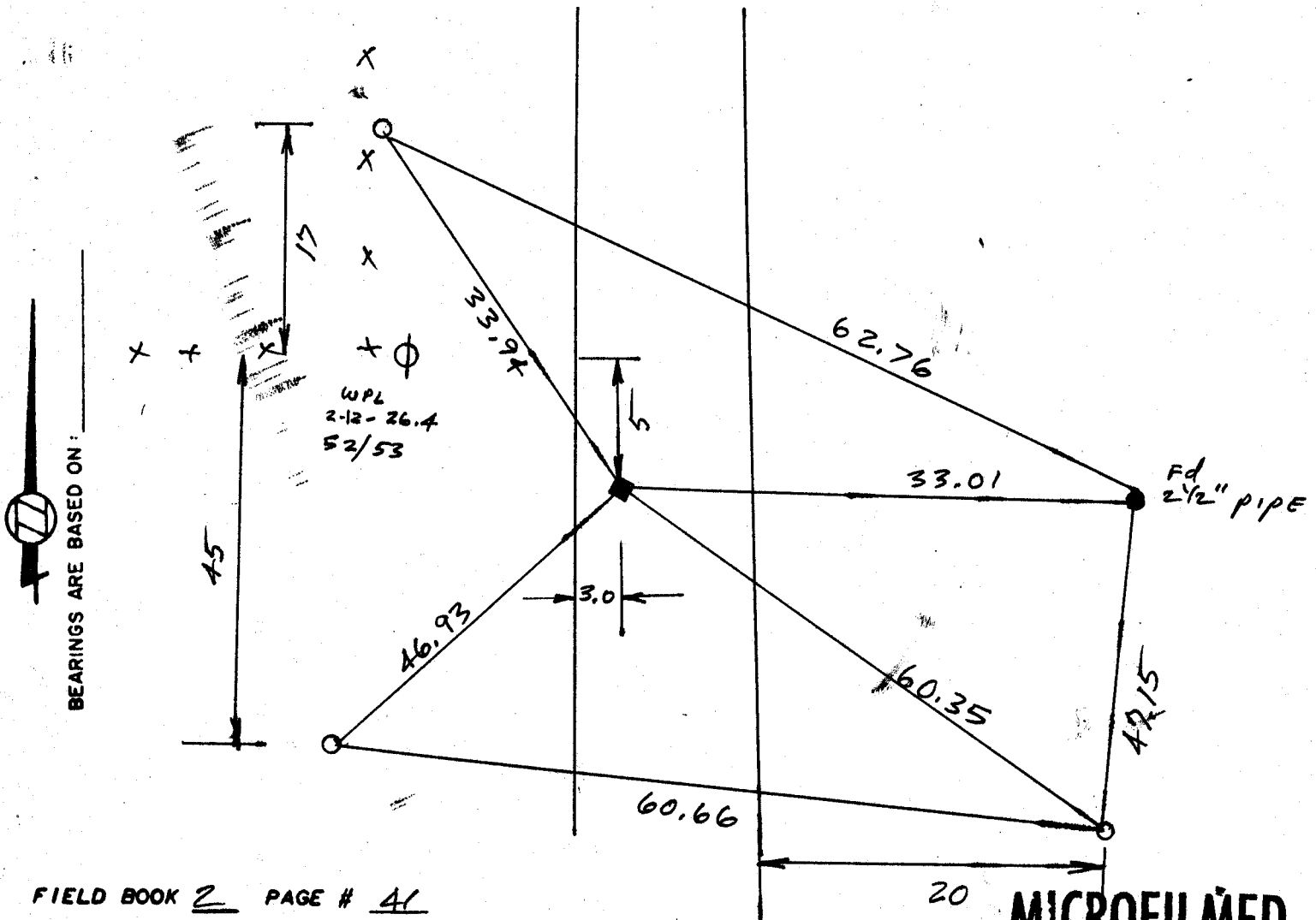

MICROFILMED

SHOW A PLAN VIEW DRAWING DEPICTING THE CORNER MONUMENT AND SURROUNDING PHYSICAL FEATURES, INCLUDING THE EXCAVATION AREA AND DEPTH. THE CORNER MONUMENT SHALL HAVE THE FOLLOWING CHARACTERISTICS: 1) HAVE AT LEAST TWO PREDETERMINED BREAK-OFF POINTS. 2) IF BROKEN, LEAVE A PERMANENTLY MAGNETIZED REMNANT AT THE ORIGINAL POINT. 3) MUST BE EXTENDABLE. 4) THE CAP IS INSCRIBED: ROCK COUNTY SURVEY MONUMENT - PENALTY FOR DISTURBING MARKER. 5) OR AN EXISTING CUT LIMESTONE. AN IRON PIPE 1/2" x 4'0" (MINIMUM) MAY BE USED IN AREAS WHERE GROUND WATER IS WITHIN ONE FOOT OF THE SURFACE. IF THE CORNER IS OCCUPIED BY AN IMPROVEMENT (MANHOLE, BURIED CABLE, ETC.) ANY DURABLE, DISTINCT MONUMENT MAY BE USED. CORNERS SHALL BE REFERENCED WITH AT LEAST 4 DURABLE WITNESS MONUMENTS. WITNESS MONUMENTS SHALL BE MADE OF CONCRETE, NATURAL STONE, IRON OR OTHER EQUALLY DURABLE MATERIAL, EXCEPT WOOD. DESCRIBE THE CORNER AND THE WITNESS MONUMENTS.

CORNER CODE: T 21

(b.) Describe any record evidence, monument evidence, occupational evidence, testimonial evidence or any other material evidence you considered, and whether the monument was found or placed.

SEE SHEET 2

(c.) Was the corner restored through acceptance of (1) an obliterated evidence location, or, (2) a found perpetuated location?

ACCEPTED FOUND PERPETUATED LOCATION.

(d.) Describe any material discrepancy between the location of the corner as restored or reestablished and the location of that corner as previously restored or reestablished by distance and direction. Show the discrepancy on the plan view drawing under (d), above. Show the distances between the corner as previously restored or reestablished and (1) the corner as restored or reestablished, and (2) to at least 4 of the witness monuments shown on the drawing in (e), above.

(e.) Was the corner reestablished through lost corner proportionate methods? If so, show the method, including the directions and distances to other public land survey corners used as evidence or used for proportioning in determining the corner location.

I, Donald Barnes, hereby certify that the corner points as identified by the corner code index were, in a field survey on March 13 1989, established, re-established, monumented, re-monumented, recovered or restored as expressed below and in conformance with the regulations and rules as required in the current manual of survey instructions of the United States Department of Interior, Bureau of Land Management.

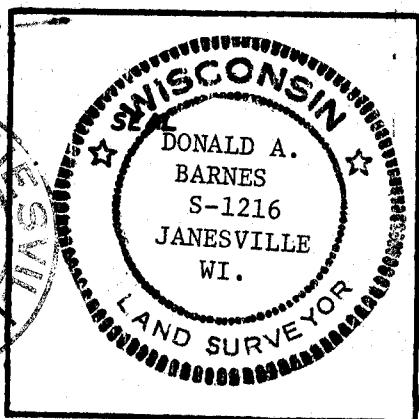
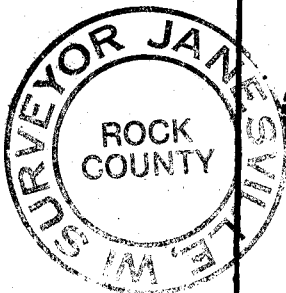

COUNTY SURVEYOR FILING DATA

Date of Computer Entry _____

Date Received _____

Date Microfilmed _____

Treasurer's Receipt No. _____

Number of Included Sheets 1

AFFIX YOUR LAND SURVEYOR SEAL. CORNER CODE T 21

(b) Describe any record evidence, monument evidence, occupational evidence, testimonial evidence or any other material evidence you considered, and whether the monument was found or placed.

- 1873 LEE VOL 2 PG 95 FOUND REMAINS OF OLD STAKE ON LINE WITH FENCE WEST.
- 1882 LEE VOL 2 PG 370 FOUND CORNER SET BY -(?).
- 1960 SHIMEALL PLAT OF SURVEY S89-28E 2646.07 TO STONE AT EAST QUARTER CORNER OF SECTION 26.
- 1961 BATTERMAN PLAT OF SURVEY FOUND 5/8" PIN
- 1963 THOM PLAT OF SURVEY FOUND 5/8" PIN
- 19?? SHIMEALL PLAT OF SURVEY. 7 X 10 X 12 STONE AT EAST QUARTER CORNER OF SECTION 26 IS 2.63 FEET EAST OF WEST EDGE OF PAVEMENT & 4.8 SOUTH OF FENCE TO WEST. SET NAILS IN BLACKTOP 1' WEST & 1 SOUTH. SHOWS A PROPERTY CORNER N89-28W 1887.4
- 1964 LEE PLAT OF SURVEY FOUND R/R. USED TO PLACE MONUMENTS ALONG THE E/W QUARTER LINE OF SECTION 26.
- 1965 SHIMEALL PLAT OF SURVEY REFERS TO A PROPERTY CORNER AS 1887.40' N89-28W OF STONE AT EAST QUARTER CORNER OF SECTION 26.
- 1986 COMBS PLAT OF SURVEY DISTANCE OF 1521.4 N89-28W TO E 1/4 CORNER SEC 26 (STONE MONUMENT).

I found a 1/2" re-rod 0.3' deep.

