

# U.S. PUBLIC LAND SURVEY MONUMENT RECORD

For Public Land Survey Corners in the  
T. 2 N., R. 12 E.

## CORNER CODE INDEX

	1	2	3	4	5	6	7	8	9	10	11	12	13	14	15	16	17	18	19	20	21	22	23	24	25
A																									
B																									
C	6																								
D		5																							
E			4																						
F				3																					
G					2																				
H																									
I																									
J																									
K																									
L																									
M																									
N																									
O																									
P																									
Q																									
R																									
S																									
T																									
U																									
V																									
W																									
X																									
Y																									
Z																									

### EXAMPLE

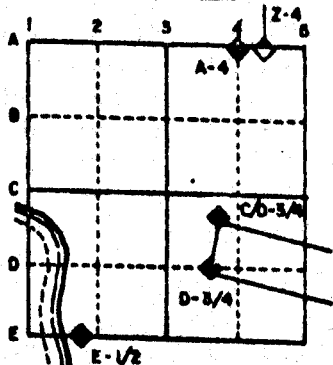

ROCK TWP  
ROCK COUNTY WI

IF AVAILABLE  
STATE PLANE COORDINATES

NAD North (Y) 238,298.74 Eleve. (2) 839.9  
27 East (X) 2,265,901.68 Zone \_\_\_\_\_

Hor. Datum \_\_\_\_\_ Vert. Datum \_\_\_\_\_

PLACE MONUMENT SYMBOL (◆) AT PROPER LOCATION ON ABOVE INDEX  
LA PRAIRIE PROJECT  
238,299.38  
2,265,802.62

- ◆ CORNER MONUMENT
  - WITNESS MONUMENT
- DISK IN MONUMENT  
Box

BEARINGS ARE BASED ON:

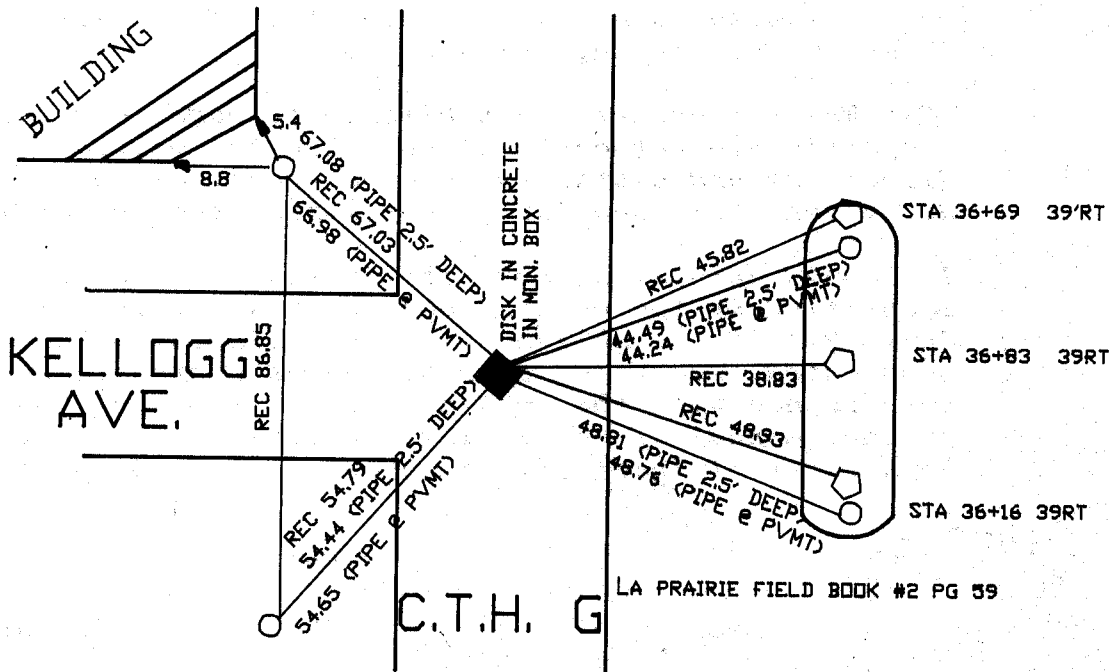

ALUM. DISK IN CONCRETE  
PLACED PER PROJ# 5990-02-22  
ALSO MEASUREMENTS ARE BY  
THE PROJECT ENGINEER.

# MICROFILMED

SHEET \_\_\_ OF \_\_\_

CORNER CODE: G25

(B) Describe any record evidence, monument evidence, occupational evidence, testimonial evidence or any other material evidence you considered, and whether the monument was found or placed.

- 1835 MULLETT ORIGINAL GOVERNMENT SURVEYOR. FIELD NOTES - SET QUARTER SECTION POST IN MOUND. PIT BEARING SOUTH 1.98'. MEASURED 2640' TO THE NE AND SE CORNERS OF SECTION 12.
- 1865 LOCKE VOL 1 PG 242 SHOWS A DISTANCE OF 2661.80 TO THE CENTER OF SECTION 7 LA PRAIRIE TOWNSHIP.
- 1870 RUGER VOL 2 PG 23 FOUND OLD STAKE. SET LIMESTONE.
- 1871 RUGER LA PRAIRIE TOWNSHIP REMONUMENTATION. FIELD NOTES - SOUTH ON WEST LINE OF NW 1/4 OF SEC 7 ON A VAR 7-00' AT 2649.57 INTERSECTED 1/4 LINE AT 1/4 CORNER FOUND STAKE SURROUNDED BY HARDHEAD STONES AT CORNER. MEASURED 2654.52 TO THE SE CORNER OF SECTION 12. PLACED CUT LIMESTONE.
- 1884 RUGER VOL 2 PG 376 SHOWS A DISTANCE OF 391.71 TO THE R/R TRACKS THAT ARE NORTH OF THE CORNER. ALSO SHOWS 1300.86 TO THE E 1/16TH CORNER OF THE NE 1/4 OF SECTION 12.
- 1936 SUNNY VOL 3 PG 294 FOUND LIMESTONE MONUMENT 10" LOW. SET 1 1/2"X10" IRON PIPE WITH CAP ON TOP. REFERENCED SAME.
- 1936 SUNNY VOL 3 PG 318 FOUND STONE MONUMENT.
- 1937 SUNNY VOL 3 PG 329 FOUND 2" PIPE.
- 1938 SUNNY VOL 3 PG 383 SHOWS A DISTANCE OF 2651.60 TO THE NW CORNER OF SECTION 7 LA PRAIRIE TOWNSHIP.
- 1960 BATTERMAN JR. VOL 4 PG 60 SHOWS REFERENCES.
- 1962 BATTERMAN VOL 4 PG 122 SHOWS 2649.98 TO THE NE CORNER OF SECTION 12.

FOUND DISK IN CONCRETE IN ROUND MONUMENT BOX THAT DOT PLACED AFTER 1986 ROAD CONSTRUCTION.

C) Was the corner restored through acceptance of (1) an obliterated evidence location, or, (2) a found perpetuated location?

ACCEPTED FOUND MONUMENT.

D) Describe any material discrepancy between the location of the corner as restored or reestablished and the location of that corner as previously restored or reestablished by distance and direction. Show the discrepancy on the plan view drawing under (a), above. Show the distances between the corner as previously restored or reestablished and (1) the corner as restored or reestablished, and (2) to at least 4 of the witness monuments shown on the drawing in (a), above.

(E) Was the corner reestablished through lost corner proportionate methods? If so, show the method, including the directions and distances to other public land survey corners used as evidence or used for proportioning the corner location.

I, Donald Barnes, hereby certify that the corner points as identified by the corner code index were, in a field survey on, July 19, 1990, established, re-established, monumented, re-monumented, recovered or restored as expressed below and in conformance with the regulations and rules as required in the current manual of survey instructions of the United States Department of Interior, Bureau of Land Management.

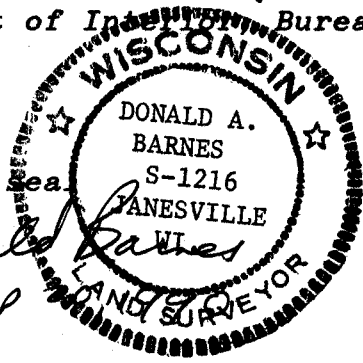
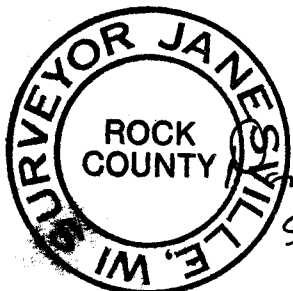

COUNTY SURVEYOR FILING DATA

Date of computer entry \_\_\_\_\_

Date microfilmed \_\_\_\_\_

Number of included sheets \_\_\_\_\_

CORNER CODE

AFFIX YOUR LAND SURVEYOR SEAL

625