

PUBLIC LAND SURVEY MONUMENT RECORD

For Public Land Survey Corners in the
T. 1 N., R. 10 E.

CORNER CODE INDEX

	1	2	3	4	5	6	7	8	9	10	11	12	13	14	15	16	17	18	19	20	21	22	23	24	25
A																									
B																									
C	6																								
D																									
E																									
F																									
G	7																								
H																									
I																									
J																									
K																									
L	16																								
M																									
N																									
O																									
P																									
Q	19																								
R																									
S																									
T	30																								
U																									
V																									
W																									
X																									
Y	31																								
Z																									

PLACE MONUMENT SYMBOL (◆) AT PROPER LOCATION ON ABOVE INDEX

EXAMPLE

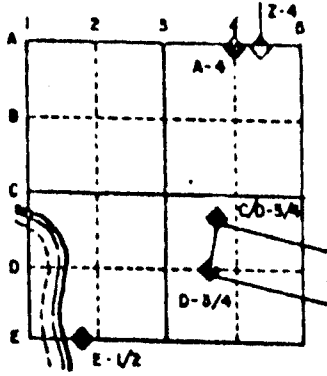

AVON TWP
ROCK COUNTY WI

IF AVAILABLE
STATE PLANE COORDINATES

North (Y) _____ Eleve. (Z) _____
 East (X) _____ Zone _____
 Hor. Datum _____ Vert. Datum _____

◆ CORNER MONUMENT

○ WITNESS MONUMENT

Found concrete monument with Brass cap of record. Monument leaning at approx. 30°. Dug up and straightened monument, keeping base in place. Corner falls in swamp and no reasonable ties are available other than fences shown.

Top of monument is 15" above grade.

SCALE: 1" = 1'

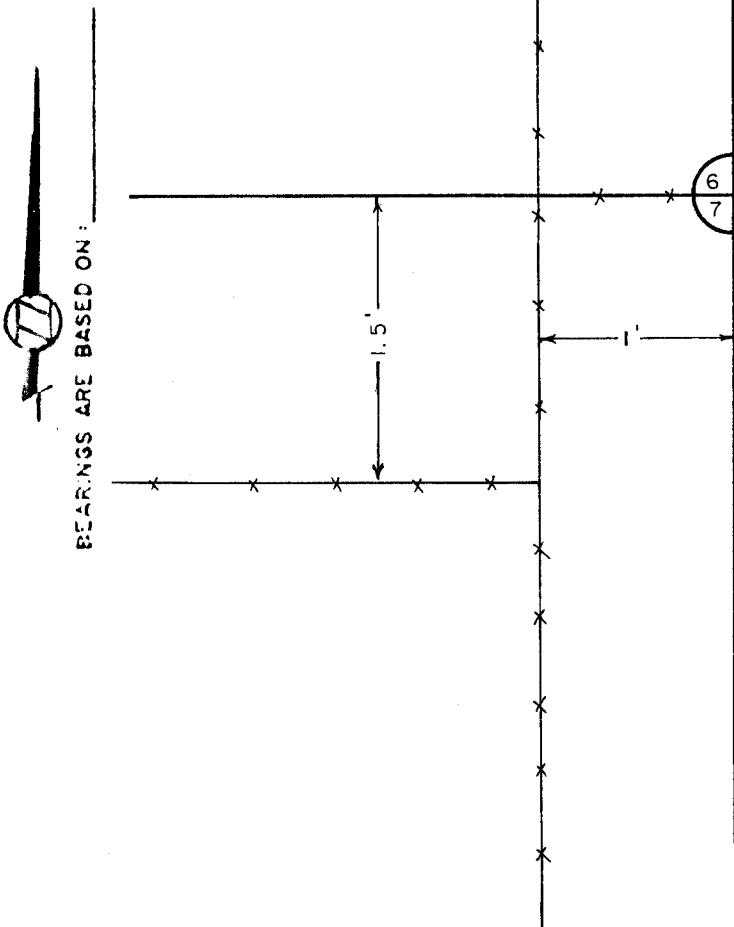

MICROFILMED

NOTE:

Only practical way to tie to this corner if needed, is to traverse into it from nearly due Northwest.

Richard D. Talapczak
 11/27/91

SHEET ___ OF ___

CORNER CODE: E - 05