

U.S. PUBLIC LAND SURVEY MONUMENT RECORD

For Public Land Survey Corners in the

T. 2 N., R. 12 E.

CORNER CODE INDEX

	1	2	3	4	5	6	7	8	9	10	11	12	13	14	15	16	17	18	19	20	21	22	23	24	25
A																									
B																									
C	6																								
D		5																							
E			4																						
F				3																					
G					2																				
H																									
I	7																								
J		8																							
K			9																						
L				10																					
M					11																				
N						12																			
O							13																		
P								14																	
Q									15																
R										16															
S											17														
T												18													
U													19												
V														20											
W															21										
X																22									
Y																	23								
Z																		24							
																			25						
																				26					
																					27				
																						28			
																							29		
																								30	
																									31
																									32
																									33
																									34
																									35
																									36

PLACE MONUMENT SYMBOL (◆) AT PROPER LOCATION ON ABOVE INDEX

EXAMPLE

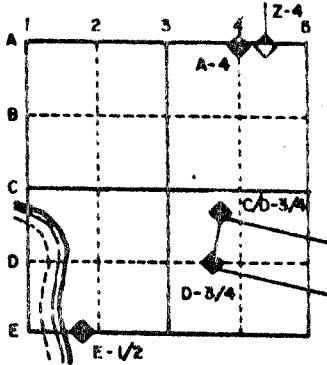

ROCK _____ TWP
ROCK COUNTY WI

IF AVAILABLE
STATE PLANE COORDINATES

North (Y) _____ Eleve. (Z) _____
 East (X) _____ Zone _____
 Hor. Datum _____ Vert. Datum _____

(c.)

◆ CORNER MONUMENT

○ WITNESS MONUMENT

BEARINGS ARE BASED ON:

SEE REVERSE SIDE

SHEET _____ OF _____

CORNER CODE: Z15

FIELD SURVEY NOTES
PRESERVATION OF LANDMARKS
(Pursuant to Section 59.635(7) Wisconsin Statutes)

State Highway Commission of Wisconsin
Form E-D-707-65

COUNTY <i>Rock</i>		
TOWN <i>Town of Rock</i>		
HIGHWAY <i>Townline Road</i>		
SECTION <i>34</i>	TOWNSHIP <i>T 2 N</i>	RANGE <i>R 12 E</i>
TYPE OF LANDMARKS <i>Witness</i>		
① <i>Brass Cap Conc Monument (Type A)</i>		

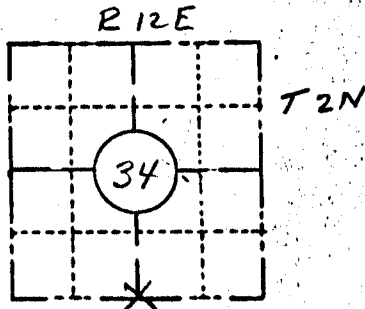

LOCATION SKETCH
(Location of landmark indicated by "x")



This space for copy of field notes or ties to the above described landmarks

Note: All measurements from witness monuments to landmarks were taken to original pins, located in the old pavement, prior to grading operations on or about April 21, 1965.

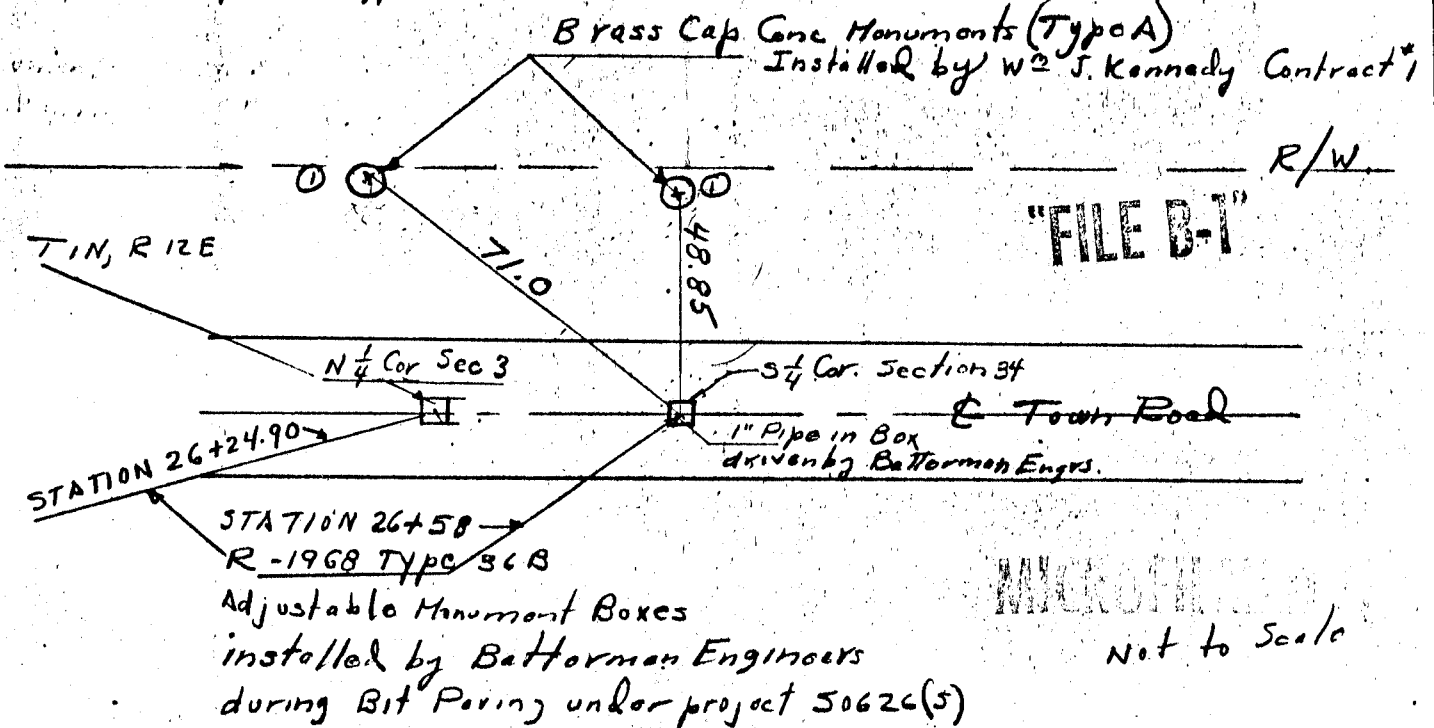

"FILE B-1"

Not to Scale

FILED UNDER PROJECT NUMBER <i>50626(5)</i>			COUNTY CLERK'S OFFICE COUNTY OF <i>DANE</i> WISCONSIN } 55	
SHC DISTRICT OFFICE NUMBER <i>ONE</i>	CITY <i>MADISON</i>	COUNTY <i>DANE</i>	DATE RECEIVED FOR RECORD	DATE COPY SENT TO COUNTY SURVEYOR <i>12/20/65</i>
LOCATED OR ESTABLISHED BY NAME <i>O.I. Koski</i>			SIGNATURE OF COUNTY CLERK	
TITLE <i>Proj. Eng.</i> DATE _____				

PRESERVATION OF LANDMARKS

PAGE 1

Note: All Adjustable Monument Boxes & 1" pipe by Battorman Engrs 1965.
Note: All witness monuments installed under Cont #1 50626(5) - 1965 } Sheet 1-6

SEE COUNTY SURVEYORS RECORD FOR RELATED TIES, PG 169.