

U.S. PUBLIC LAND SURVEY MONUMENT RECORD

For Public Land Survey Corners in the
T. ___ N., R. ___ E.

CORNER CODE INDEX

	1	2	3	4	5	6	7	8	9	10	11	12	13	14	15	16	17	18	19	20	21	22	23	24	25
A																									
B																									
C	6																								
D		5																							
E			4																						
F				3																					
G					2																				
H																									
I																									
J																									
K																									
L																									
M																									
N																									
O																									
P																									
Q																									
R																									
S																									
T																									
U																									
V																									
W																									
X																									
Y																									
Z																									

PLACE MONUMENT SYMBOL (◆) AT PROPER LOCATION ON ABOVE INDEX

EXAMPLE

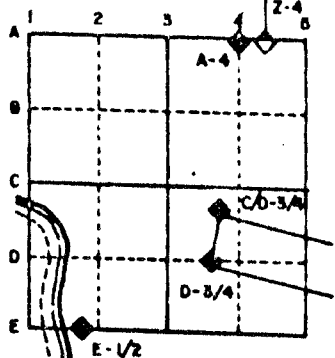

ROCK TWP
ROCK COUNTY WI

IF AVAILABLE
STATE PLANE COORDINATES

North (Y) _____ Eleve. (Z) _____
 East (X) _____ Zone _____
 Hor. Datum _____ Vert. Datum _____

◆ CORNER MONUMENT

○ WITNESS MONUMENT

BEARINGS ARE BASED ON: Township project

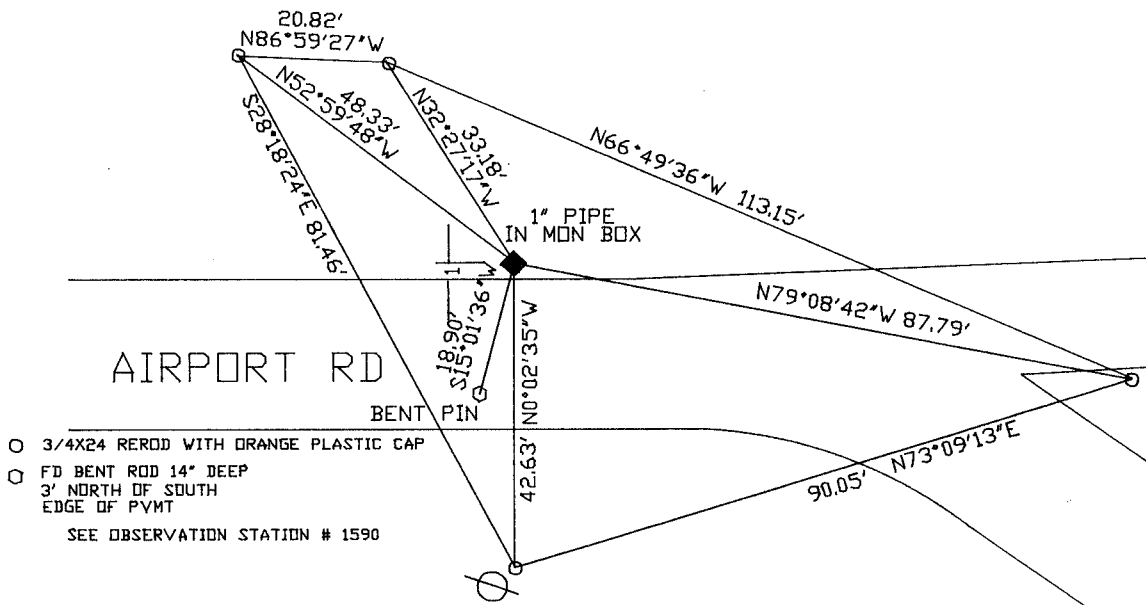

- 3/4X24 REROD WITH ORANGE PLASTIC CAP
 - FD BENT ROD 14" DEEP
3' NORTH OF SOUTH
EDGE OF PVMT
- SEE OBSERVATION STATION # 1590

MICROFILMED

SHEET ___ OF ___

CORNER CODE: R15

(B) Describe any record evidence, monument evidence, occupational evidence, testimonial evidence or any other material evidence you considered, and whether the monument was found or placed.

1836 LYON ORIGINAL GOVERNMENT SURVEYOR. FIELD NOTES - WEST BETWEEN 22 & 27. SET QUARTER SECTION POST. BUR OAK 8 N53 1/2E 53 AND BUR OAK 5 S71E 52. 2629.44 TO ROCK RIVER & SET POST ON LEFT BANK. WHITE OAK 22 S52E 82 AND BUR OAK 9 N58E 255. 3201.66

TO CORNER TO SECTIONS 21 & 28 ON RIGHT BANK OF ROCK RIVER.
1869 LEE VOL 1 PG 337 FOUND STUMPS OF BEARING TREES. SHOWS 2665.08 TO NE CORNER OF SECTION 27.

1961 LEE SURVEY FOR WIS AERO COM. FOUND 1" PIPE.

1964 LEE FOUND 1" PIPE WHICH WAS PLACED IN WIS AERO COM. SURVEY DATED JAN 1961. SHOWS 2677.12 TO SE CORNER OF SECTION 22 AND AN ANGEL AT THE SE CORNER FROM THE W 1/4 COR SECTION 26 TO THE S 1/4 CORNER OF SECTION 22 AS 90-38-30.

1964 BATTERMAN JR. CALLS FOR AN ANGLE AT THE SE CORNER OF SECTION 22 TO FROM THE S 1/4 CORNER TO THE E 1/4 CORNERS OF SECTION 22 AS 88-58-50.

1977 COMBS CALLS FOR A PIPE IN MONUMENT BOX.

FOUND 1" PIPE IN MONUMENT BOX AND BENT PIN.

C) Was the corner restored through acceptance of (1) an obliterated evidence location, or, (2) a found perpetuated location?

ACCEPTED FOUND PIPE IN MONUMENT BOX.

D) Describe any material discrepancy between the location of the corner as restored or reestablished and the location of that corner as previously restored or reestablished by distance and direction. Show the discrepancy on the plan view drawing under (a), above. Show the distances between the corner as previously restored or reestablished and (1) the corner as restored or reestablished, and (2) to at least 4 of the witness monuments shown on the drawing in (a), above.

(E) Was the corner reestablished through lost corner proportionate methods? If so, show the method, including the directions and distances to other public land survey corners used as evidence or used for proportioning the corner location.

I, Donald Barnes, hereby certify that the corner points as identified by the corner code index were, in a field survey on, July 20, 1990, established, re-established, monumented, re-monumented, recovered or restored as expressed below and in conformance with the regulations and rules as required in the current manual of survey instructions of the United States Department of the Interior, Bureau of Land Management.



AFFIX YOUR LAND SURVEYOR SEAL

COUNTY SURVEYOR FILING DATA
Date of computer entry _____
Date microfilmed _____
Number of included sheets _____
CORNER CODE

R15